

# CITY OF SUNNYVALE: CITY HALL

Sustainable Public Art  
Bold and Innovative









# LEED Gold Art Installation

- Recycled
- Regional
- Innovation and design
- Local (less than 500 miles)

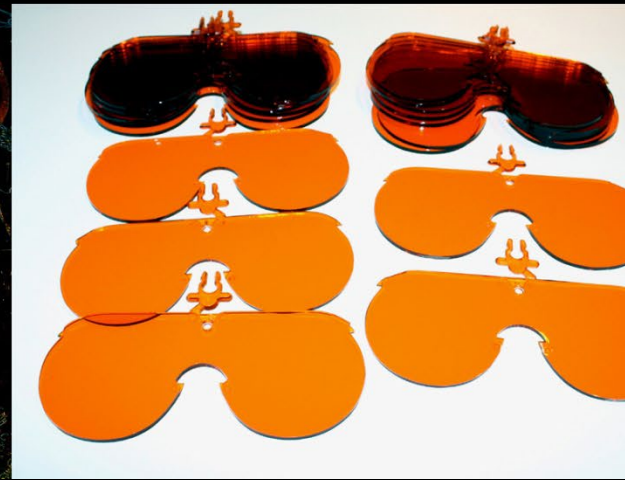
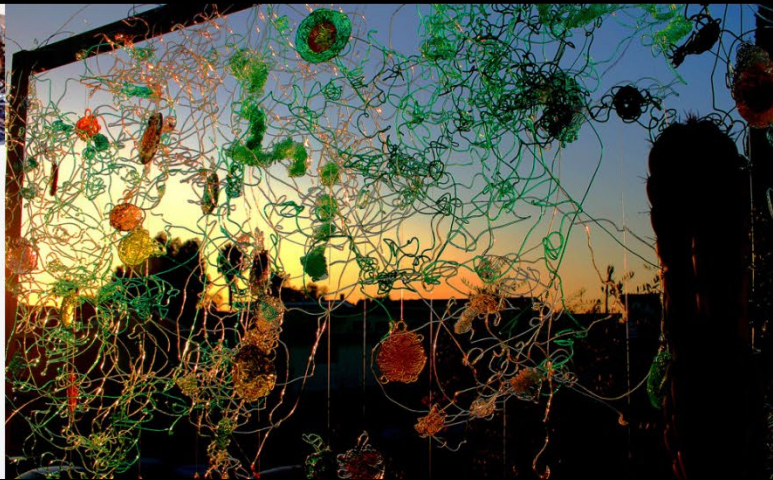
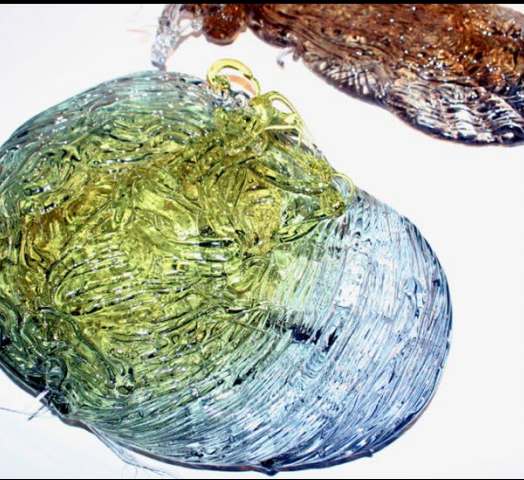

# PREVIOUS WORK: *U.N.I.T.Y*





## PREVIOUS WORK: *U.N.I.T.Y*



# PREVIOUS WORK: *TWIN LANTERNS*





# PREVIOUS WORK: *NURDLE NOOKS*



# PREVIOUS WORK: *NURDLE NOOKS*





# PROJECT SITE: SUNNYVALE CITY HALL



New 119,874 square-foot, four-story, Net Zero Energy and Certified LEED Platinum City Hall

# ARTWORK SITE: SUNNYVALE CITY HALL LOBBY NICHE

Recessed 8' tall x 11' wide x 14" deep wall niche





## RFQ: PROPOSAL TEXT

The Sunnyvale City Hall building presents a fantastic opportunity to explore the natural conditions of light and color highlighted in my work. I would propose to create a backlit optical sculpture placed into the lobby niche designed on the themes of modernization, sustainability, and Sunnyvale's native landscape. I propose two preliminary concepts, one literal and one abstract. The literal project would be a hanging optical sculpture of sign language hands spelling out "SUNNYVALE" repeating 6-12 times vertically within the niche. The sculpture would hang on fine steel cables and attached to two tracks mounted into the ceiling, manufactured by the same company as referenced in the solicitation (Systematic art - sky picture rail). 20-50 Members of the community would be used to create the hand molds. The second proposed concept would be to create a mold of local redwood tree trunks, and ideally trees that were removed to clear the "redwood trail" located directly outside of the new City Hall. The tree trunks would be filled with recycled glass and optical polymer.

# PROPOSAL RENDERING: SUNNYVALE CITY HALL LOBBY NICHE

TITLE: *Branches of Illumination*

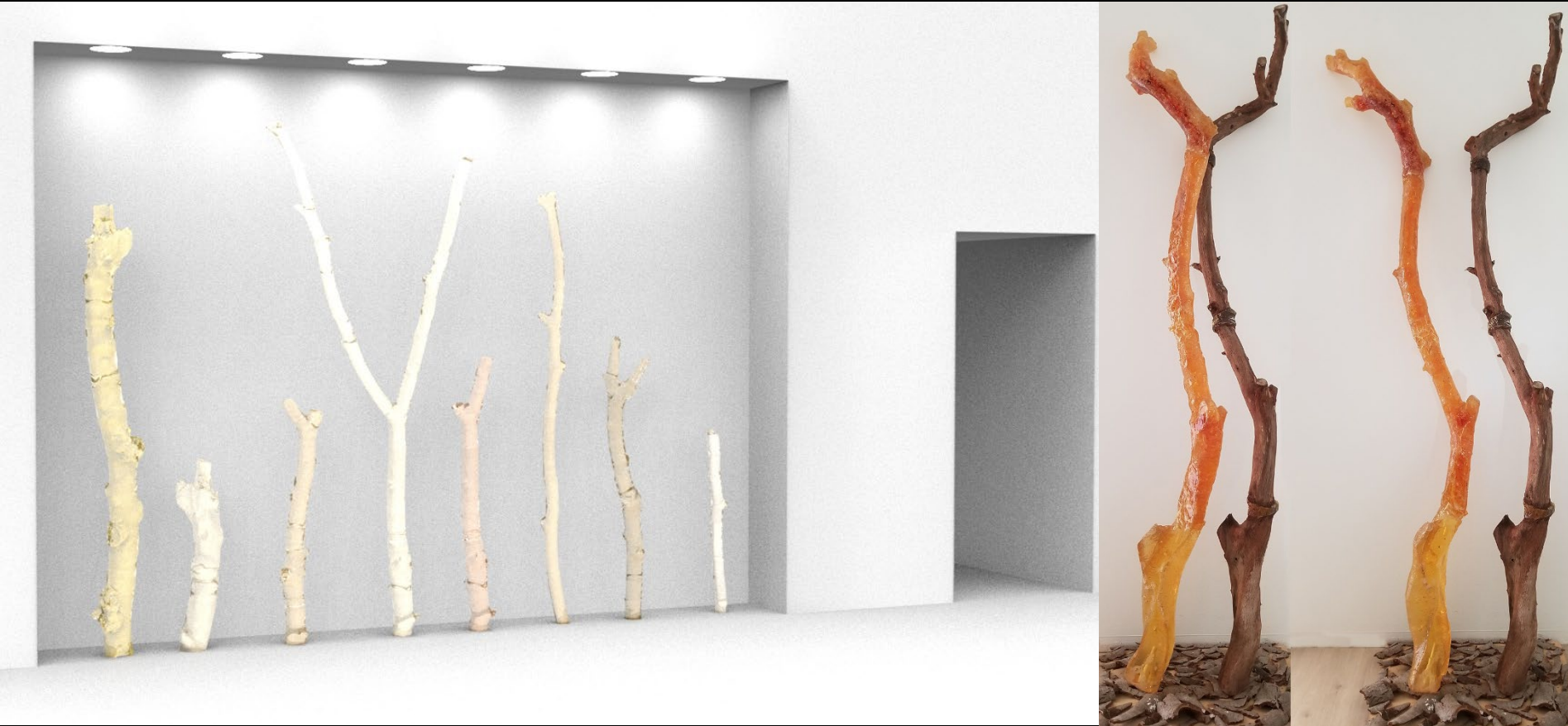



# SUNNYVALE: *BRANCHES OF ILLUMINATION*



# COMMUNITY EVENT

- Gather and select 2-4 branches (OAK OR REDWOOD) from the project site to be molded and filled with recycled plastic (Redwood Trail, North Meadow, or other)
- Branches to be 6" to 10" in diameter and 6 to 7 foot tall. 2-4 branches will be used for the final art installation and replicated for the Sculpture
- Requesting to remove the branches the day of the event and bring back to BenPhippsStudio for molding
- Same community process that was successfully completed with hand molding
- A tree molding demonstration will also be conducted on site using environmentally safe alginate molding compound.





## PREVIOUS COMMUNITY EVENT (hand molding)





# PREVIOUS COMMUNITY EVENT (hand molding)





## DESIGN: *Branches of Illumination*

- Sculpture containing transparent art and light
- Reflect/Interact with the natural and artificial lighting
- Symbols of Innovation and Sustainability
- Recycled content

The recycled art - once waste material - suspended in optically clear resin reflects and refracts light that passes through it, creating a dynamic and interactive surface that 'moves' as viewers pass near the art. Natural light cast through these optical sculptures creates additional effects; colorful projections either within the art or onto the ground increase the interactive quality of the system.

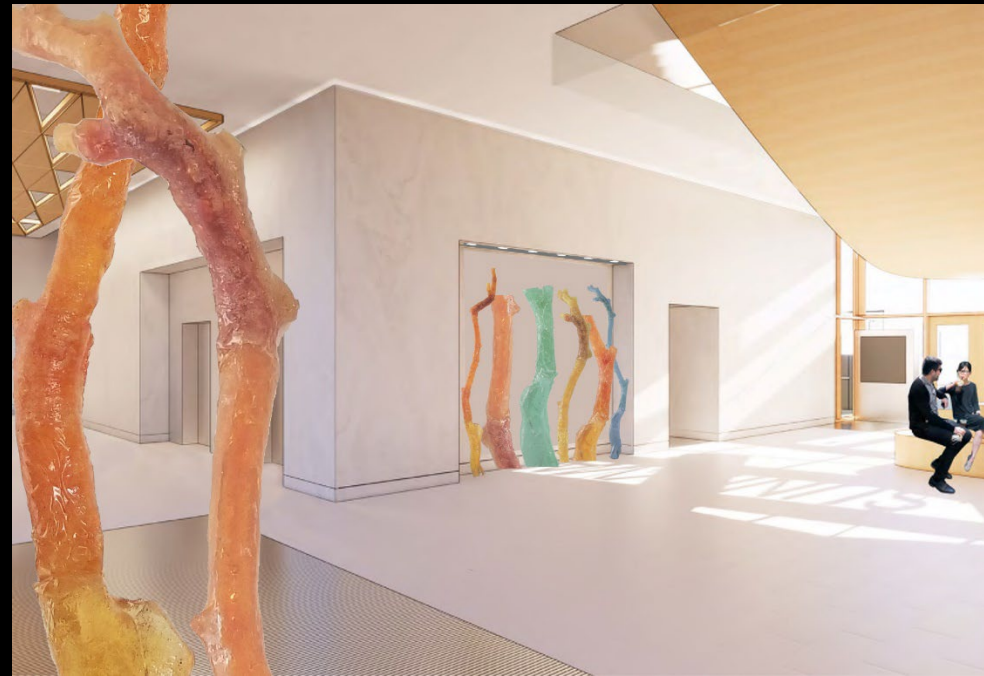

# ARTISTIC PROCESS: *Branches of Illumination*

## Artistic Process:

- Select and identify tree branches with community (2-4 branches). 6" to 10" in diameter and 6 to 7 foot tall
- Mold branches in environmentally safe seaweed (alginate)
- Fill the alginate mold with transparent resin
- Create a Silicone mold of the resin tree branch
- Fill the mold with recycled plastic for 4-6 artistic replicas





## MOUNTING STRUCTURE: *Branches of Illumination*

- The optical branches will stand vertically within the wall niche
- Each branch will be supported by a custom 12"x12" metal base plate with steel rod at the center. (making each piece easy to move every 2-3 years)
- Base plate painted to match the floor tile
- Branches placed within the 14" niche
- Additional stainless-steel safety cable can be attached to the Systematic rail. (only if required by the city for additional earthquake protection)
- If required base plate can be approved by a licensed engineer

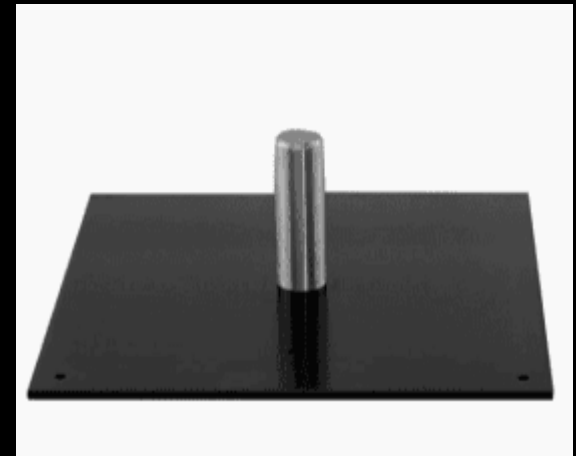

## **LIGHTING:** *Branches of Illumination*

- No requested changes to the lighting layout
- Overhead LED track lighting is acceptable or direct spot lighting
- City supplied LED lighting and electrical

The art would stand in daylight like prisms, projecting subtle colored shadows across the ground or walls. By night, the LED illuminated sculpture would create a centerpiece as a brilliant sustainable and modern sculpture inspired by science and technology.





## **MAINTENANCE:** *Branches of Illumination*

- Low maintenance and highly solar and impact resistant
- The material is similar to what is used in impact resistant windows and is UV stabilized recycled polycarbonate
- Artwork could be hand cleaned with windex when required

### Technical Feasibility:

This project will use the same molding/casting techniques as a 2020 completed project UNITY a 1% public art project in Elk Grove CA where 1,000 hands we molded and filled with recycled plastic. The sculptures will be molded at Ben Phipps Studio in Long Beach using our recycled optical glass and polymer

## **BUDGET:** *Branches of Illumination*

Budget: \$20,000 all inclusive

Art Fabrication – conducted at BenPhippsStudio

Art Materials – \$4,500

Labor – \$6,500

Installation – \$2,000

Metal standing structure – \$1,600

Design Fee - \$2,000

Contingency – \$2,000

Insurance – \$1,400

Project management – covered by Studio

Fees for Permits – not required

Structural/Mechanical Engineering consultation – if required



# SUNNYVALE: *BRANCHES OF ILLUMINATION*

