

## Community Input Recap

# Community Meeting #2

Held via Zoom on May 12, 2022  
with **20 participants**

## Meeting Agenda

### Community Meeting #2

- Agenda/Introduction (2 minutes)
- Site Overview & Project Goals (3 minutes)
- Community Input Recap (5 minutes)
- Design Concepts (20 minutes)
- Breakout Session (45 minutes)
- Conclusion and Q&A (10 minutes)

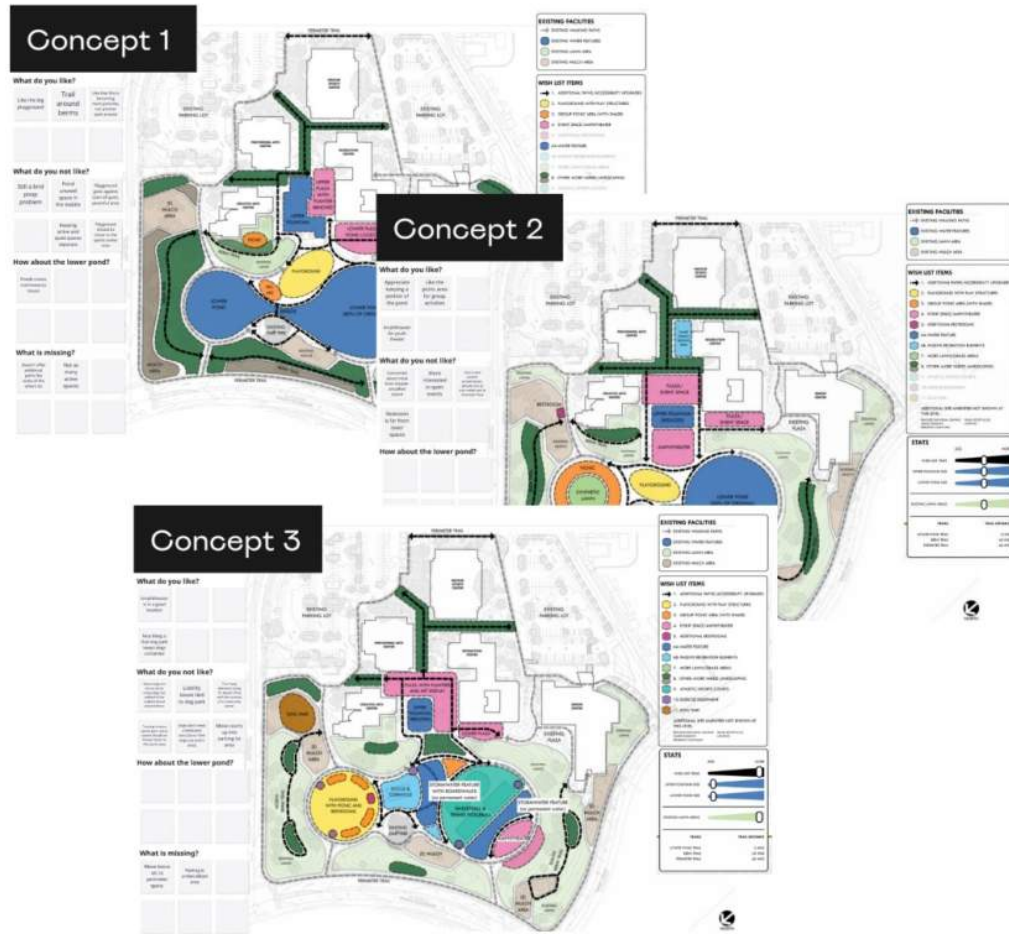

Community Meeting #2

# Breakout Room Response

COMBINED DATA

## Concept 1: Most Pond, Least Program



### What people liked:

- Additional trails on the berm
- Additional picnic areas
- Less program/ closer to the existing program
- Keeping the upper fountain and the sound of water falling to the lower pond



### What people disliked...

- The addition of too much programming
- The large pond still takes up a large amount of space, doesn't help the bird situation, and requires a lot of maintenance
- The dog park is not needed



### What people thought was missing...

- More walking paths in the central area
- Active recreation for adults
- Restrooms
- Picnic areas under trees

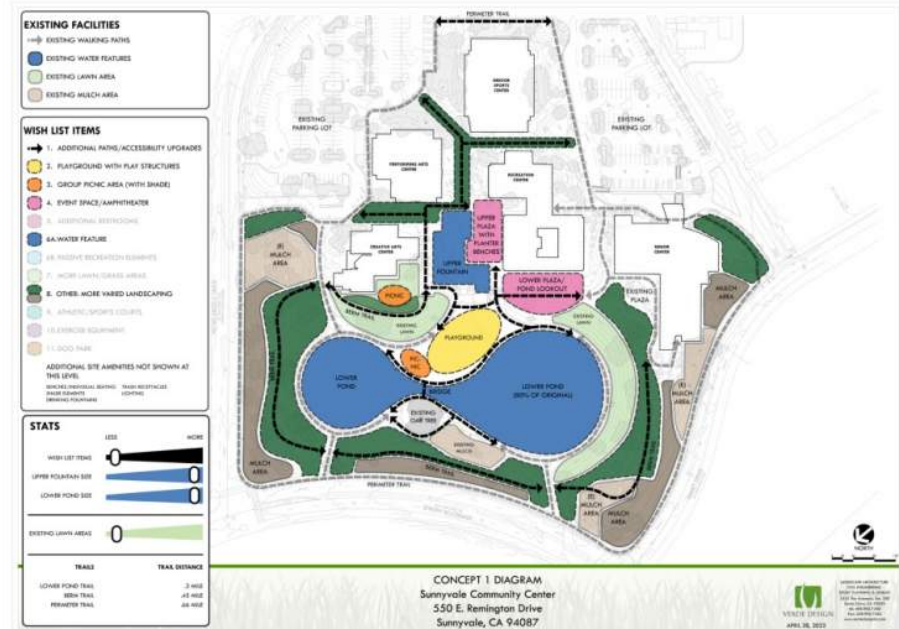

Community Meeting #2

# Breakout Room Response

COMBINED DATA

## Concept 2: Balance of Pond and Program



### What people liked:

- The location of the amphitheater below the upper fountain and built into the slope
- Restroom location away from central area
- Trails on the berms
- Large picnic area



### What people disliked...

- Concerns about amphitheater noise
- Still too much lawn
- Still too much water
- Restroom is too far from the central area
- Concerns about synthetic turf



### What people thought was missing...

- Basketball court
- Exercise stations
- Cascading water
- More shade

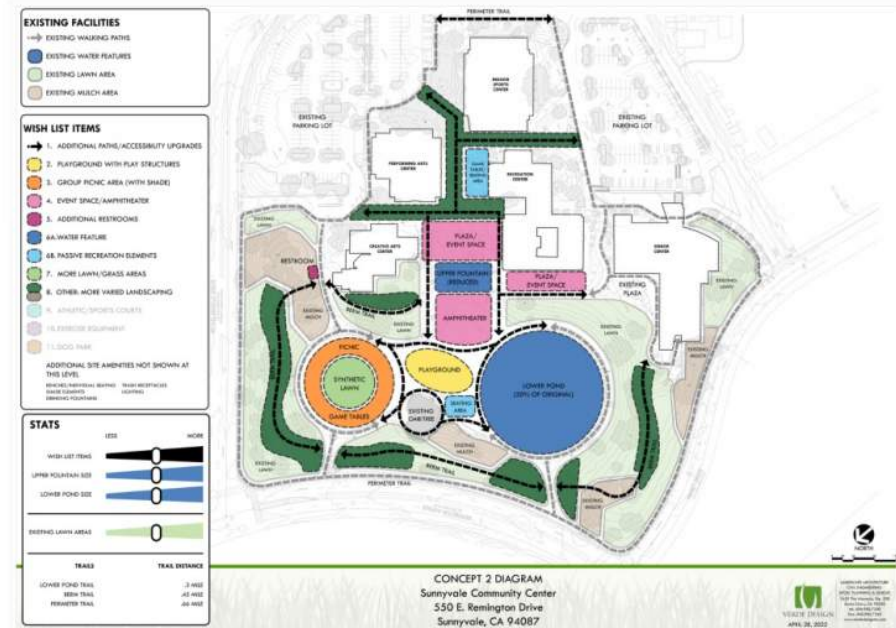



Community Meeting #2

# Breakout Room Response

COMBINED DATA

## Concept 3: No Pond, Most Program



### What people liked:

- The location of the amphitheater off Remington Dr and built into the hillside
- The reduction of the water features and inclusion of a seasonal stormwater feature
- Berm trail
- Multiple picnic areas



### What people disliked...

- The concept feels too busy/ too much program
- The dog park is not needed
- Too much lawn
- Not the right location for athletics
- Completely removing the lower pond



### What people thought was missing...

- More native landscaping in lawn areas
- Shade and seating in the plaza

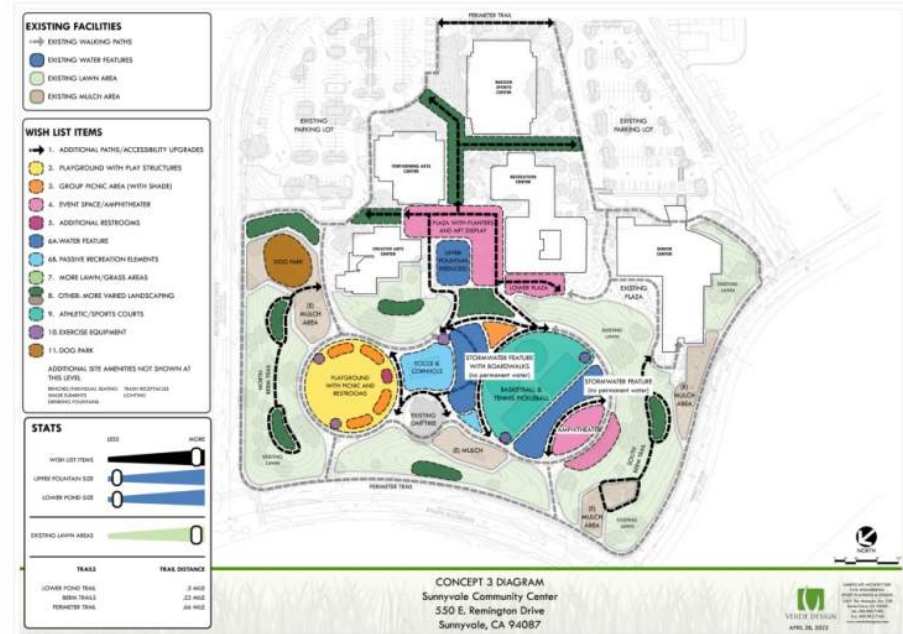

Community Meeting #2

## Breakout Room Response

COMBINED DATA

### Site Paving Materials Discussion

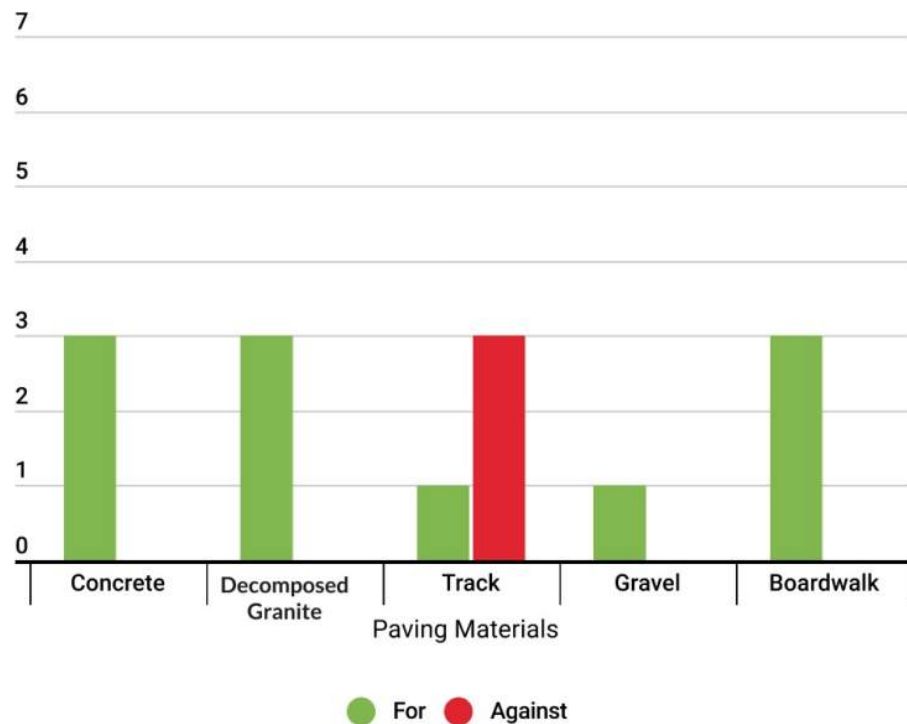

#### Additional responses:

- There are tripping hazards around the pond path
- Use paving that is easy-to-clean and suitable for all ages
- There was interest in natural materials and permeable paving

Community Meeting #2

## Breakout Room Response

COMBINED DATA

### Playground Discussion

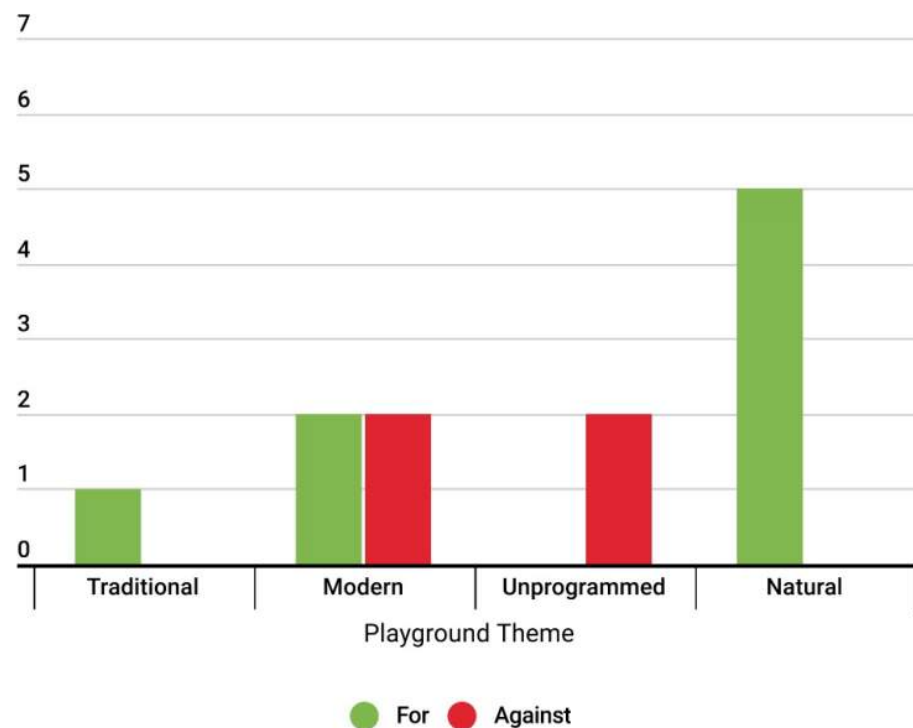

#### Additional responses:

- Include elements for adults and children of all ages
- Prefer a big playground
- Concerns over playground noise

Community Meeting #2

## Breakout Room Response

COMBINED DATA

### Picnic Discussion

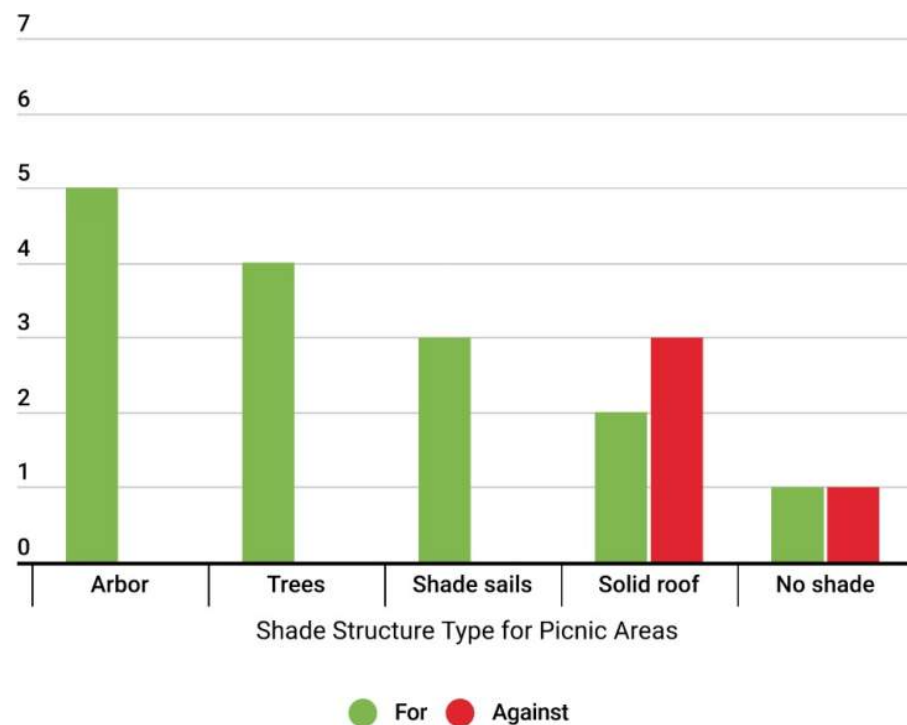

#### Additional responses:

- There should be picnic areas near and away from playgrounds
- Consider individuals and small groups

Community Meeting #2

## Breakout Room Response

COMBINED DATA

### Amphitheater Discussion

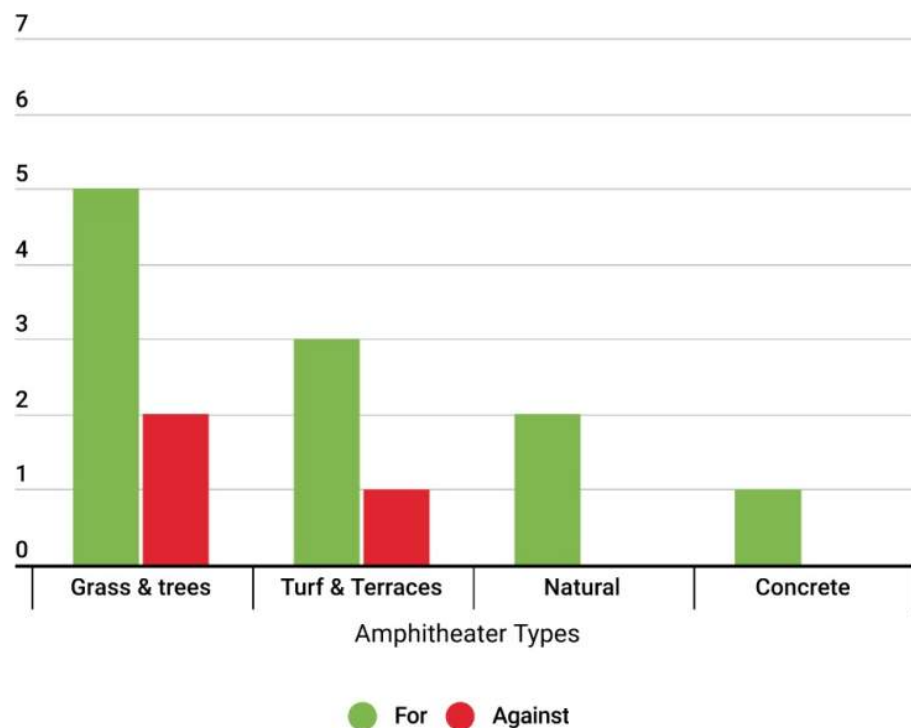

#### Additional responses:

- People liked the location of the amphitheater in both concept 1 and concept 2
- A mix of people said an amphitheater was needed and not needed



Community Meeting #2

## Breakout Room Response

COMBINED DATA

### Water Features Discussion

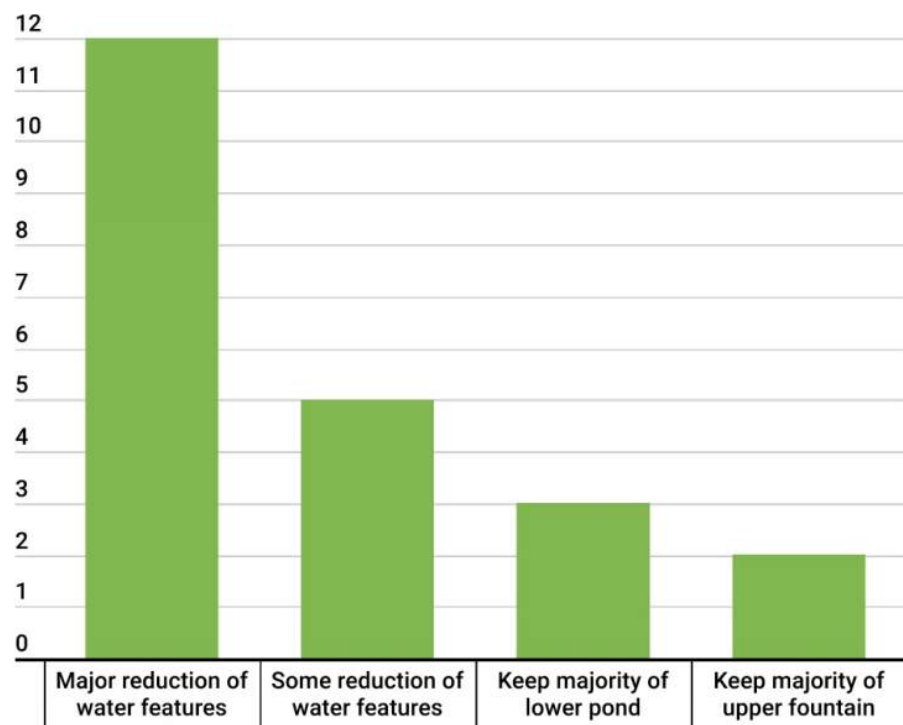

#### Additional responses:

- People enjoy the sound of water cascading from the upper fountain to the lower pond

Community Meeting #2

## Breakout Room Response

COMBINED DATA

### Dog Park Discussion

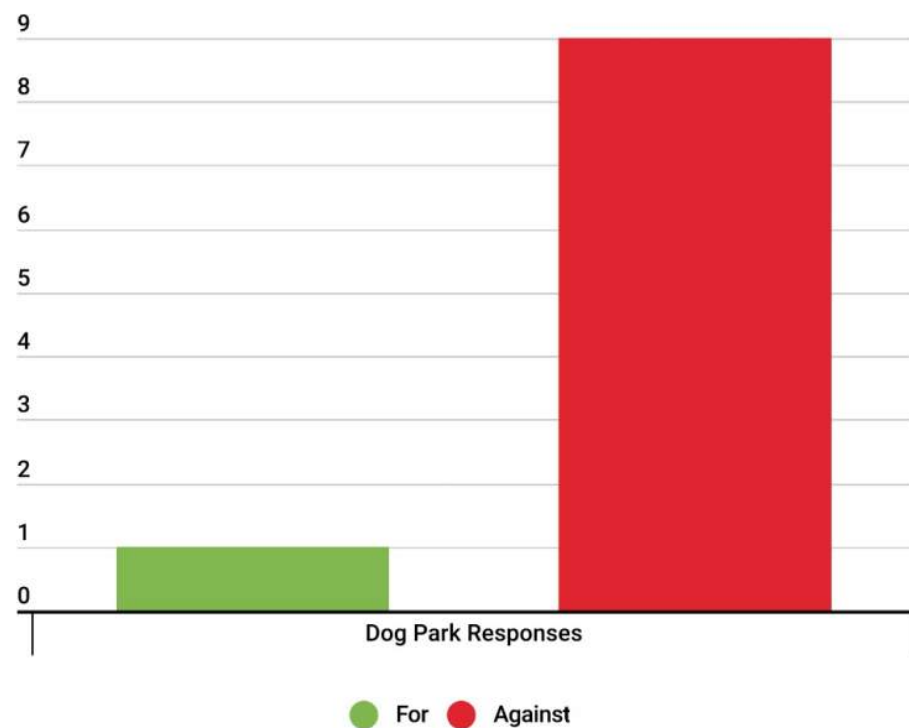

#### Additional responses:

- Many people thought that a dog park was not needed citing nearby facilities

Community Meeting #2

## Breakout Room Response

COMBINED DATA

### Additional Comments



- Removing the pond doesn't necessarily mean adding more programming. Many people want to keep the natural, serene feeling even if there is more available space without the pond.
- A variety of pathway types are welcome (trail, boardwalk, natural materials)
- There were mixed responses for athletics, exercise equipment, leisure activities, and synthetic turf
- Incorporate more shade in plaza and event spaces
- Traffic calming is needed on Remington Dr. although this is outside of the project scope



# Preferred Concept

Which concept do you prefer?

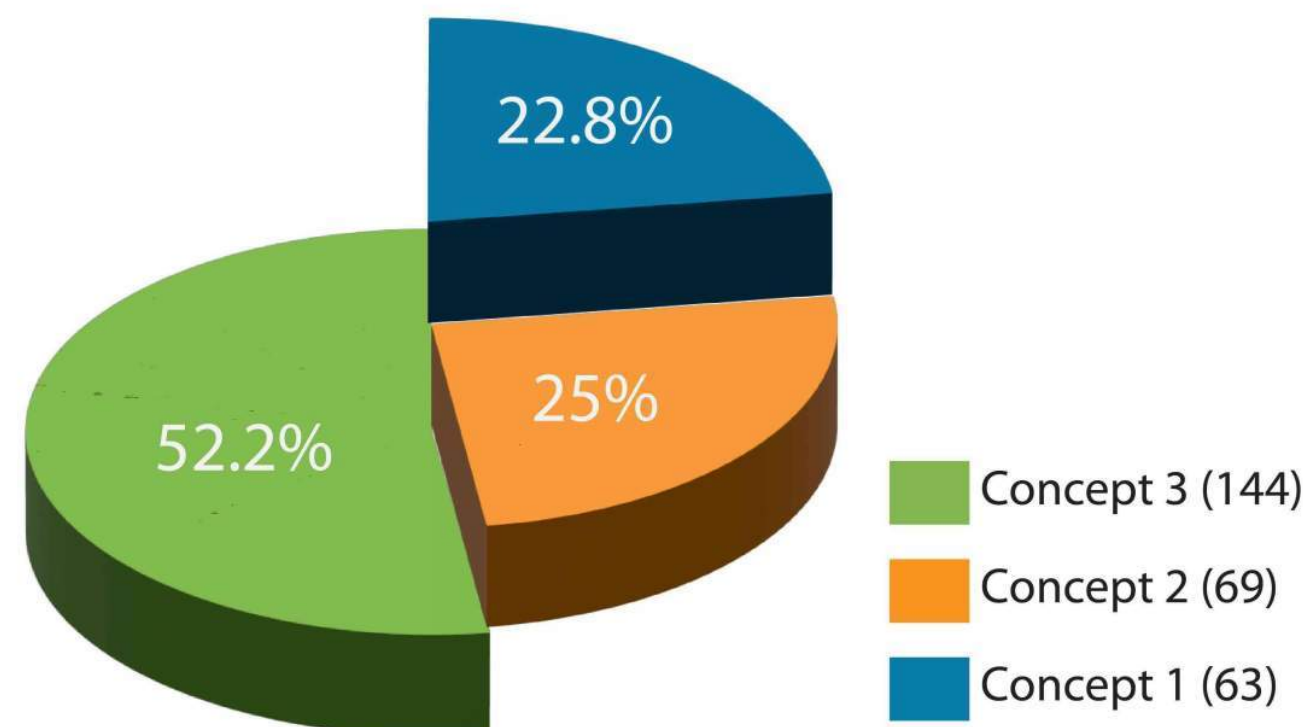

The majority of the community prefers concept 3, as it provides more activities and more usable space. However, many people are interested in keeping some of the lower pond, so perhaps a compromise could be reached.

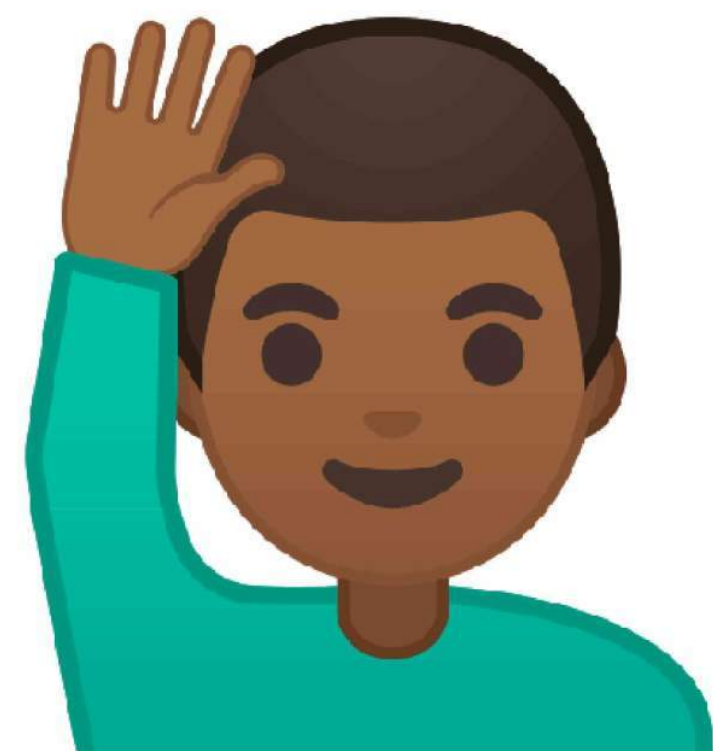

Why do you prefer Concept 1?

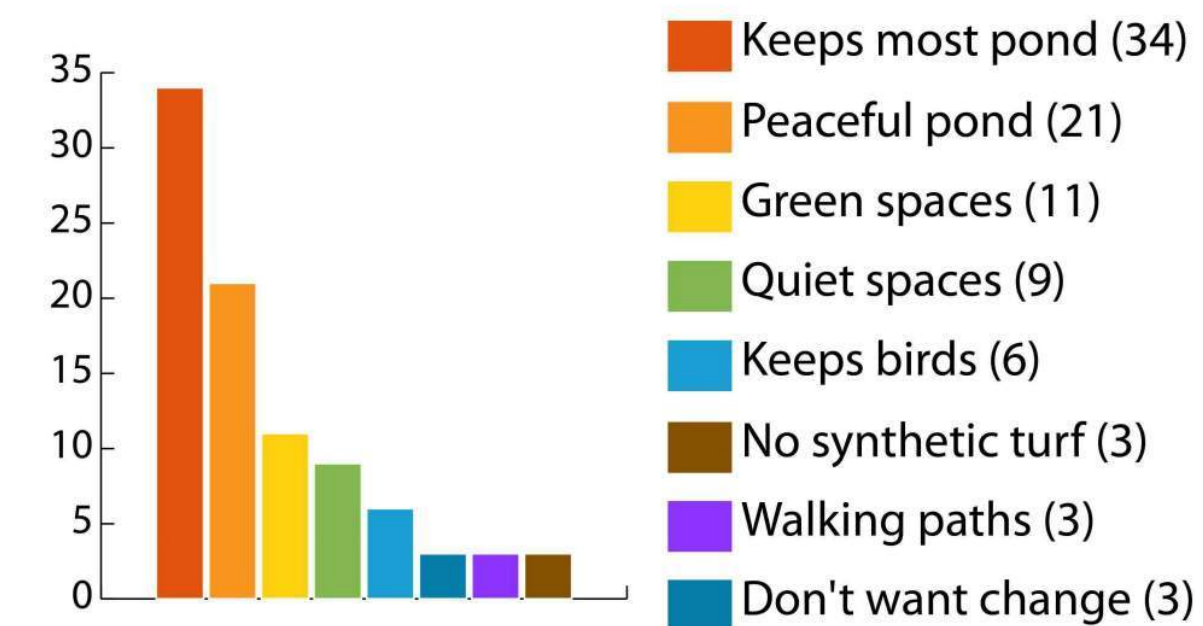

What's missing from Concept 1?

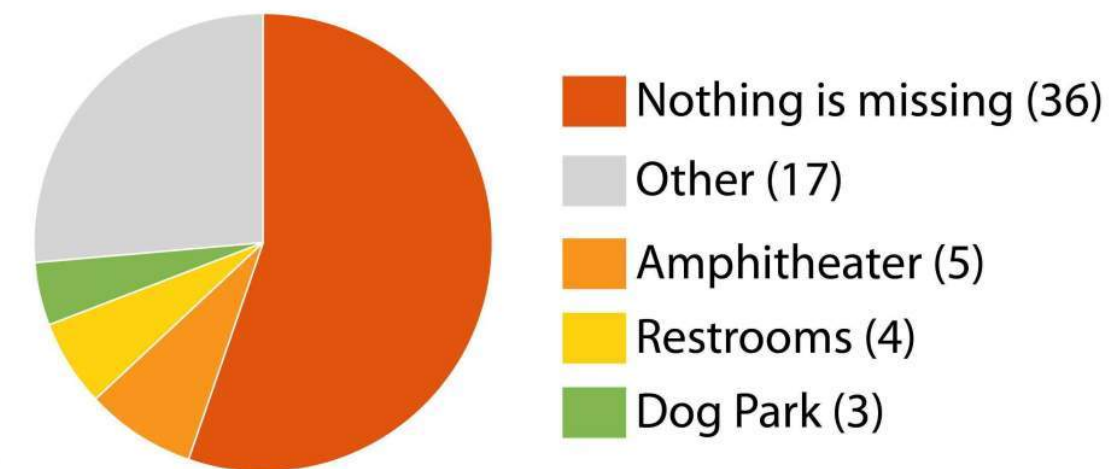

Why do you prefer Concept 2?

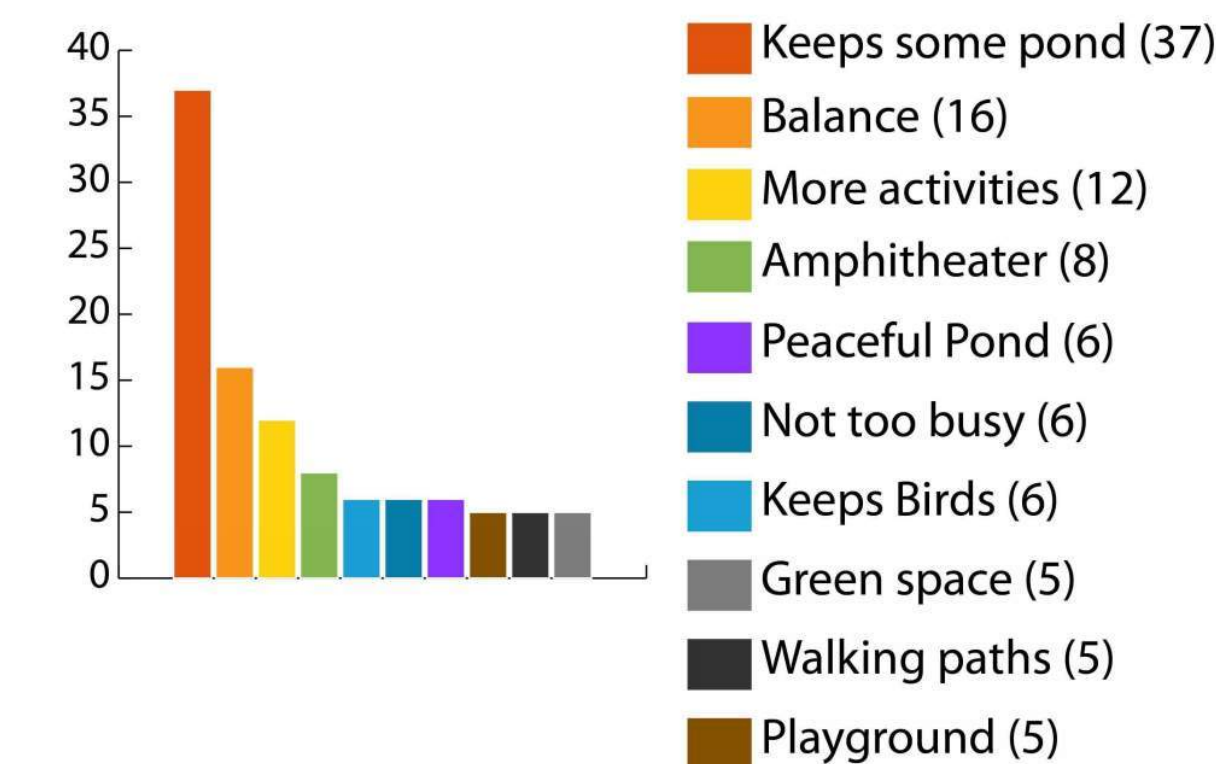

What's missing from Concept 2?

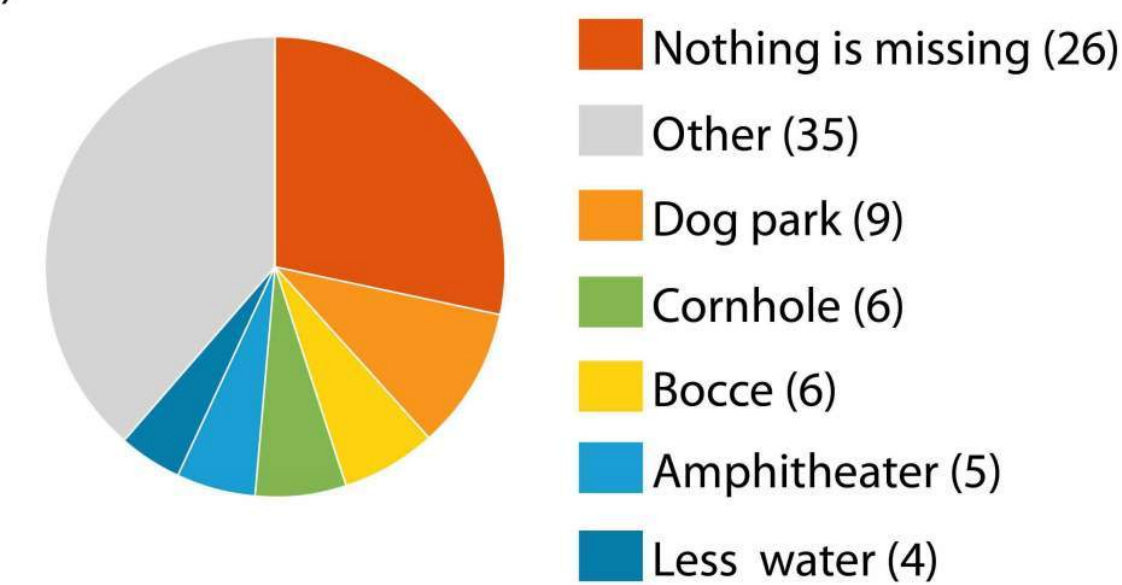

Why do you prefer Concept 3?

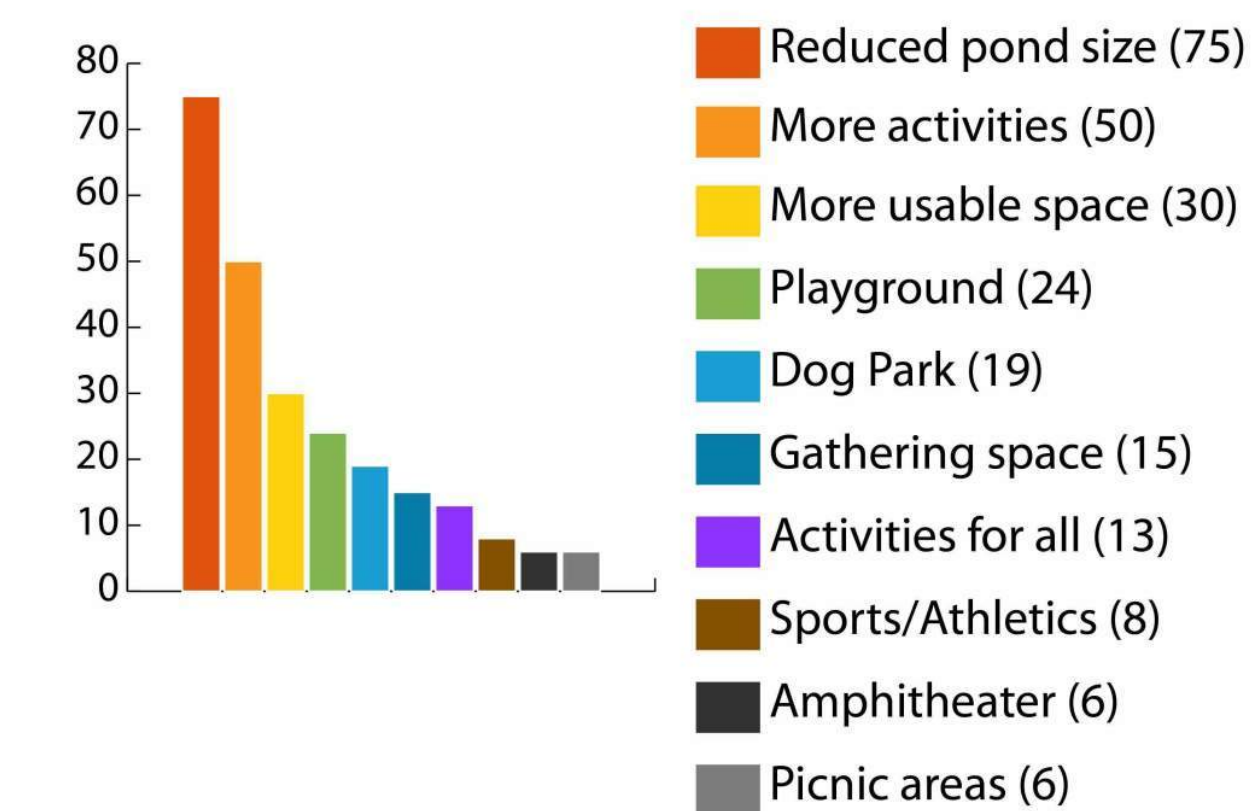

What's missing from Concept 3?

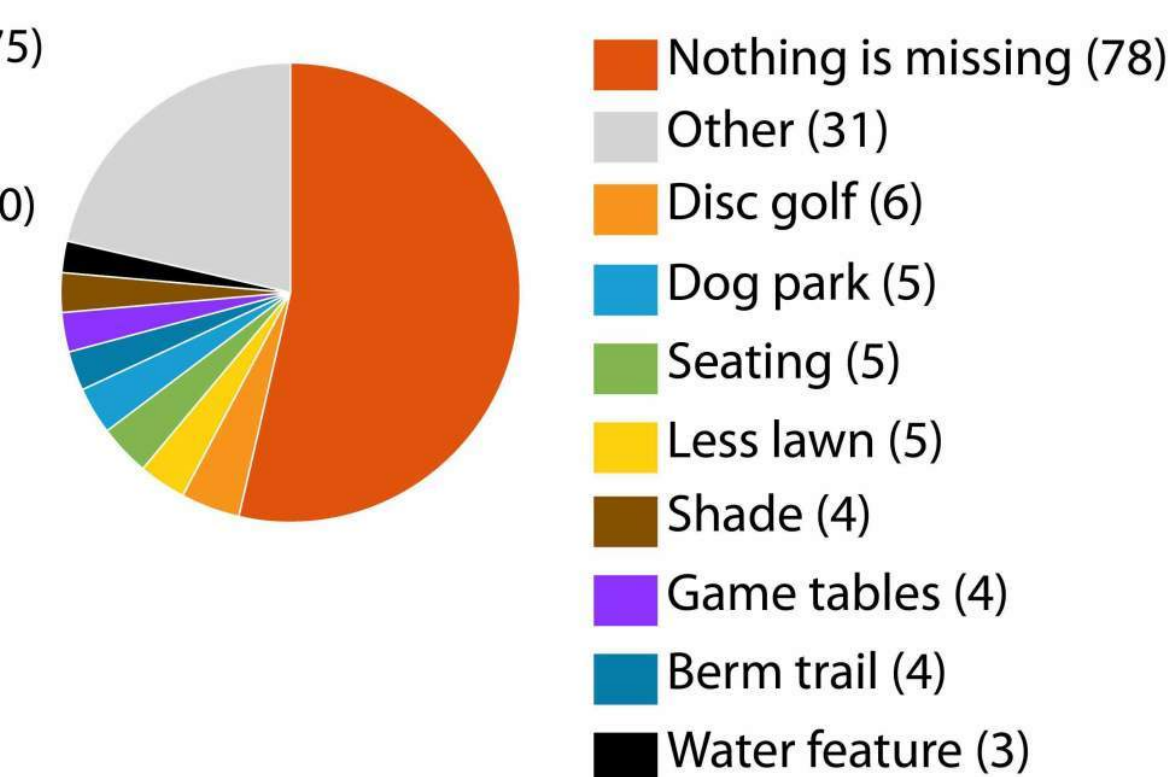

# Lower Pond Input

How important is keeping the lower pond in relation to adding new program elements?

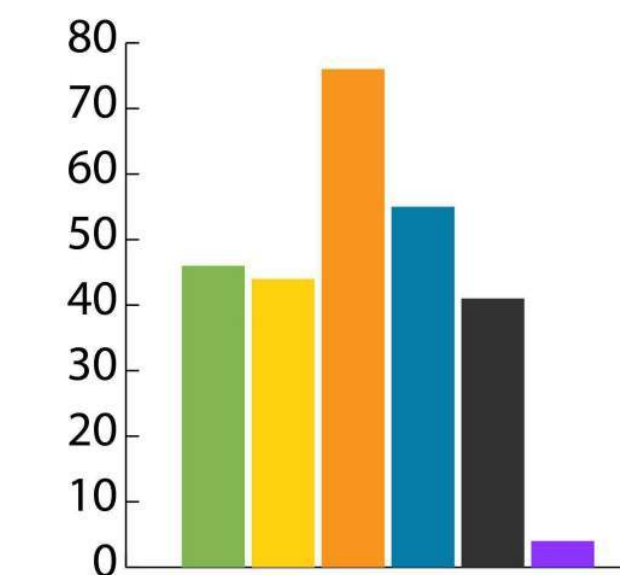

While some people (90) commented that the program is more important than keeping the lower pond or that the pond should be removed altogether, a larger group of people (131) noted that the pond is equally or more important than adding new elements.

- Remove pond (46)
- Program is more important (44)
- Equally important (76)
- Pond is more important (55)
- Both are not important (41)
- Convert pond to creek or natural feature (4)

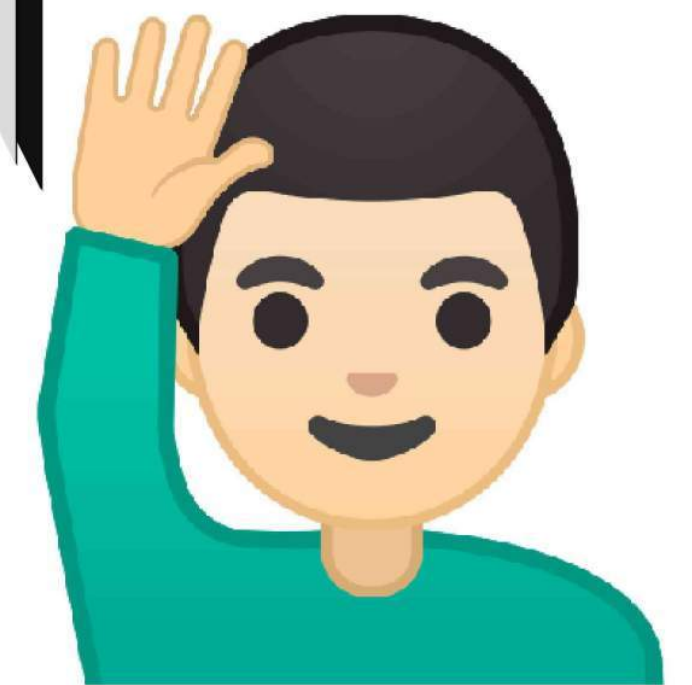

# Upper Fountain Input

Which configuration of the upper fountain do you prefer?

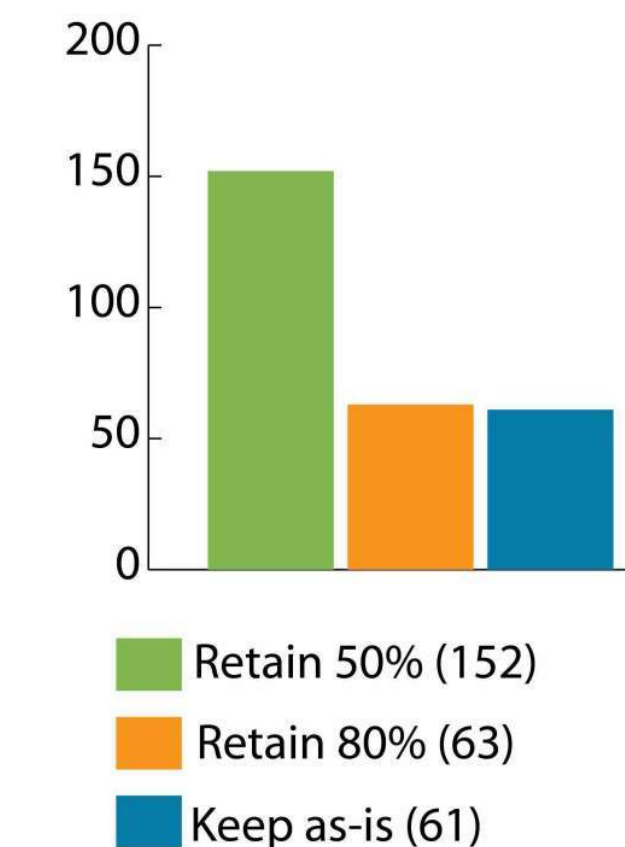

Most people are in favor of reducing the upper fountain by at least 20%





# Preferred Park Activities

For exercise equipment, which would you prefer?

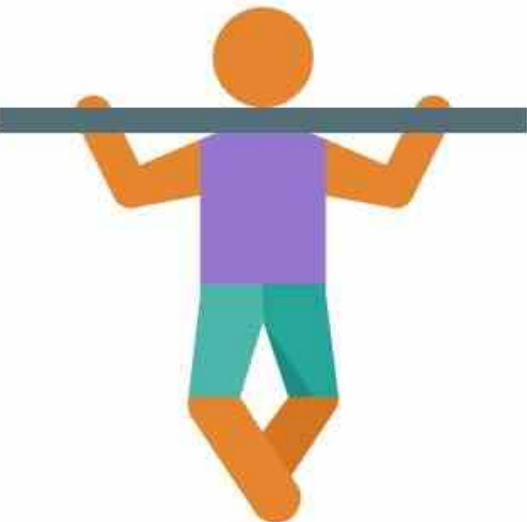
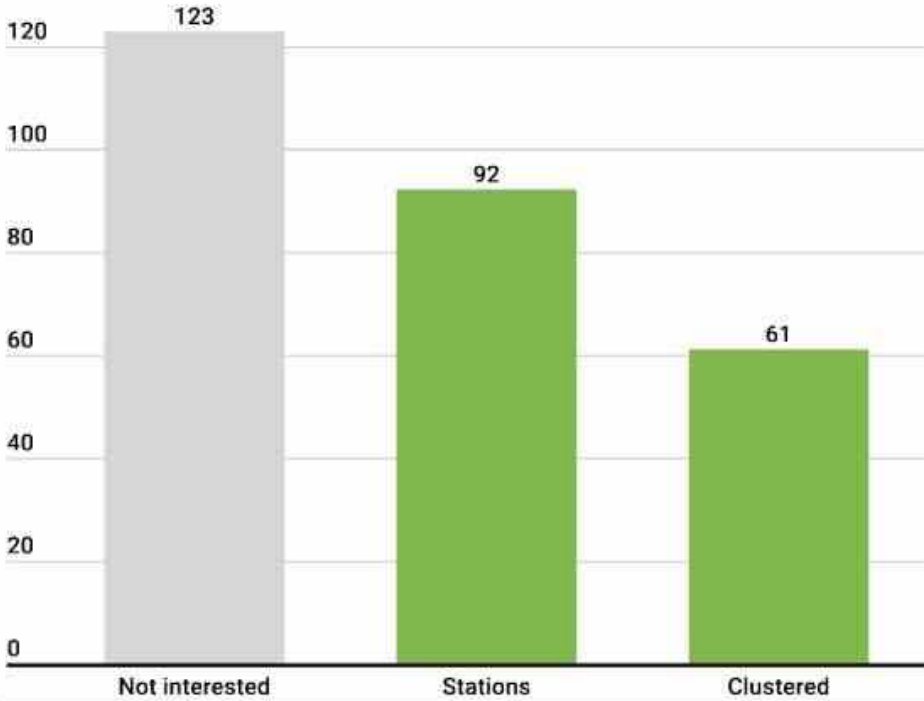

For Athletic/Sports Courts, what type are you interested in?

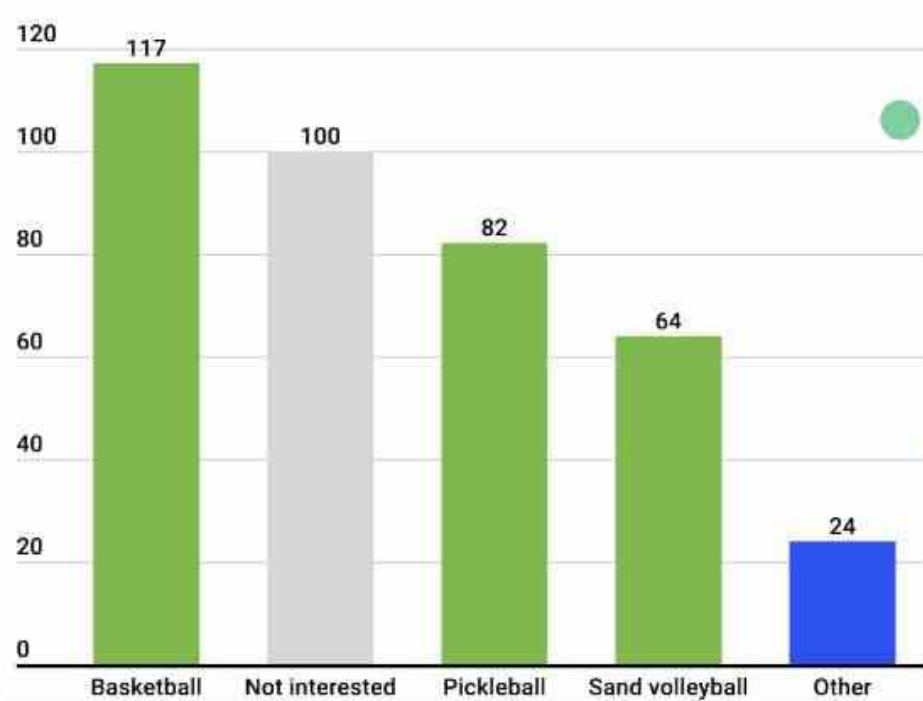

Which amenities would you prefer in a dog park?

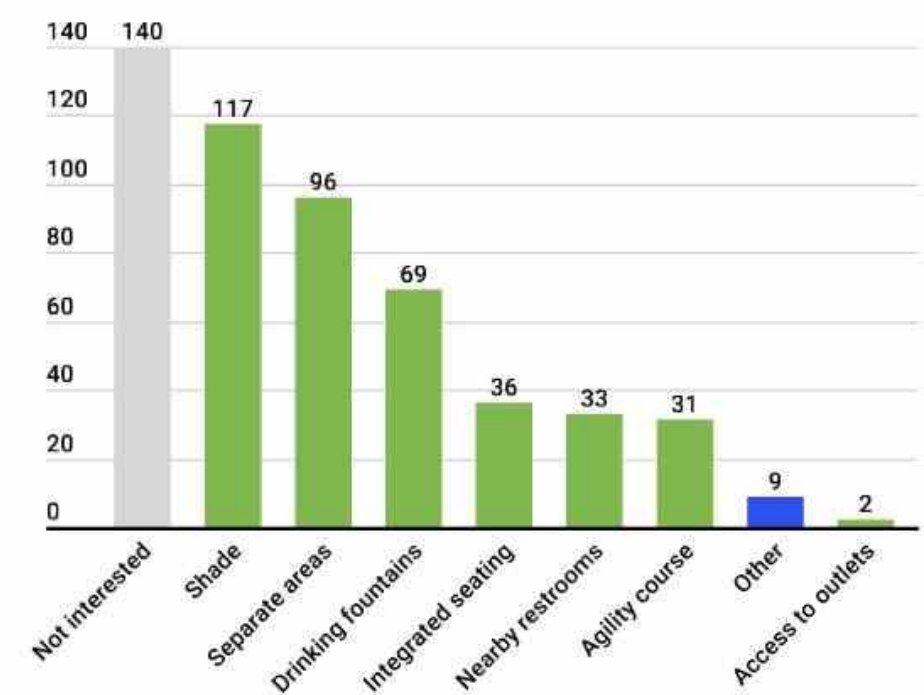

What type of leisure activities/games would you like to see?

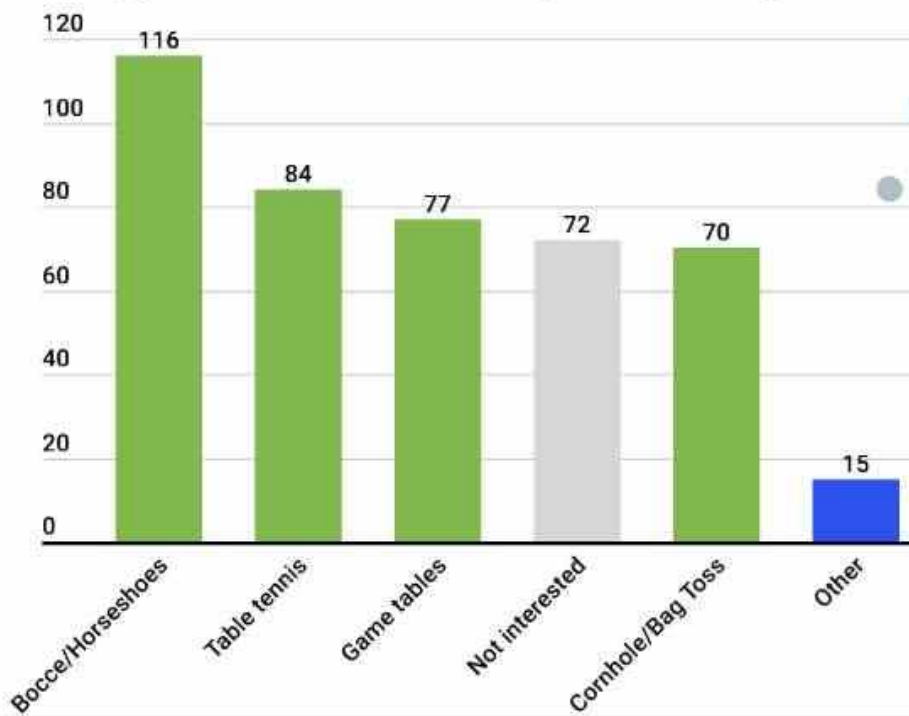



# Preferred Park Elements

How would you use additional pathways?

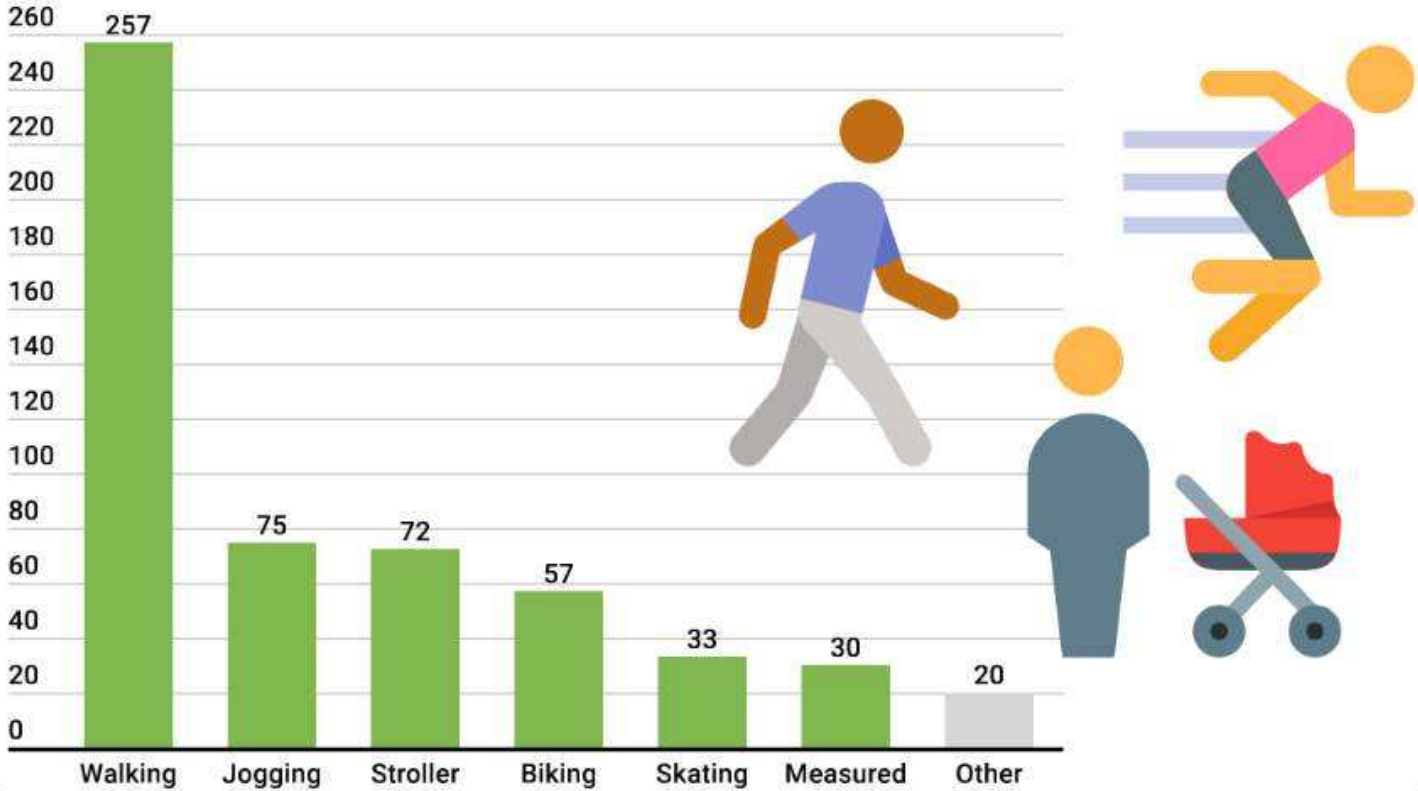

For group picnic areas, what type of overhead shade structure would you prefer?

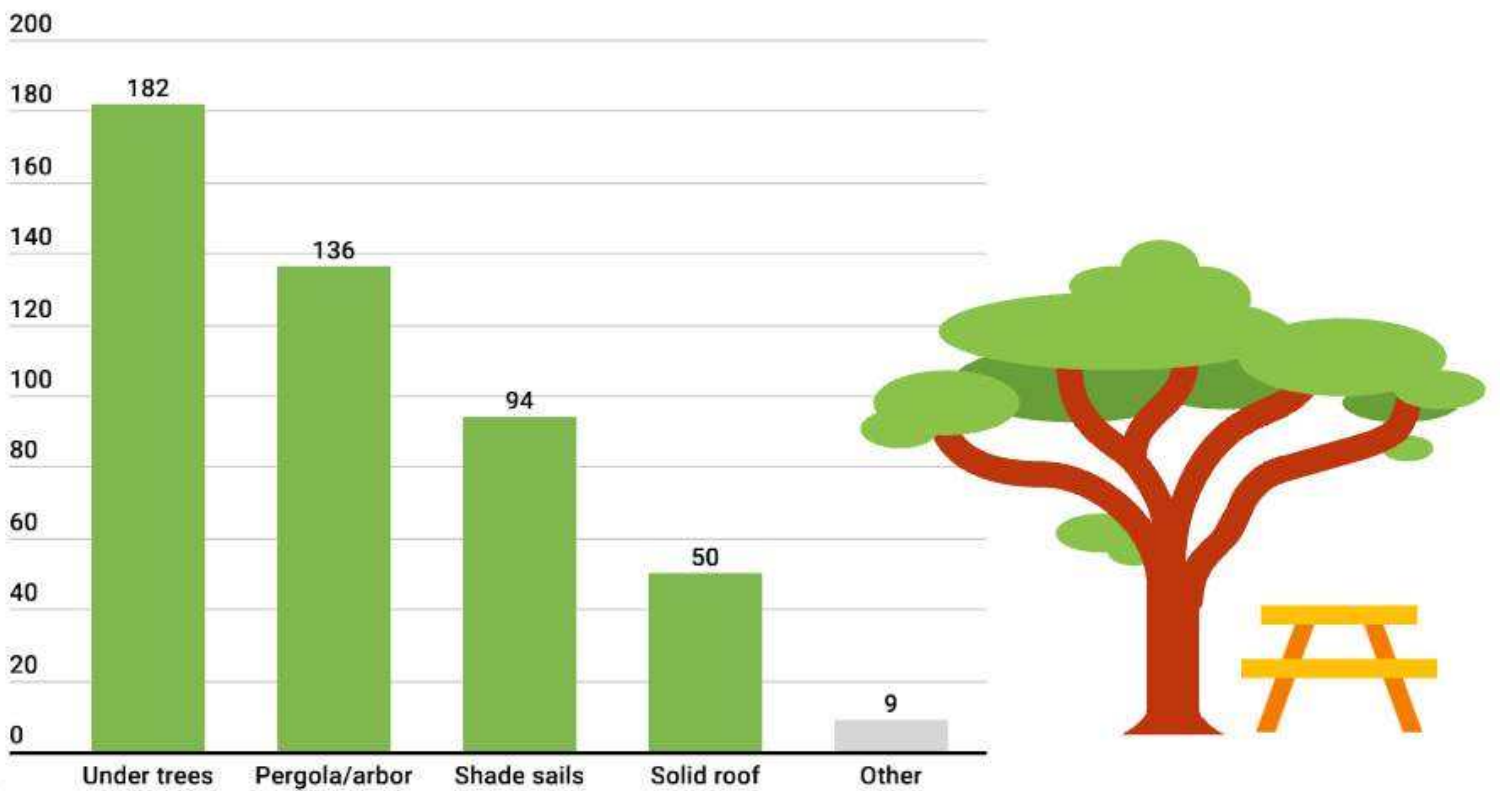

What type of events would you like to attend at an amphitheater?

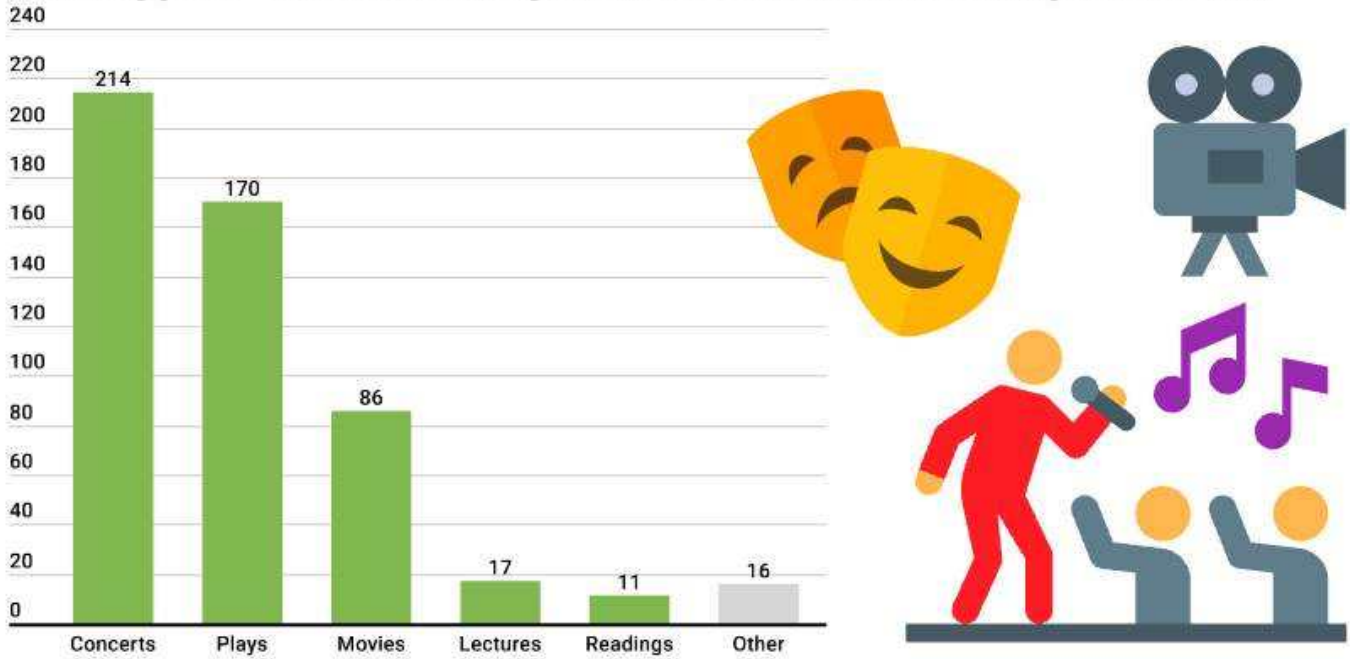

What elements do you prefer to be near a playground?\*

\*weighted average

1. Restrooms
2. Benches
3. Picnic Areas
4. Lawn
5. Parking Lot
6. Exercise Equipment
7. Existing Buildings

What style of play structure do you prefer?\*

1. Playground with natural materials
2. Modern Post & Platform Structure
3. Unprogrammed Structure
4. Traditional Post & Platform Structure

