



Sunnyvale

Caltrain Grade Separation Feasibility Study

Study Session
April 5, 2022





Project Background

Project Area



Project Purpose

- Safety
- Gate down times
- Caltrain Electrification
- Caltrain Business Plan
- Future California High Speed Rail
- Supports City Policies
 - ◆ Vision Zero
 - ◆ Active Transportation Plan
 - ◆ Climate Action Plan



Project History

- Feasibility study began in 2017
- Public outreach
- Interest in full rail tunnel option
- City Council and BPAC joint meeting in October 2017
- City Council in January 2018
 - ◆ Full rail option discussion
 - ◆ Direction to study four options (two at each location)



Initial Screening Alternatives

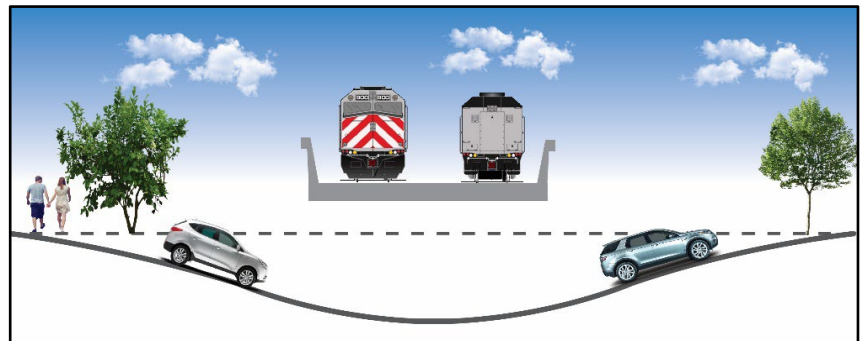
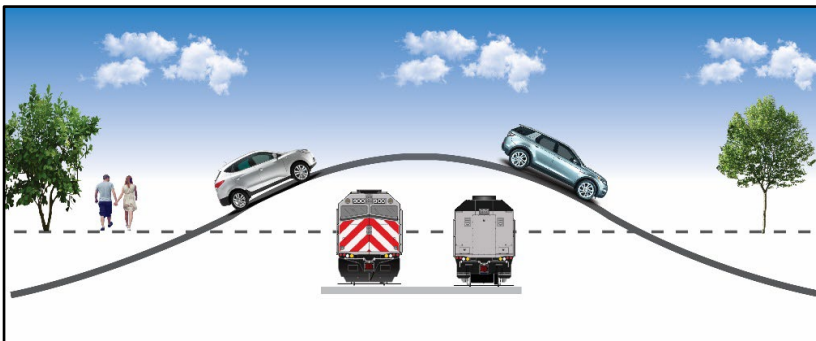
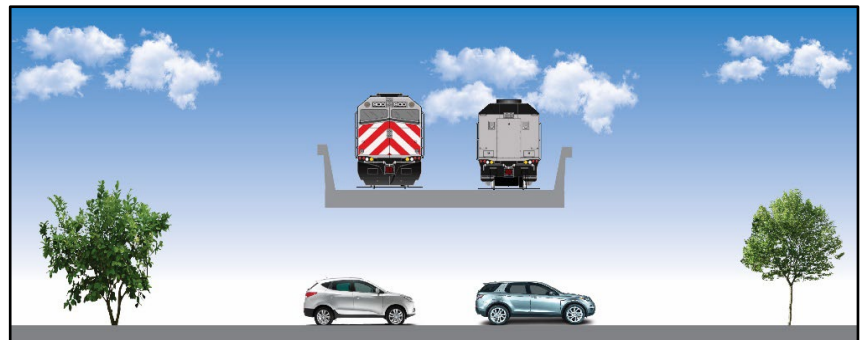
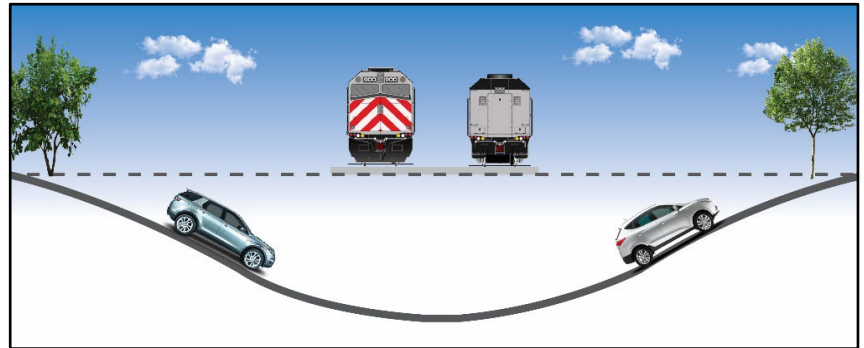
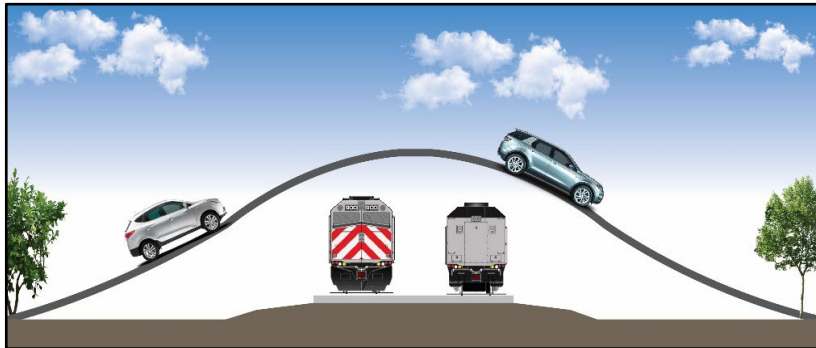

Project Options Studied

Mary Avenue

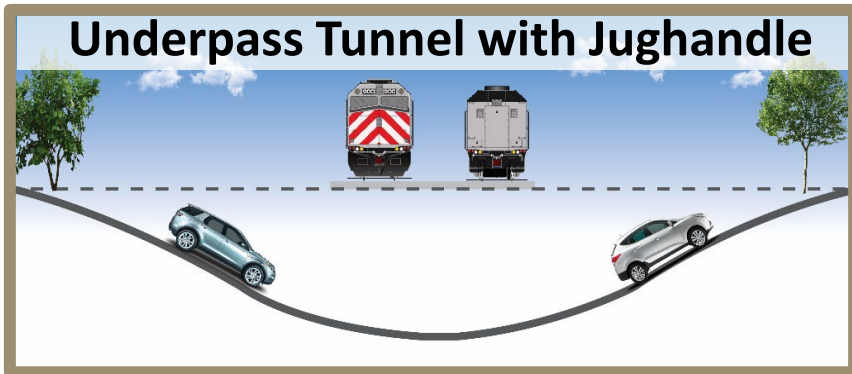
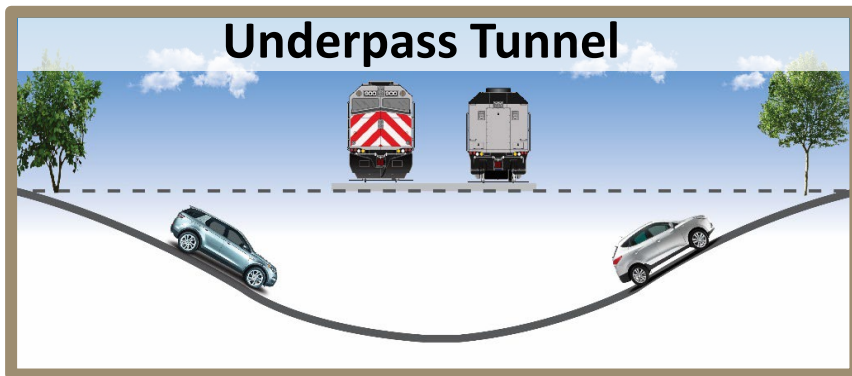

Sunnyvale Avenue

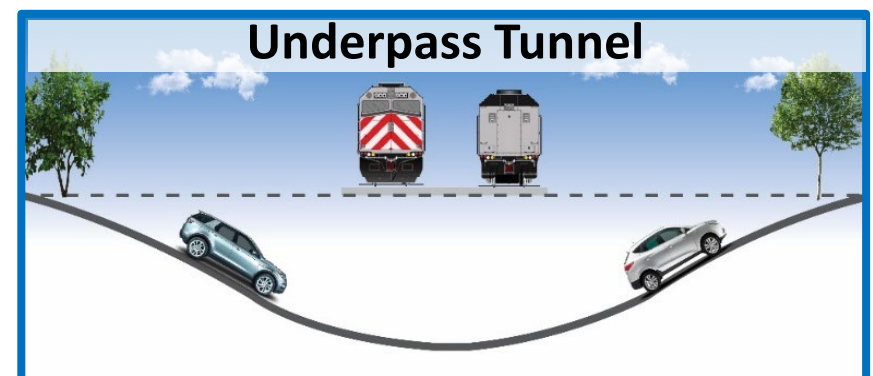

Mary Avenue Underpass Tunnel with Jughandle



Project Today

- Refinement of options and impacts
- Caltrain Modernization and Electrification Project
- Caltrain Business Plan
- California High Speed Rail
- Changing traffic conditions
- Other projects





Sunnyvale

Current Options

Current Project Options

- Mary Avenue
 - ◆ Underpass Tunnel
 - ◆ Underpass Tunnel with Jughandle
- Sunnyvale Avenue
 - ◆ Underpass Tunnel
 - ◆ Bicycle/Pedestrian Undercrossing (Sunnyvale Avenue Vehicular Road Closure)



Sunnyvale

Mary Avenue

Mary Avenue Underpass Tunnel

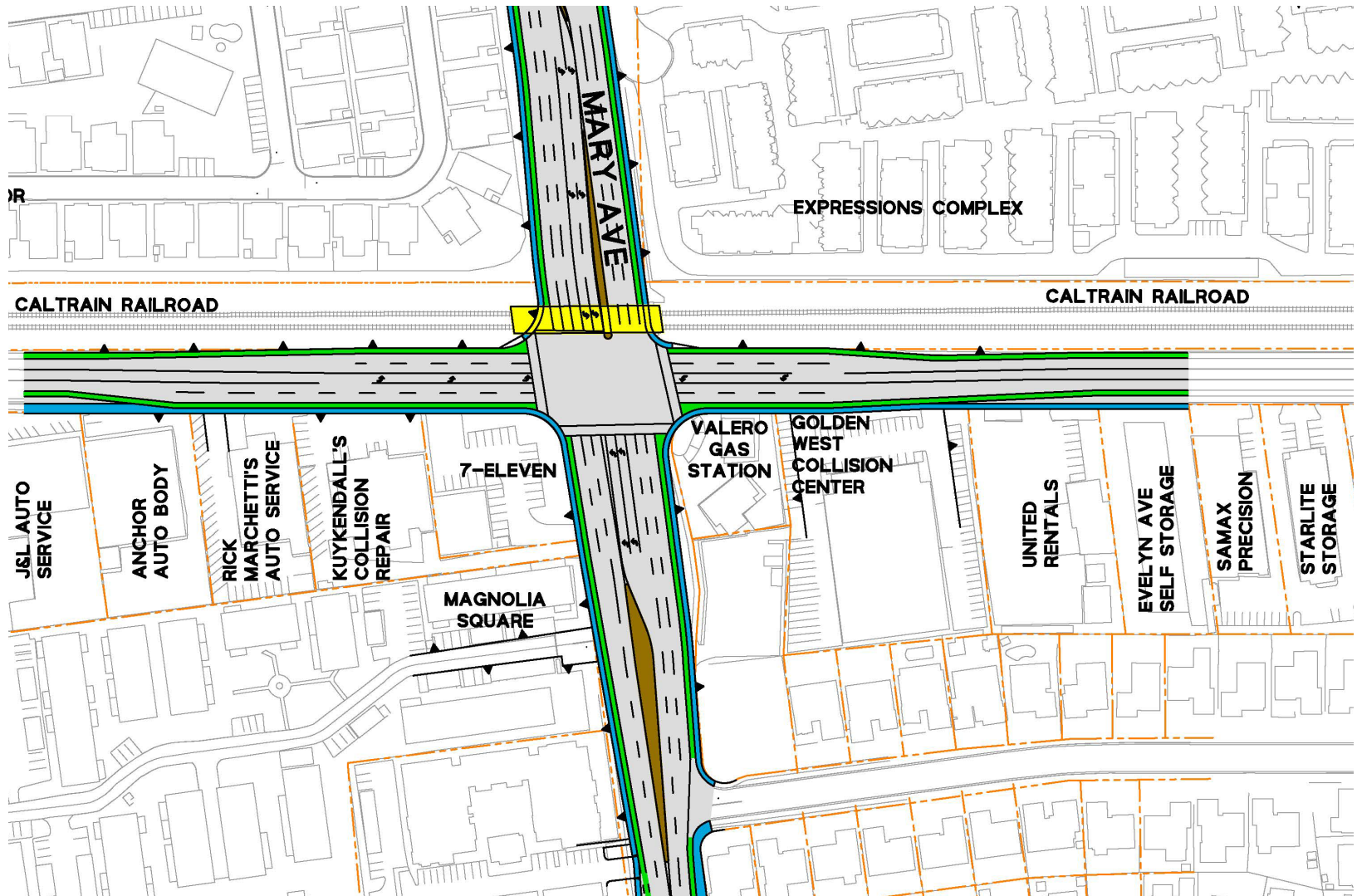

Mary Avenue Underpass Tunnel with Jughandle

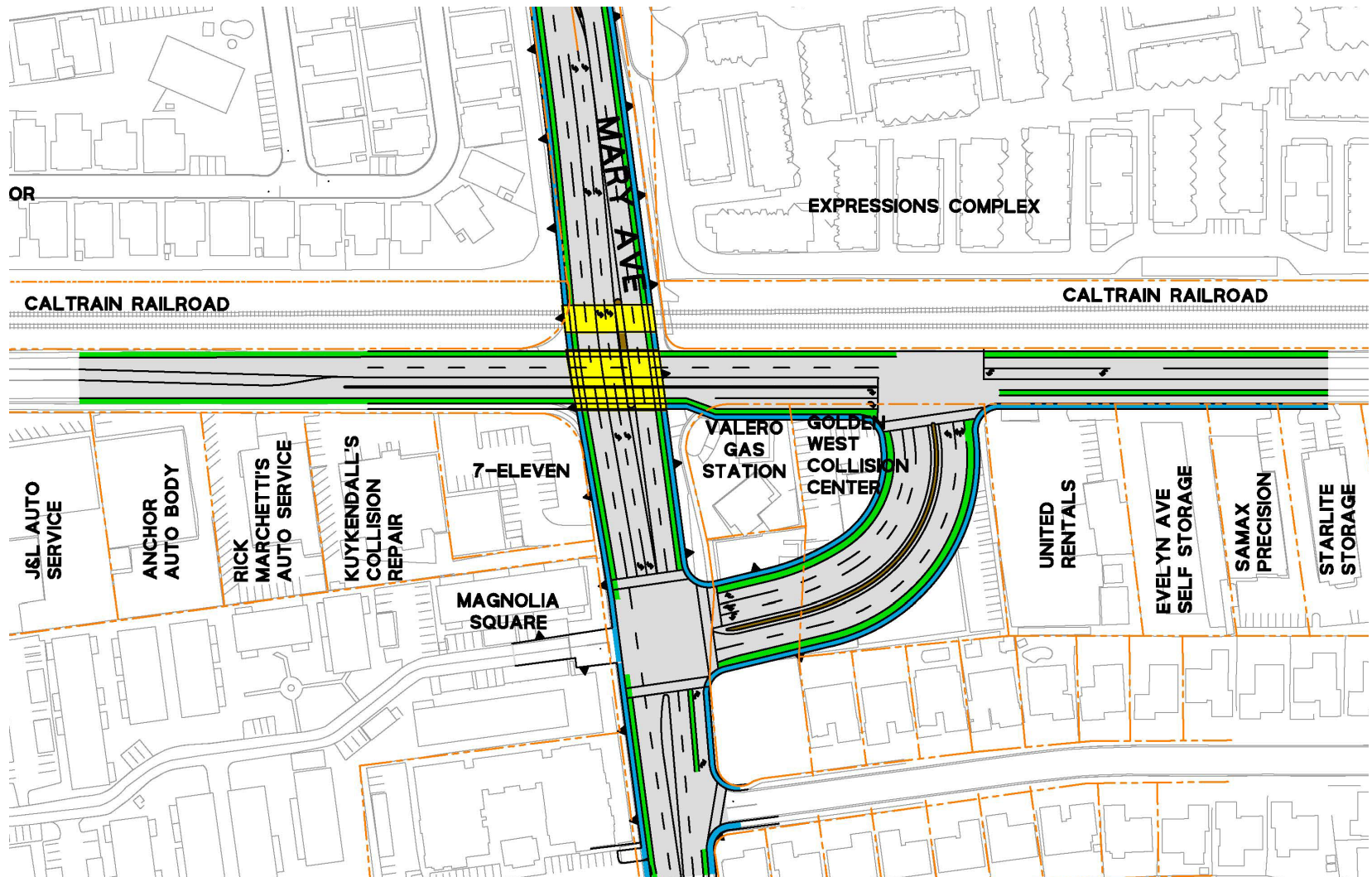

Mary Avenue Underpass Tunnel with Jughandle

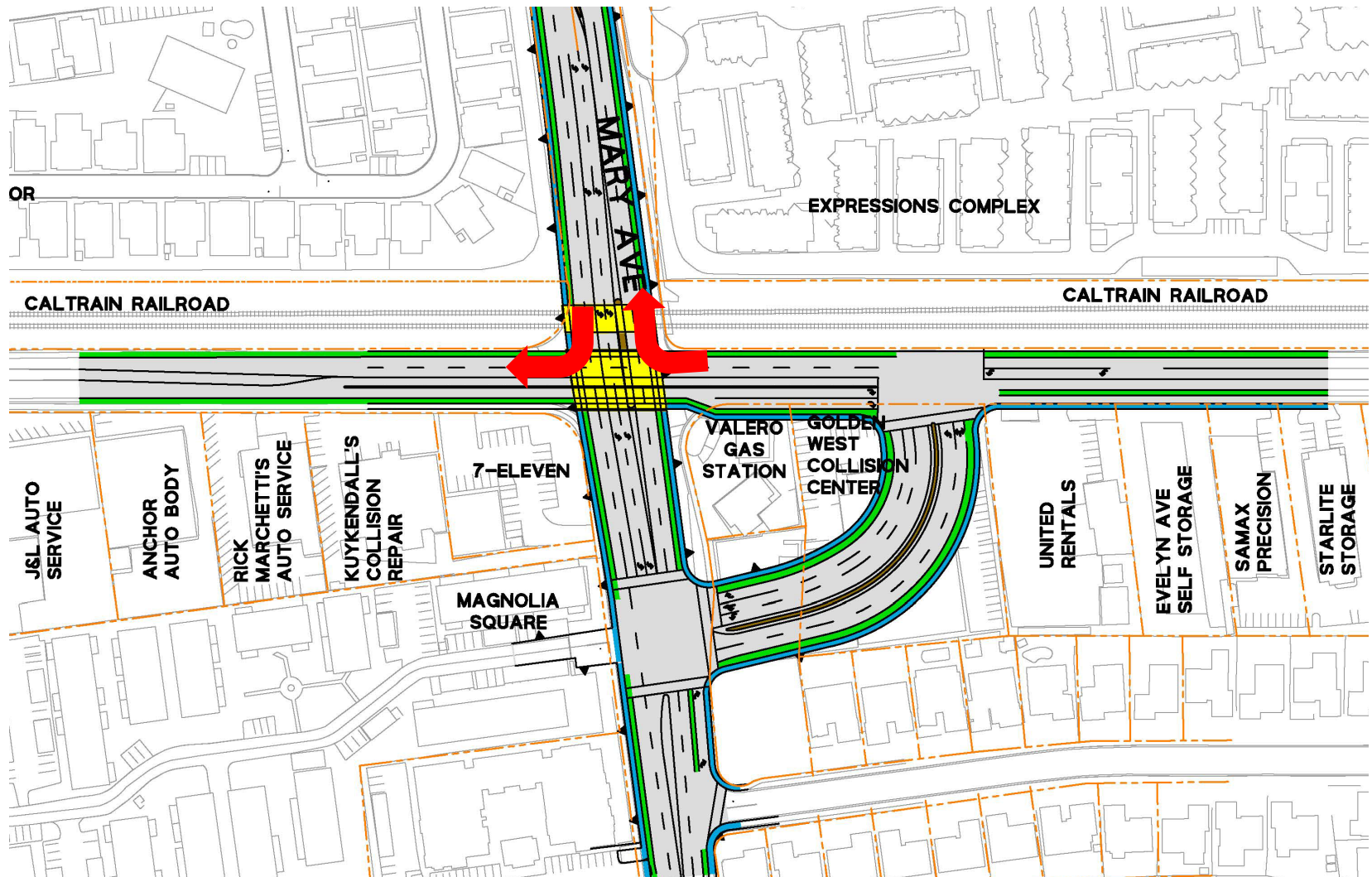

Mary Avenue Underpass Tunnel with Jughandle

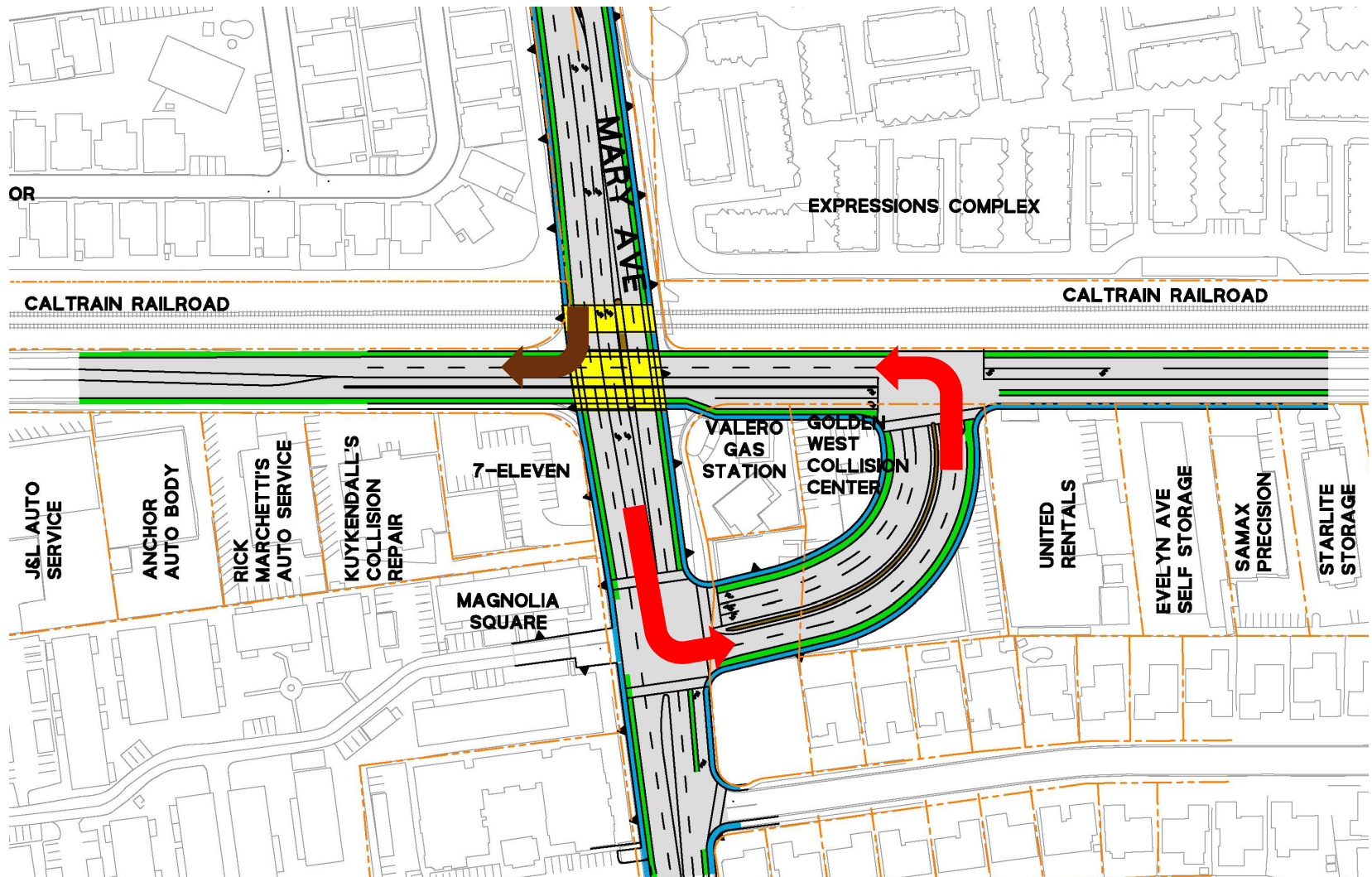

Mary Avenue Underpass Tunnel with Jughandle

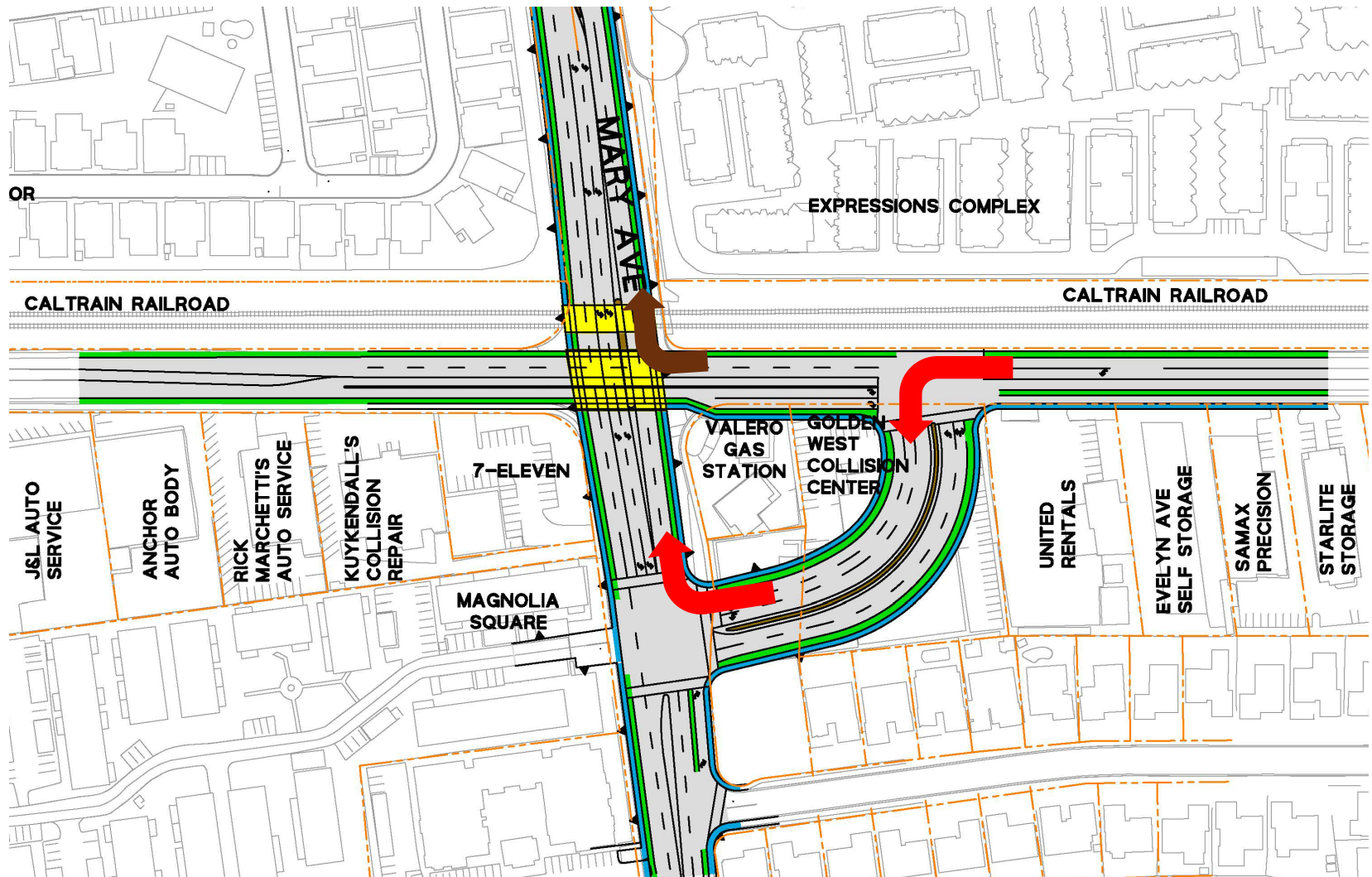

Mary Avenue Underpass Tunnel with Jughandle with Enhancements

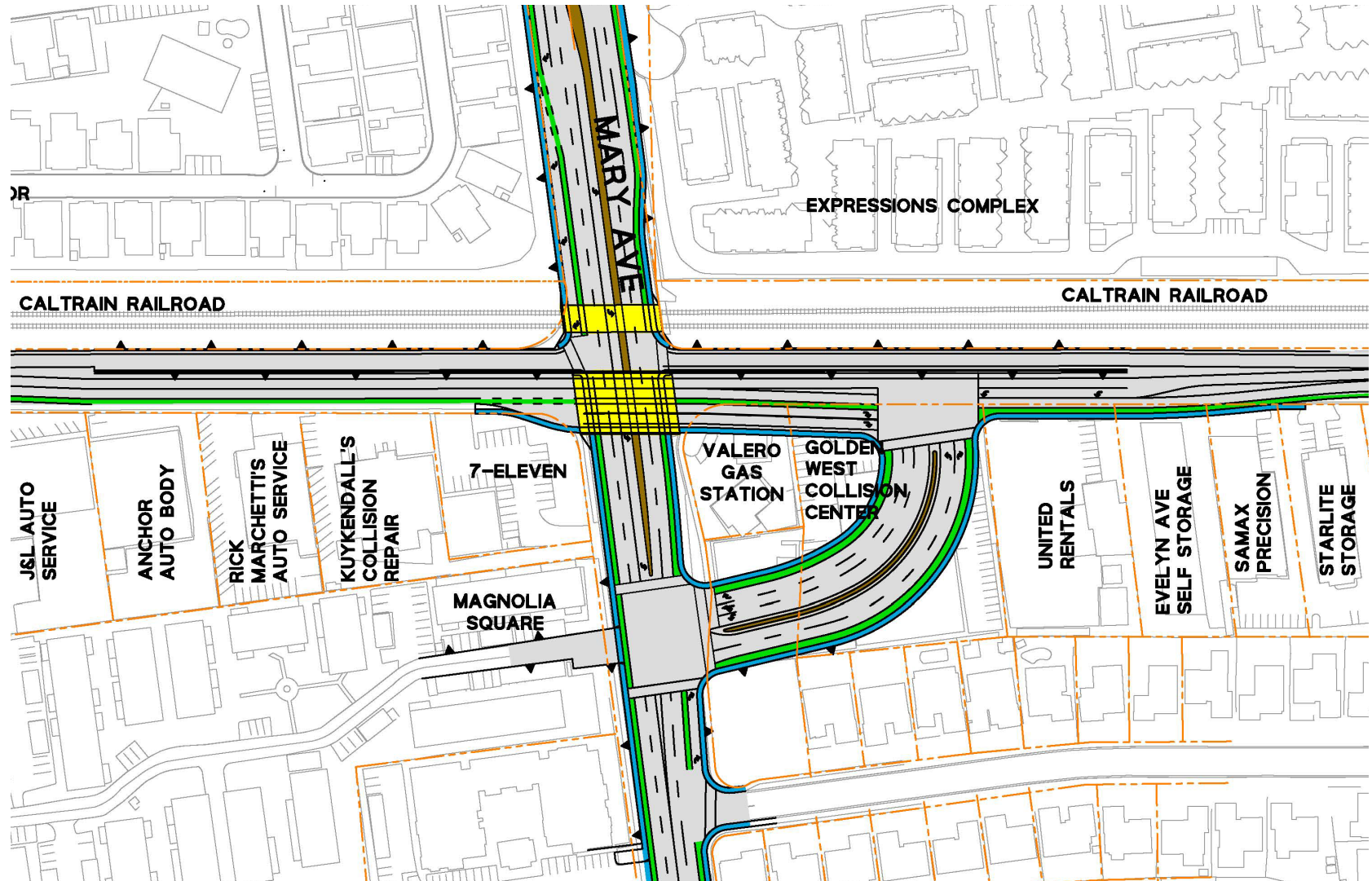

Mary Avenue Underpass Tunnel with Jughandle with Enhancements

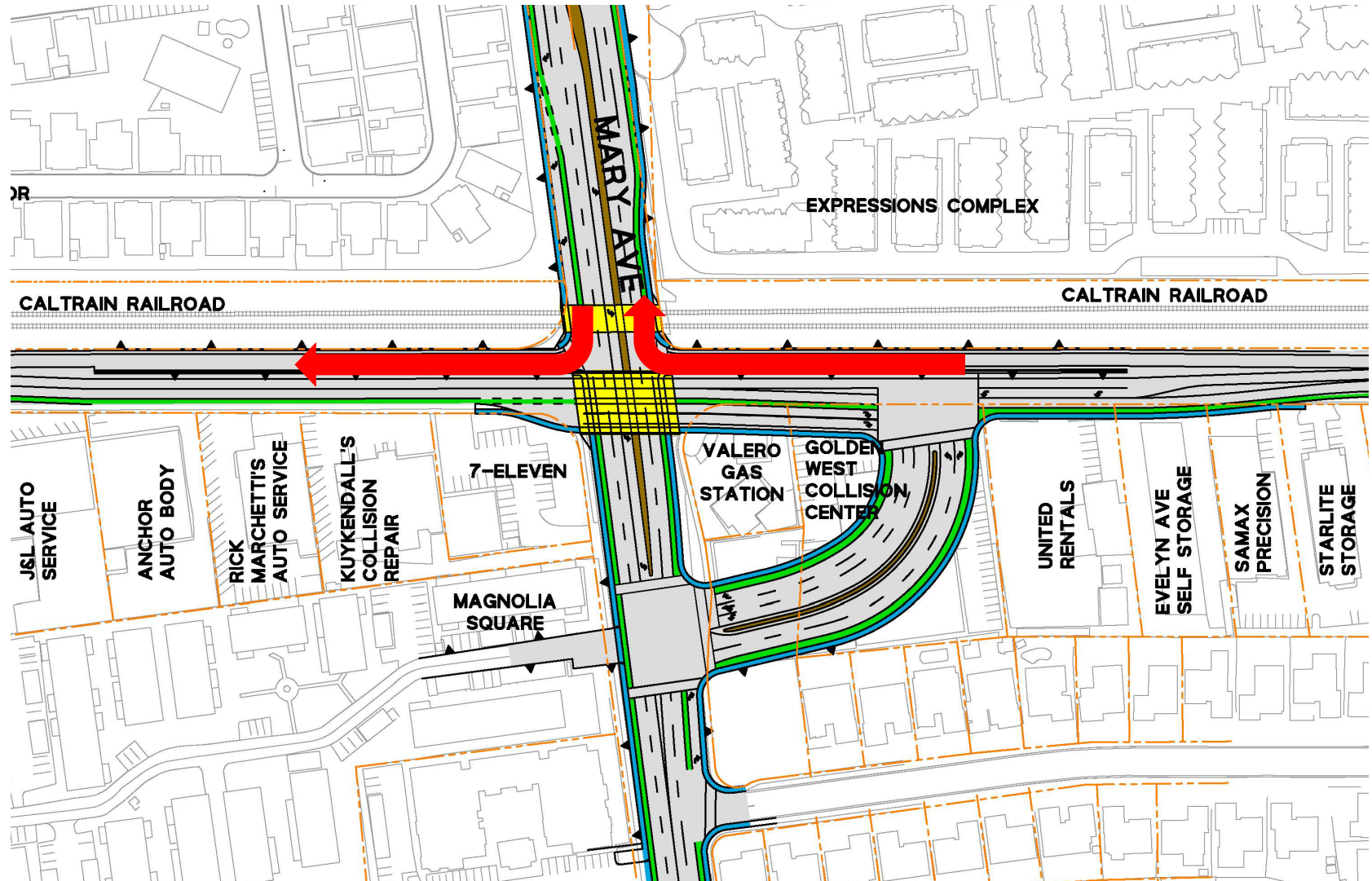

Mary Avenue Underpass Tunnel with Jughandle with Enhancements

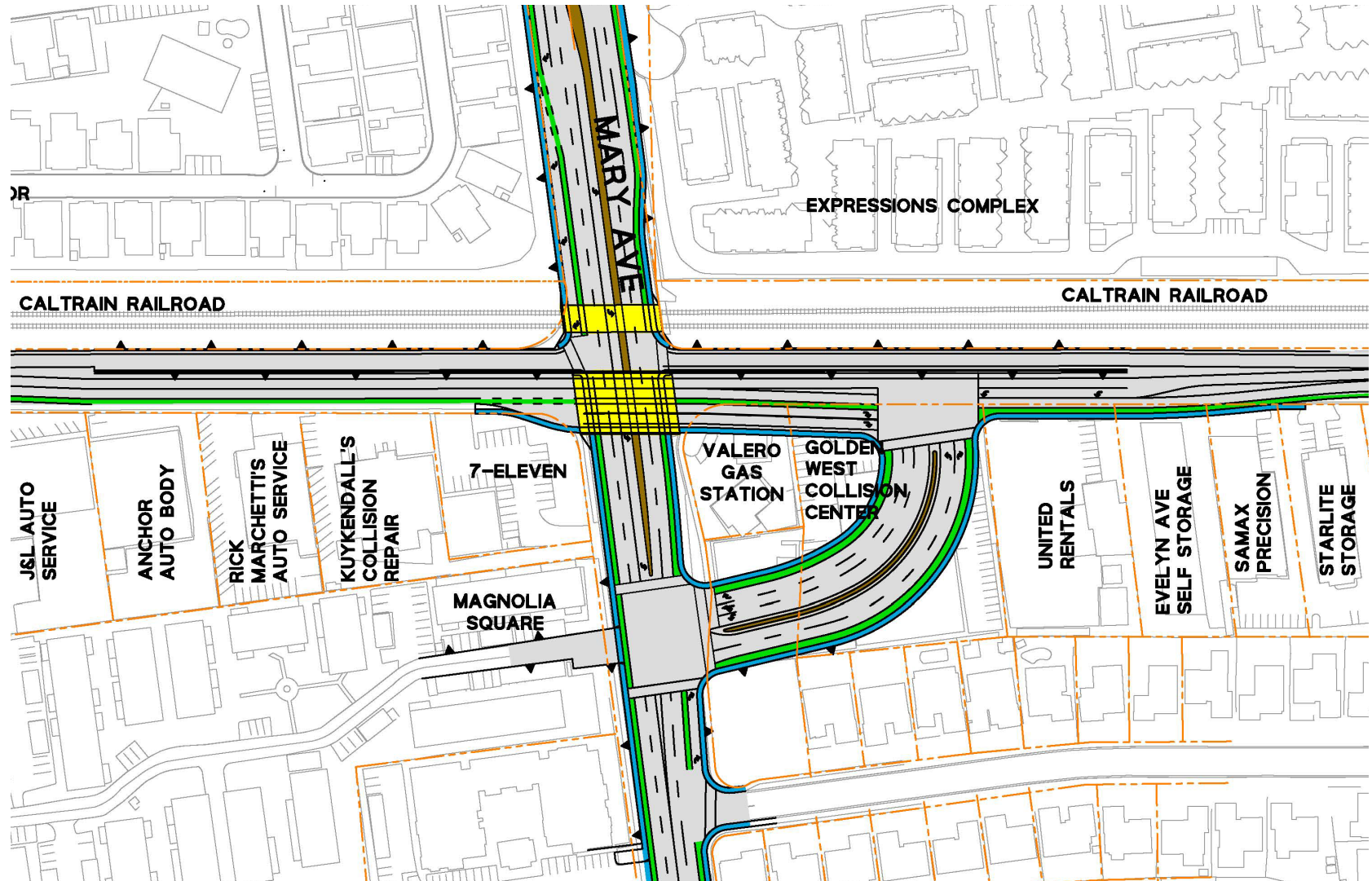



Sunnyvale

Sunnyvale Avenue

Sunnyvale Avenue Underpass Tunnel

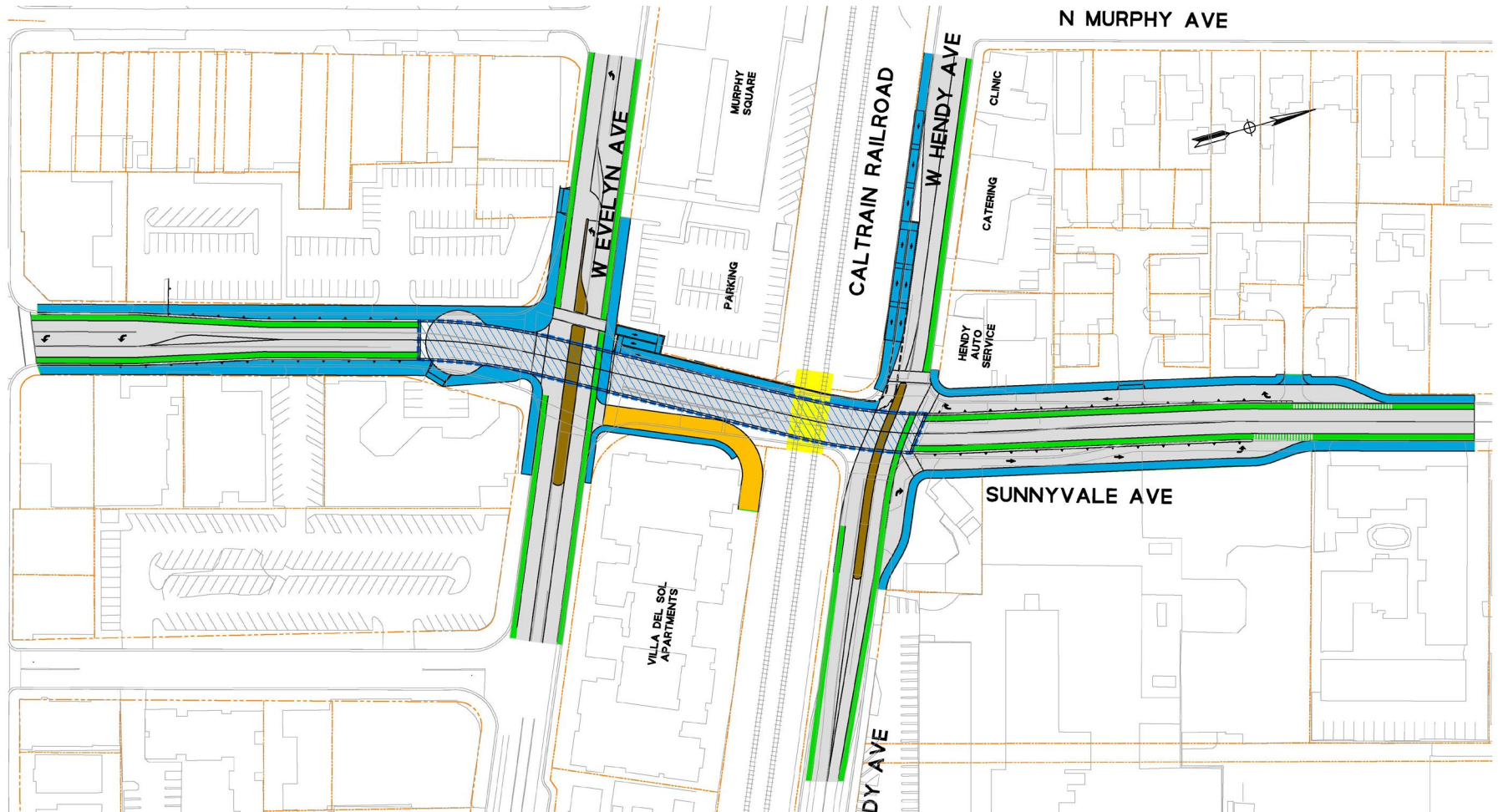

Sunnyvale Avenue Bicycle and Pedestrian Only Undercrossing

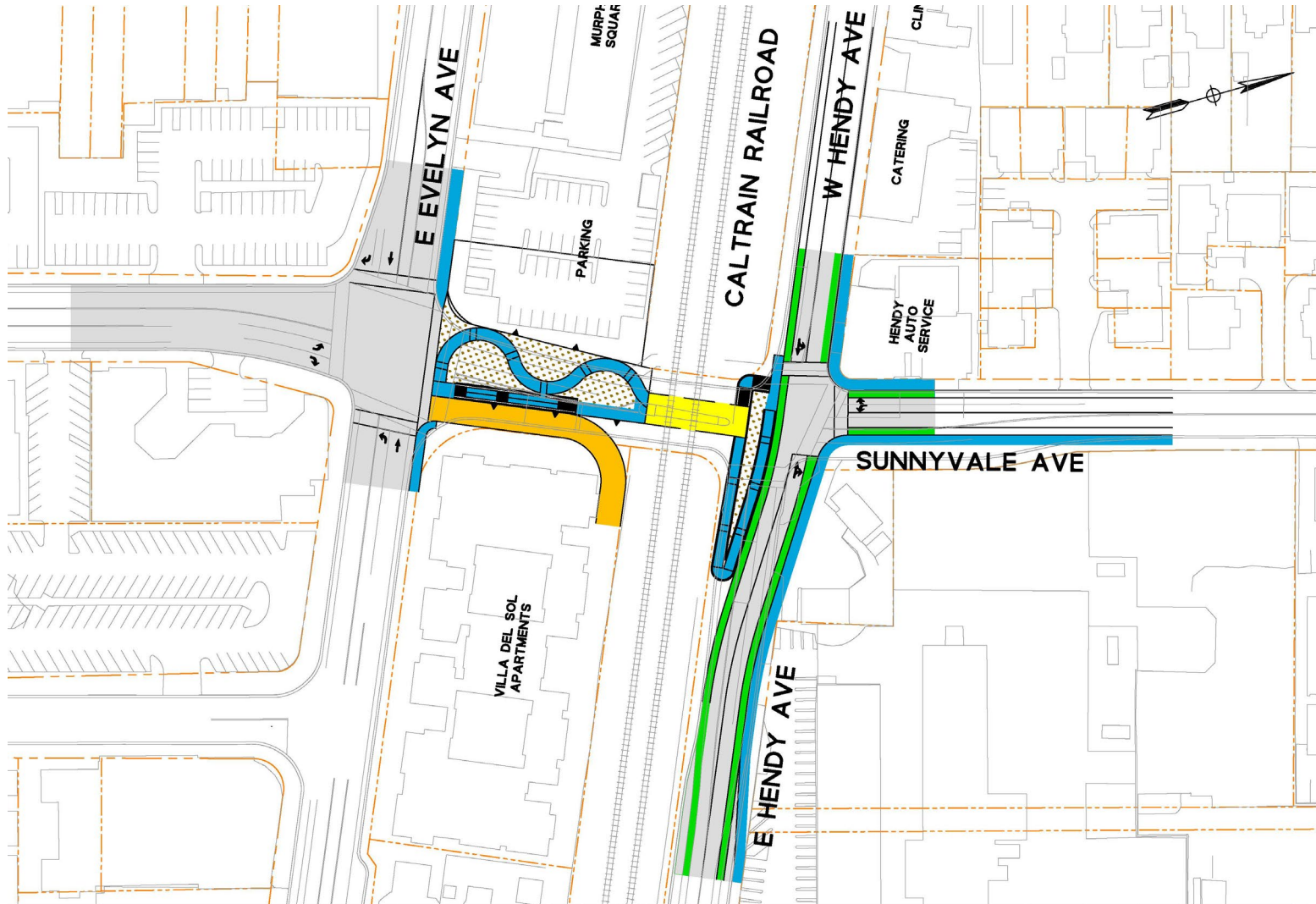

Next Steps

Next Steps

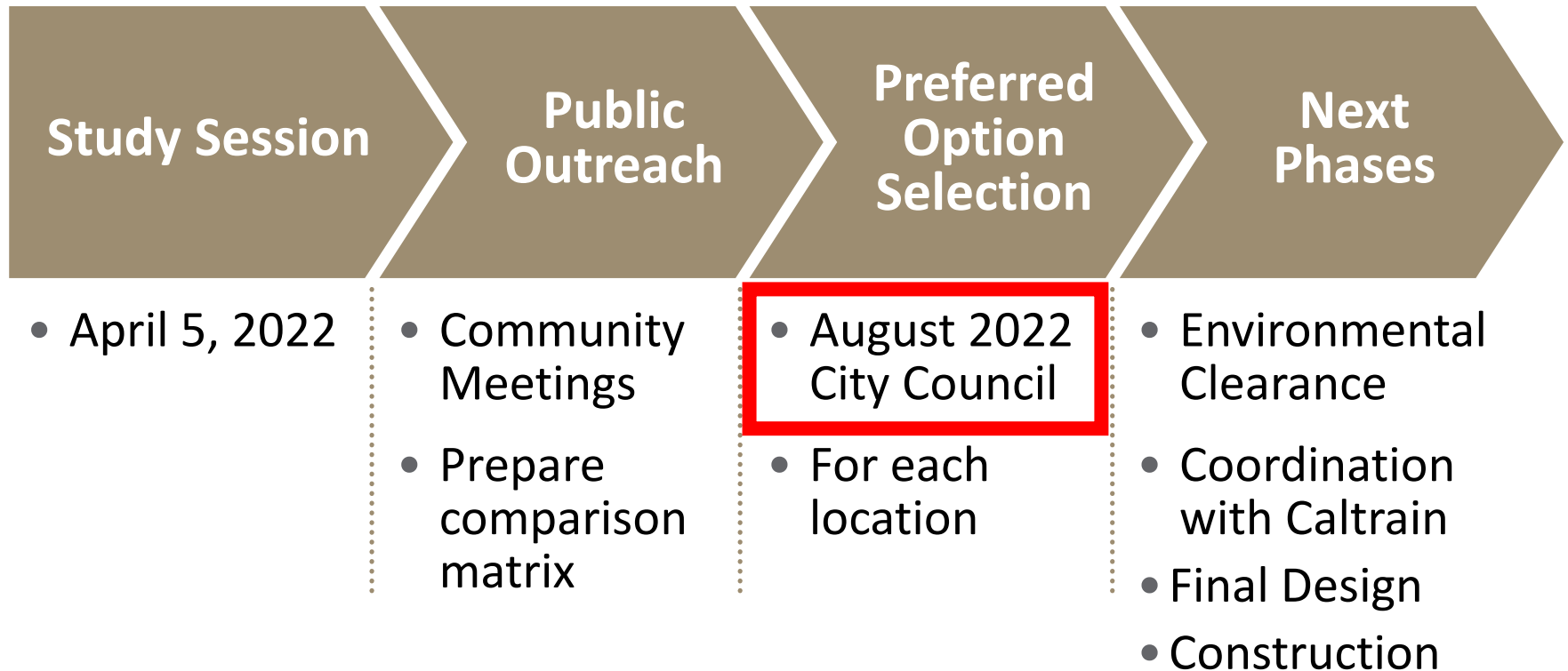

Public Hearing Presentation

- Traffic Data
 - ◆ Travel times
 - ◆ Levels of Service
 - ◆ Traffic rerouting
- Right of way needs
- Bicycle and pedestrian access
- Estimated construction costs
- Summary of community feedback





Thank you