

PROJECT DATA

ZONING:	MS - INDUSTRIAL AND SERVICE
FAR:	ZONED 45% / PROPOSED 100%
SITE:	10.19 ACRES/443,682 SQ. FT.
PARCEL 1	20,459 SQ. FT.
PARCEL 2	42,851 SQ. FT.
PARCEL 3	31,350 SQ. FT.
PARCEL 4	24,543 SQ. FT.
PARCEL 7	24,486 SQ. FT.
PARCEL 8	23,794 SQ. FT.
PARCEL 9	30,935 SQ. FT.
PARCEL 12	86,290 SQ. FT.
PARCEL 10+6	49,067 SQ. FT.
TOTAL	777,457 SQ. FT.

PHASE 1 OFFICE (5 STORY)	178,000 SQ. FT.
PHASE 2 OFFICE (5 STORY)	196,000 SQ. FT.
PHASE 2 OFFICE (5 STORY)	196,000 SQ. FT.
PHASE 3 OFFICE (5 STORY)	196,000 SQ. FT.
MOOSE LODGE	10,000 SQ. FT.
TOTAL (100% F.A.R.)	776,000 SQ. FT.

PARKING REQUIRED MIN.	
OFFICE 2/1,000 SQ. FT.	1,552 SPACES
WAREHOUSE 1/ 1,000 SQ. FT.	0 SPACES
TOTAL	1,552 SPACES

PARKING REQUIRED MAX.	
OFFICE 4/1,000 SQ. FT.	3,104 SPACES
WAREHOUSE 1/ 1,000 SQ. FT.	0 SPACES
TOTAL	3,104 SPACES

PARKING PROVIDED	
ON-GRADE PARKING	688 SPACES
PARKING STRUCTURE (6 LEVELS)	1,530 SPACES
TOTAL (2.9/1000)	2,218 SPACES

VICINITY MAP

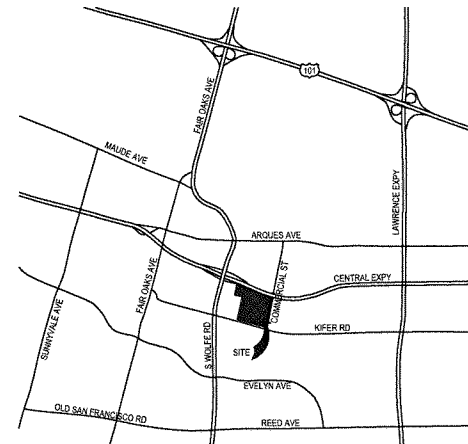

PARKING LEGEND

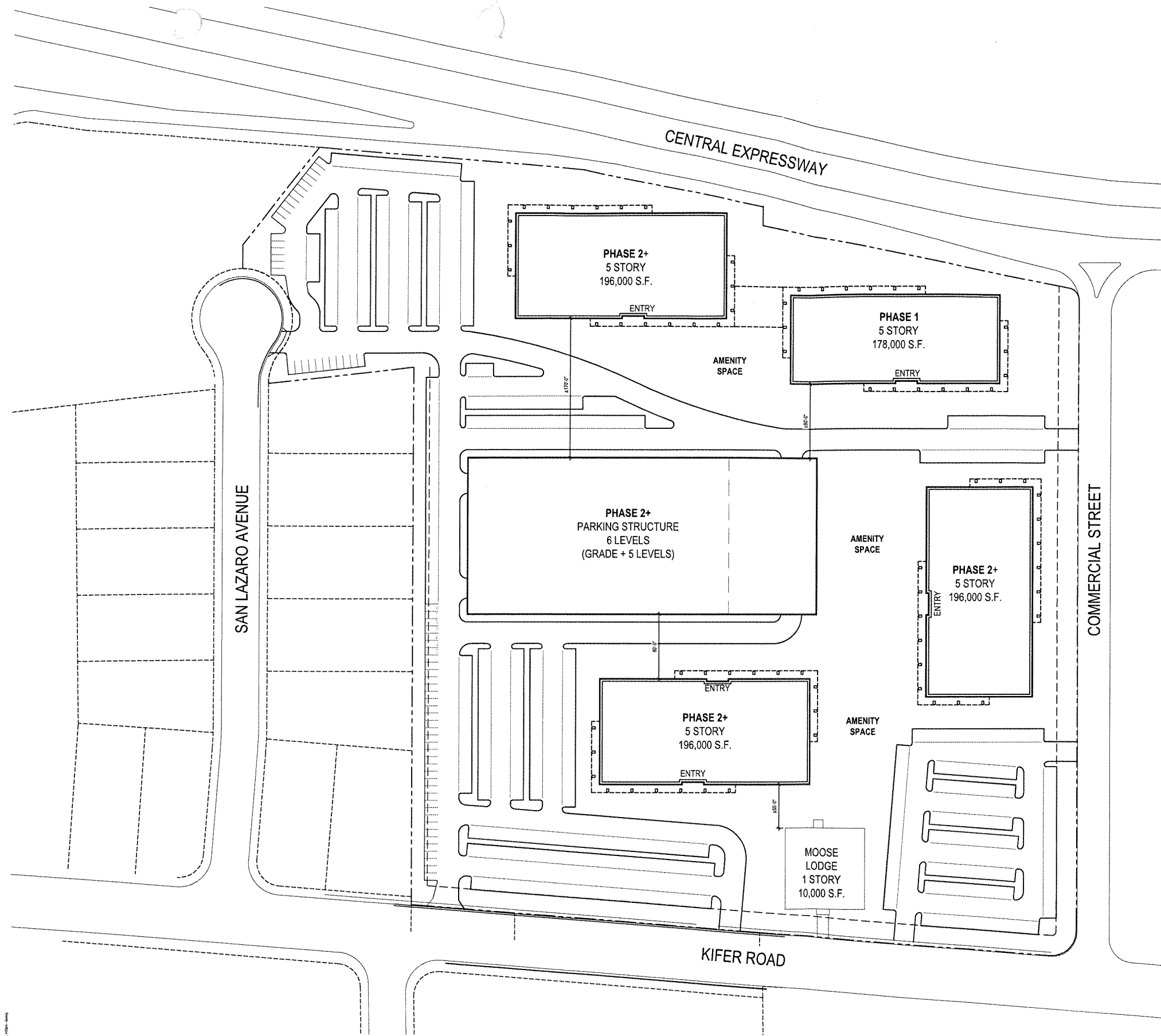
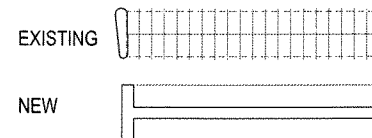

MASTER PLAN

SCALE: 1" = 50'-0"



ARC TEC
ARCHITECTURAL TECHNOLOGIES

www.arctecinc.com
Arizona
2340 East Northcutt Avenue, Building 2
Phoenix, Arizona 85028
P 602.953.2355 F 602.953.2968

California
99 Almaden Boulevard, Suite 840
San Jose, California 95113
P 408.496.0676 F 408.496.1121

The client is responsible for the accuracy of the information provided for this project. ARC TEC is not responsible for the accuracy of the information provided for this project. ARC TEC is not responsible for the accuracy of the information provided for this project. ARC TEC is not responsible for the accuracy of the information provided for this project.

© Copyright ARC TEC, Inc. 2017
In Association with:

A General Plan Amendment for:

FERTINET
899 Kifer Road
Sunnyvale, CA 94086

DATE	DESCRIPTION
06.10.2017	Planning Submittal

MASTER PLAN

A1

PROJECT NO. 164265

PROJECT DATA-EXISTING

ZONING:	MS - INDUSTRIAL AND SERVICE
SITE:	443,682 SQ. FT.
10.19 ACRES/	
PARCEL 1	20,459 SQ. FT.
PARCEL 2	42,851 SQ. FT.
PARCEL 3	31,350 SQ. FT.
PARCEL 4	24,543 SQ. FT.
PARCEL 7	24,486 SQ. FT.
PARCEL 8	23,794 SQ. FT.
PARCEL 9	30,935 SQ. FT.
PARCEL 12	86,290 SQ. FT.
PARCEL 10+6	49,067 SQ. FT.
TOTAL	777,457 SQ. FT.
MOOSE LODGE	10,000 SQ. FT.
EXISTING OFFICE	108,500 SQ. FT.
EXISTING WAREHOUSE	53,350 SQ. FT.
TOTAL (22% F.A.R.)	171,850 SQ. FT.

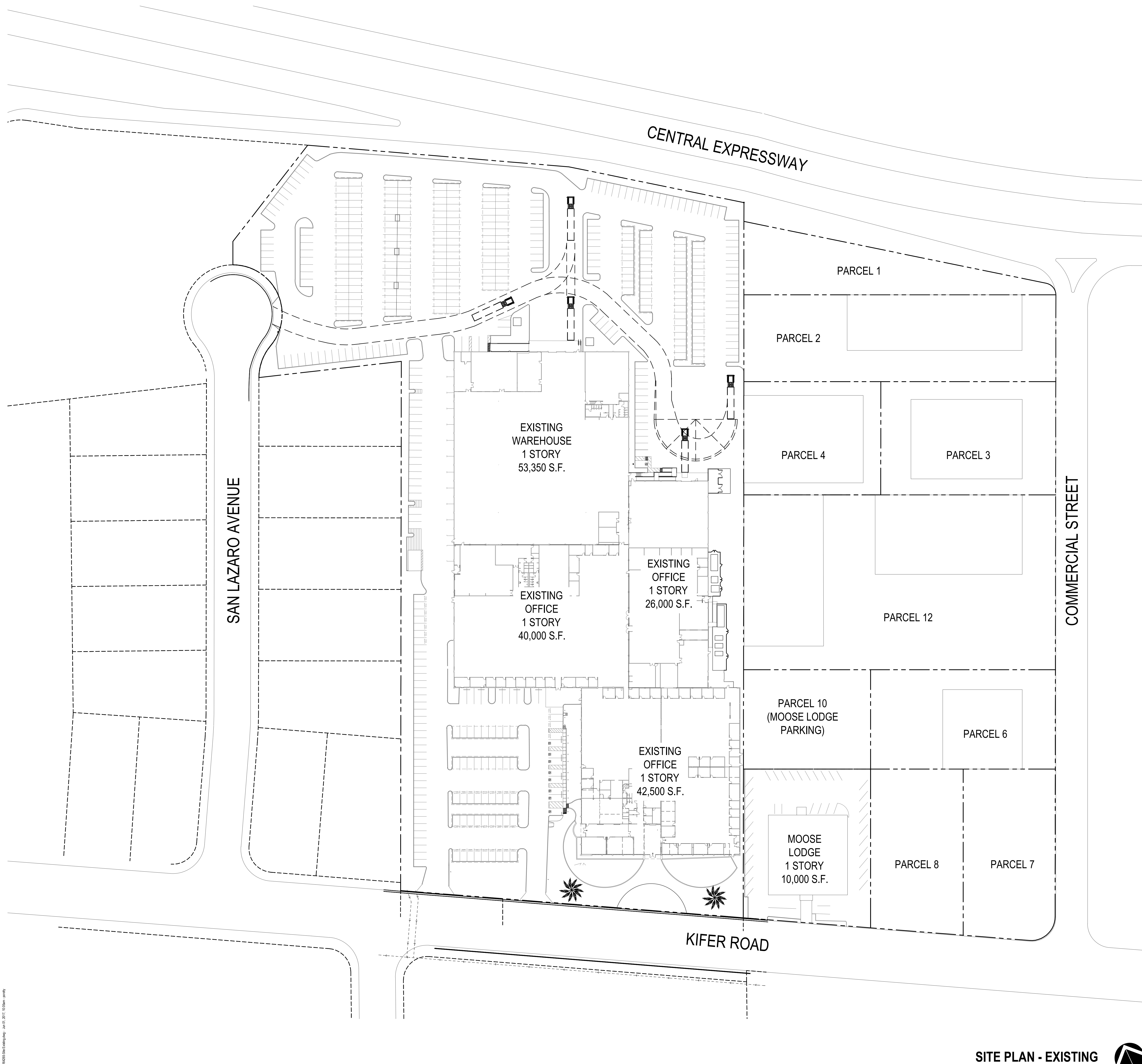

SITE PLAN - EXISTING



VICINITY MAP

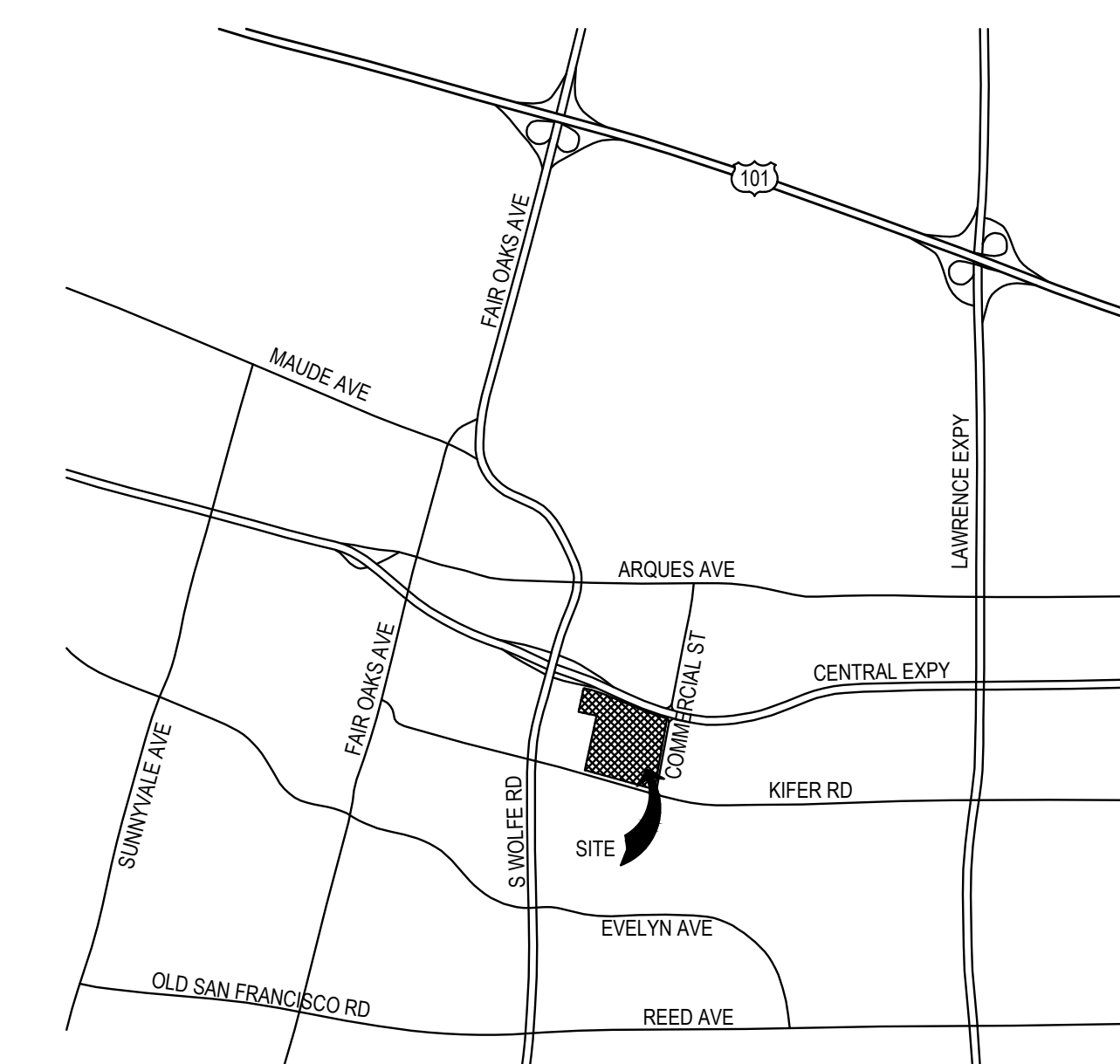

ARC TEC
ARCHITECTURAL TECHNOLOGIES
www.arctecinc.com

Arizona
2960 East Northern Avenue, Building C
Phoenix, Arizona 85028
P 402.953.2395 F 402.953.2988

California
99 Almaden Boulevard, Suite 840
San Jose, California 95113
P 408.496.0676 F 408.496.1121

The "client" is responsible for the accuracy and completeness of the information provided to ARC TEC and ARC TEC consultants. ARC TEC and ARC TEC consultants shall be deemed the author and owner of such documents. The "client" is responsible for the accuracy and completeness of the information provided to ARC TEC and ARC TEC consultants. ARC TEC and ARC TEC consultants shall not be responsible for any errors or omissions in the information provided to ARC TEC and ARC TEC consultants. The user of any information provided by ARC TEC and ARC TEC consultants is solely the user's responsibility. ARC TEC and ARC TEC consultants shall not be responsible for any errors or omissions in the information provided to ARC TEC and ARC TEC consultants. The user of any information provided by ARC TEC and ARC TEC consultants is solely the user's responsibility. ARC TEC and ARC TEC consultants shall not be responsible for any errors or omissions in the information provided to ARC TEC and ARC TEC consultants. The user of any information provided by ARC TEC and ARC TEC consultants is solely the user's responsibility.

© Copyright ARC TEC, Inc. 2017
In Association with:

A General Plan Amendment for:
FORTINET
899 Kifer Road
Sunnyvale, CA 94086

DATE	DESCRIPTION
05.10.2017	General Plan Amendment Submittal

EXISTING SITE PLAN

A0

PROJECT NO. 164265