



WOWHAUS RESUME: ENE OSTERAAS-CONSTABLE & SCOTT CONSTABLE

885 Jonive Road, Sebastopol, CA 95472 (510) 390-1724 • studiowowhaus@yahoo.com • www.thewowhaus.com

*** (NOTE: Scott Constable & Ene Osteraas-Constable have collaborated fully on all commissions; we are submitting a combined resume.)*

SELECT PUBLIC ART COMMISSIONS

- **REVERIE** Donelson Public Library, Nashville, Tennessee, (MetroArts) 2024
A series of 5 large-scale functional marble sculptures will activate a 1-acre public greenspace, inviting engagement and creating seating
- **SKY HORN** University of San Francisco Medical Center, San Francisco, CA 2024
Creating a landmark 12' h x 8' w interactive bronze sculpture featuring 36 kinetic tubular bells and crystals that cast rainbows on passerby
- **MAGNUS** Burlington Great Streets, Burlington, VT 2024
Trio of functional granite sculptures will evoke the natural and cultural history of the City
- **AQUADREAM** Rengstorff Aquatic Center, Mountain View, CA (Mountain View Public Art Program) 2023
Interactive functional sculptures create seating and foster convivial engagement. Collaborating with Mountain View of Parks & Recreation Dept.
- **DREAMY** East Lake Park, Chattanooga, TN (Chattanooga Public Art Program) 2023
Vibrant, fantastical 7' h fiberglass sculptures activate a public park, offering seating and fostering playful interaction
- **BRANT** Lafayette, CA (Lennar Corporation) 2023
Collaborating with City agencies, Lennar Architectural Team and contractor on landmark stainless steel sculpture, internally LED lit
- **INSPIRE** San Ramon Public Library, San Ramon, CA (San Ramon Public Art Program) 2023
Engaged community members and library staff in developing landmark dichroic glass sculpture heralding the library entryway
- **FOREST FRIENDS** Green Bay Botanical Garden Children's Garden, Green Bay, WI 2022
5 interactive large bronze sculptures integrated into the Children's Garden. Collaborated with Smith Group Landscape Architects
- **THRIVE** Hayward, CA (Artsource) CA 2022
Collaborated with developers, architects, city agencies and art consultant on 2-story architecturally-integrated mosaic mural
- **MATHER COMMONS** Mather School Plaza, Boston, MA (Browne Fund) 2022
Collaborated with BSC Landscape Architects and Parterre Garden; community engagement in conception and execution
- **DELRIIDGEKNOW-HOW** Delridge, WA (Seattle Office of Arts & Culture) 2021
Collaborated with Seattle Department of Transportation Landscape Architects; community engagement integral to design
- **QUERCUS** 24th & Harrison, Oakland, CA (Holland Partner Group) 2021
Collaborated with Holland Partner Group Design Team
- **ORCA** Kitsap Middle School, Kitsap School District, Kitsap, WA (Washington Art in Public Places Program) 2021
Collaborated with School District administration, faculty and students
- **A GOOD SIGN** North Tryon Greenroad, Charlotte, NC (Arts & Sciences Council) 2021
Collaborated with Charlotte Department of Transportation and NCDOT Landscape Architects; community engagement in conception and execution

- **WYNADOTTE** Wynadotte Park, Mountain View, CA (Mountain View Public Art Program) 2020
Collaborated with City of Mountain View Parks Department Landscape Architects on series of bronze sculptures
- **WELLSPRING** Coffey Park, Santa Rosa, CA (Santa Rosa Public Art Program) 2020
Collaborated with Carlile Macy Landscape Architects & Santa Rosa Parks Dept. community engagement integral to commission.
- **ASCENT** Pierce College - Fort Steilacoom, WA (Washington Art in Public Places Program), 2019
Engaged Pierce College faculty, staff and students; worked with Pierce College Facilities Department
- **MAKKEWEKS** Oakland Public Art Program, Lake Merritt Park, Oakland, CA (Oakland Public Art Program) 2019
Collaborated with PlaceWorks and City of Oakland Parks Department Landscape Architects
- **GOLDENSPIRAL** STEM Center, The College of New Jersey, Ewing Township, NJ (New Jersey Arts Commission) 2018
Engaged College of New Jersey faculty and students; collaborated with College Facilities Department & John M. Thomas Landscape Architects
- **UNITY PLAZA OMI HISTORY STAIRSCAPE** San Francisco, CA (San Francisco Arts Commission) 2016
Collaborated with San Francisco Municipal Transit Authority Landscape Architects
- **STORYVANES** Walnut Creek, CA (Terramar Developers & Walnut Creek Public Art Program) 2016
Worked with Bruce Jett Landscape Architects
- **GARDEN GUARDIANS** Noe Valley Town Square, San Francisco, CA (San Francisco Arts Commission) 2016
Collaborated with CMG Landscape Architects & San Francisco Parks Department
- **SCUPPERNONG COMMONS** Artplace Environmental Artists in Residence (McColl Center for Art + Innovation), Charlotte, N.C. 2015
Collaborated with LandDesign Landscape Architects
- **SPINNRADL** Cincinnati, OH (Artworks Cincinnati) 2014
Community engagement in conception and execution. Worked with Cincinnati Department of Public Works
- **SPECTRASCAPE** W. Berkeley Library, Berkeley CA (Berkeley Public Art Program) 2014
Collaborated with Harley Ellis Devereaux Architects and library staff; community engagement informed design
- **OASIS** Dublin, CA (AvalonBay Developers), 2013
Collaborated with AvalonBay Landscape Architects
- **TSURU** R. Carr Judicial Center, Denver, CO (Colorado Creative Industries) 2012
Collaborated with Fentress Architects & Civitas Landscape Architects
- **FLUKE** Monterey Bay Marine Sanctuary & Exploration Center, Santa Cruz CA (Santa Cruz Public Art Program) 2012
Collaborated with Thomas Hacker Architect & Landscape Architect; engagement with Museum scientists and staff
- **SPARK** Chabot College, Hayward CA (Chabot College Public Art Program) 2012
Community engagement with Chabot College faculty, staff and students; worked with Facilities Department
- **ABUNDANCE** Ortega Library, San Francisco CA (San Francisco Arts Commission) 2011
Collaborated with City of San Francisco Library Architects & Landscape Architects
- **WATERSHED ART MARKERS** Oakland CA, (Oakland Public Art Program) 2010
Collaborated with Oakland Department of Creeks, Watershed & Stormwater Department and Oakland Public Works Department

- **SUNNYSIDE MENAGERIE** Sunnyside Conservatory Park, SF, CA (San Francisco Arts Commission) 2009
Collaborated with San Francisco Parks Department; community engagement informed design
- **OAKLAND FUSION** Jack London Square, Oakland CA (Ellis Partners, LLC) 2009
- **WISHING WANDS** Berryessa Creek Park, San Jose, CA (San Jose Public Art Program) 2009
Collaborated with San Jose Parks Department and Department of Public Works; community engagement informed design

PUBLIC ART MASTER PLANNING

- **RAIL TRAIL PUBLIC ART MASTER PLAN**, Artplace Grant, Charlotte Center City Partners, Charlotte, N.C. 2015
Created a Public Art Master Plan for a four-mile public greenway that transects the City Center

BRIGHTWALK, McColl Center for Visual Art + Innovation, Charlotte, N.C. 2015

Consulted on public art planning for environmentally-oriented artworks at Brightwalk, a 98 acre mixed-use development.

- **VILLAGE AT MARKET CREEK ART+DESIGN PLAN**, Jacobs Center for Neighborhood Innovation, San Diego, CA 2012 Contributed to a comprehensive public art plan for a 60+ acre community identifying sites & guiding principles for public art.

COMMUNITY ENGAGEMENT & SELECT ARTIST RESIDENCIES

- **MCCOLL CENTER FOR ART & INNOVATION**, Artplace Environmental Artists in Residence, Charlotte, N.C. 2015
- **HEADLANDS CENTER FOR THE ARTS**, Marin County, CA 2013
- **MICHAEL J. KOHLER ARTS CENTER**, "Connecting Communities" Artists in Residence, Sheboygan, WI, 2010
- **MILDRED'S LANE**, Beach Lake, PA 2001 & 2009
- **"CRAFT & DESIGN: HAND, MIND & THE CREATIVE PROCESS"**, Haystack w/ Cooper-Hewitt National Design Museum, Smithsonian Institution, Maine, 2004

SELECT PUBLICATIONS

2021 "Derivsh", Land Art Generator Institute
2021 "Art that Commemorates", CODA Magazine
2021 "Coffey Park Reopens at Long Last, To Rave Reviews", Press Democrat
2019 "Lake Merritt and Snow Park Project", Piedmont Exedra

SELECT AWARDS/GRANTS

CODAWORX Merit Award for Public Art: Education 2021
A1 Artist Travel Grant – Rome & Switzerland (S.C.) 2013
Wornick Distinguished Visiting Professor of Woodworking, California College of Arts and Crafts (S.C) 2010
Center for Cultural Innovation Investing In Artists Grant Recipient (S.C) 2008
City of Oakland Individual Artist's Grant (E.O.C) 2006
Creative Work Fund (E.O.C.) 2000

SELECT EXHIBITIONS

2019 The Art of Resilience, World Bank Group Exhibition
2016 Free (for) Free, Mildred's Lane Complex(ity), Narrowsburg, N.Y.
2016 Craft Atelier II, Storefront Lab, San Francisco, CA
2014 Reimagining Progress: Production, Consumption and Alternative Economies, David Brower Center, Berkeley, CA
2014 If A Tree Falls, University of California at Davis Design Museum, Davis, CA
2013 This Will Never Work, Southern Exposure, San Francisco, CA

Select Exhibitions Continued

2012 Big, Big Backyard: Contemporary Community-Engaged Art, College of the Canyons, Los Angeles
2012 Banff, Banff New Media Symposium, Banff Centre, Canada
2011 John Michael Kohler Arts Center, "Connecting Communities" Residency, Sheboygan, WI
2009 Terroir: A Sense of Place, MCF, Petaluma, CA
2008 MIX, Southern Exposure, San Francisco, CA
2006 Hybrid Fields, Sonoma County Museum, Santa Rosa, CA
2006 Social Construction, Southern Exposure Gallery, San Francisco, CA
2005 Four Projects, Richard L. Nelson Gallery, University of California at Davis, Davis, CA
2003 Bay Area Furniture Art Blue Room Gallery, San Francisco, CA
2003 Lost Space, Phoenix Garden, London, England
2002 Grizedale Live, Grizedale Arts, Cumbria, England
2002 Treehouse: Shelter, Sanctuary, Stage, Stone Quarry Sculpture Park, Cazenovia, NY
2002 Utopia Now! (and Then) Ecology/Art Expedition Survey: Phase 1, Sonoma County Museum
2001 Add/Drop/Add, Oliver Arts Center, California College of Arts & Crafts; Oakland, CA
2001 FSC Certified Wood Products Exhibition, San Francisco Airport Museum; San Francisco, CA
2000 Chicago Decorative Arts, Art Institute of Chicago; Chicago, IL
2000 California Design 2000, San Francisco, CA
1997-2001 Re(f)use- Design from Reused and Renewable Materials, The First European Arango International Design Exhibition: Stuttgart, Breda, Ghent, Athens, Barcelona, Hong Kong, Singapore, Tokyo, Taipei, Copenhagen, Paris, Utrecht

EDUCATION

E.O.C.: BFA, Univ. of Massachusetts, Amherst, MA, 1987
S.C.: BFA - Sculpture, School of the Art Institute of Chicago 1982-85
Foundations/Architecture, Rhode Island School of Design 1981-82



1. WELLSPRING, 2021 (\$110,000)

Media: GFRC (Glass Fiber Reinforced Concrete), Recycled Glass Aggregate, Opalescent & Phosphorescent Glass Mosaic

Commissioned by: Santa Rosa Public Art Program

Location: Rain Garden, Coffey Park, Santa Rosa, CA

Dimensions: Large Raindrop Sculpture: 5'6" h x 2'6" w. Small Raindrop Sculpture: 4' h x 2' w

Integrated into a rain garden that reclaims stormwater, functional sculpture invite playful engagement; they can be pivoted to create an endless array of seating arrangements. Glass terrazzo and mosaic shimmer in sunlight; phosphorescent mosaic glows at night. Evoking the regenerative qualities of rainwater, interactive raindrop sculptures commemorate the resiliency of the Coffey Park community, many of whom lost their homes in the 2017 Tubbs Fire. Wowhaus collaborated with the Santa Rosa Public Art Program, Carlile Macy Landscape Architects & Santa Rosa Parks Department. Extensive community engagement with community members of all ages informed the design.

2. GOLDEN SPIRAL, 2018, (\$196,000)

Medium: FRP (Fiber Reinforced Polymer), Steel & Concrete

Site: The College of New Jersey, Ewing, NJ

Commissioned by the College of New Jersey

Dimensions: 28' w x 7.5' h chalkboard; seating is 18" h

This 28' w landmark functional sculpture inspired by the Fibonacci sequence is a community hub and focal point on campus, fostering a sense of community. People gather to sit together within the dramatic space that also functions as an outdoor classroom space with a chalkboard. The sculpture serves as an icon for the College, embodying the search for knowledge and insight via interdisciplinary inquiry and higher education. The sculpture is dramatically lit at night with energy-efficient LED lighting.

3. DREAMY, 2023, (\$150,000)

Media: Fiberglass, Stainless Steel, Exterior Grade Paint, Concrete

Location: East Lake Park, Chattanooga, TN

Commissioned by: Chattanooga Public Art Program

Dimensions: 7' h x 3.5' w

Four 7' h fantastical swan sculptures evoke the historic era when East Lake Park contained the City's first zoo. Inspired by our conversations with local children who envisioned large creatures in the park and in the lake, these iconic functional sculptures offer a fantastical, magical space for people to sit and gather, creating a beloved destination within the park and embodying the vibrant diversity of the community via a vivid color palette. Community engagement informed design.

4) MAKKEWEKS, 2019, \$200,000

Commissioned by: Oakland Public Art Program
Location: Lake Merritt Park, Snow Park Promenade, Oakland, CA
Media: Cast bronze, photo etched granite
Dimensions: 7' x 17' x 11'

Inspired by an Ohlone myth about a seamonster that inhabited a nearby saltwater estuary, this artwork offers insight into local ecological & cultural history. "Makkeweks" hovers among reeds in a rain garden that reclaims rainwater, evoking a seamonster in a large public plaza at Lake Merritt Park, inviting engagement and interaction. The creature is a fantastical amalgam of creatures that actually inhabit the restored estuary, including leopard shark and bat rays.

5) FLUKE, 2011 (\$115,000)

Media: Cast bronze, glass, recycled glass aggregate, pigmented concrete

Client: Santa Cruz Redevelopment Agency

Location: Monterey Marine Sanctuary Exploration Center, Santa Cruz

Dimensions: 14' w x 3' x 3.6' bronze in a 30' w plaza

A landmark 13' wide cast bronze whale tail or "flake" sculpture anchors a dynamic oceanic public plaza design that serves as a gateway to the museum; the sculpture has become an icon of the museum and its environmental conservation mission. Wowhaus designed the entire entryway, including paving, bronze sculpture and granite seating (not shown).

6) REVERIE, 2024 – IN PROGRESS (\$250,000)

Media: Tennessee Marble

Client: MetroArts

Location: Donelson Public Library, Nashville, TN

Dimensions: Vary. Up to 8' l x 4' h x 24" w

A variety of organic, abstract marble sculptures invite library patrons to sit and linger in the greenspace entry to this library, fostering engagement. The artwork was designed to nurture interaction and encourage reading, writing, drawing, conversation, music and every flavor of creativity and play. A state of reverie invites creativity and nurtures new ideas; in an era dominated by digital and virtual experiences, 'Reverie' invites presence and visceral engagement with the world around us. Wowhaus collaborated with landscape architects and architects to integrate the artwork within the landscape design.

7). ABUNDANCE, SILVER FISH, 2011 (\$75,000)

Media: Iridescent Glass Mosaic, Cast Glass, Mirror, Steel, Concrete

Commissioned by the San Francisco Arts Commission

Location: Ortega Branch Library, San Francisco

Dimensions: 11' h x 8' x 3' circumference

A landmark 11' h iridescent mosaic fish sculpture at entryway to library celebrates the tiny silver "forage fish", species which are vital to the ocean's ecosystem yet are threatened. Paired with 8' l orange Rockfish sculpture integrated with native grasses, the artwork raises awareness of the Pacific Ocean ecosystem; the coast is within view of the Library. Wowhaus sought input from Library staff and patrons in creating the artwork, which invites hands-on engagement as the durable mosaic sparkles in the sunshine.

Wowhaus Image List p. 3

8. WISHING WANDS, (One of Three) San Jose, CA 2009 (\$50,000)

Media: Stainless steel, crystal, concrete

Site Berryessa Creek Park, San Jose

Commissioned by: San Jose Public Art

Dimensions: Three sculptures, each 13' tall; seed head 30" across

Evoking the childhood tradition of making wishes by blowing on dandelion seed heads, a series of three sculptures are sited near a playground in a public park. Each seed head features thirty eight 2 1/2" Austrian Crystals that catch the light, refracting sunlight in prismatic rainbows on passerby below. Children delight in playing amidst the rainbows.

9. GARDEN GUARDIANS, 2016, \$37,000

Commissioned by: San Francisco Arts Commission

Location: Noe Valley Town Square Park, San Francisco, CA

Media: Cast bronze, stainless steel

Dimensions: 36" x 24" x 12" Smaller owl: 30"h x 20"w x 12"

Two engaging interactive bronze owl sculptures feature voids for eyes, inviting children to peer through literally and figuratively seeing the world through the birds' eyes. Children delight in "hooting" and interacting with the creatures; these highly durable sculptures are integrated with native plantings in an urban public park, bringing people closer to nature within the cityscape. Great Horned Owls are common to San Francisco and play a vital role in the ecosystem.

10. THRIVE, 2022, (\$96,00)

Media: Opalescent Glass Tile, silver-backed tile, grout

Site: Clawiter Mixed Use Development, Hayward, CA

Commissioned by: Hines Fine Art Consulting

Dimensions: 18' w x 28' h'

Ecologically-oriented artwork activates a commons in a large development: this landmark opalescent glass mural is inspired by one of Hayward's smallest, yet significant, inhabitants — the Western Blue Pygmy Butterfly. The tiny butterfly thrives in saltwater marshes that adjoin the City; its existence here is testimony to the success of Hayward's visionary efforts to restore this diverse ecosystem that helps protect the City from sea level rise. The vibrant color palette of the artwork evokes the rich cultural diversity of the City.

WOW
HAUS



1) WELLSPRING



2) GOLDEN SPIRAL



3) DREAMY



4) MAKKEWEKS



5) FLUKE



6) REVERIE (In Progress) – *Donelson Public Library, Nashville, TN



7) ABUNDANCE – *Ortega Branch Public Library, San Francisco, CA



8) WISHING WANDS



9) GARDEN GUARDIANS



10) THRIVE

SAMARA

Public Art Proposal for Lakewood Library, Sunnyvale CA

By WOWHAUS • November, 2023

Samara is a duo of engaging artworks that celebrate the vital role of the Lakewood Library in nurturing the seeds of literacy, curiosity and knowledge within the community. This unique design is inspired by an actual seed found in nature - the graceful form of the *Samara*, a type of winged seed of Big Leaf Maple Tree. Activating the library entryway, two large-scale striking sculptures invite multisensory engagement and interaction, fostering peoples' connection to nature and to each other. The dynamic, organic forms of the artwork complement the biophilic design of the library, linking the sculptures to the beautiful maple trees within the Library's atrium space and creating a vibrant environment that welcomes all.

The design consists of two sculptures, metaphorically linking earth and sky. The specific siting of the artwork is flexible and will be determined in collaboration with your architect and key stakeholders:

- A dramatic solid **green granite sculpture** evokes the symmetrical seed structure of the Samara seed pod of the Big Leaf Maple, a California native; this inviting smooth artwork creates seating, inviting people to sit, read, and come together within the verdant atrium space.
- Overhead, a graceful **suspended sculpture** evokes the spiral trajectory of a Big Leaf maple seed as it descends to earth in the autumn. Alternately, the same design can be installed as a standing sculpture. The sculpture creates an animated, everchanging composition as one walks through the space, inviting engagement. The shimmering, exterior grade chromatic surface of the aluminum sculpture shifts color as well, echoing the organic gradations of green and gold found in each maple seed.

(An interpretive plaque near the artwork will explain the metaphoric significance of the Samara - the winged seed forms that inspired the artwork - as well as offering insight into the botany of the Big Leaf Maple Tree.)

The maple seed takes flight on the wind; the theme of flight is also an apt metaphor for learning and the role of libraries, lifting curious minds to new heights. In nature, flight is essential to regeneration, migration and pollination. The theme of flight permeates the history of Sunnyvale as well. Established in 1930, Moffet Field began as a dirigible base and would go on to become home to cutting edge research into aeronautics and space flight, leading to the development of Silicon Valley. Libraries plants the seeds of inquiry and innovation for generations to come; this artwork honors the vital role libraries play in honoring nature and knowledge, nurturing an equitable, sustainable future. Visible from both the park and surrounding area, *Samara* is destined to become a beloved landmark and destination in the Lakewood community, enriching and enlivening daily life within this thriving neighborhood.

***This is a preliminary design; upon receipt of input and more information, adjustments and modifications may be made in the final design.*

SCULPTURE DETAILS



Seed Spiral Sculpture: Aluminum with Exterior Grade Polyurethane Chromatic Finish

Sculptural element: 50" w x 96" L; weight is no more than approximately 100 lbs.

Installed with lower end of sculpture approximately 10' from the ground

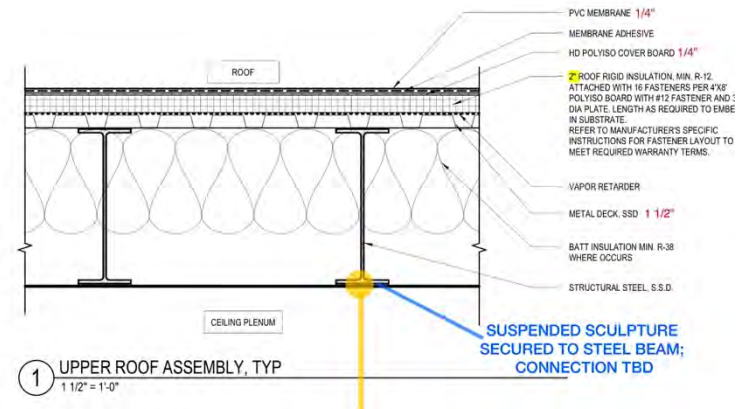

Seating Sculpture: Solid Granite. Each "wing" is 6.75' long x 19" w at widest x 16" h.

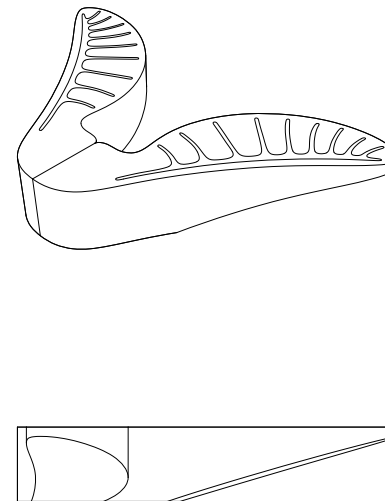
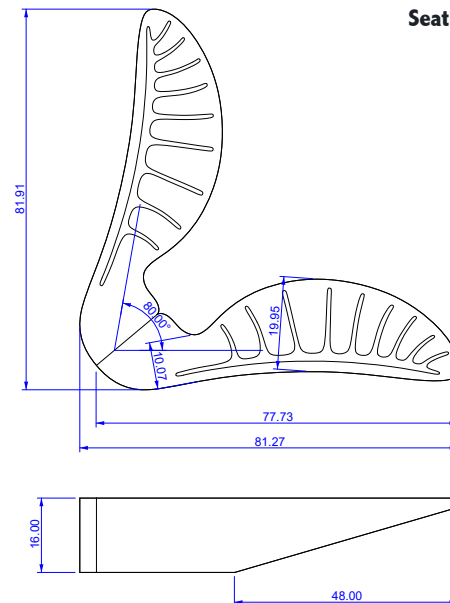





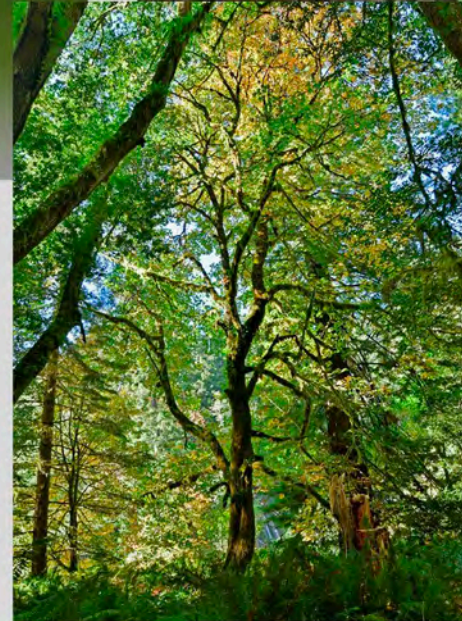

THE BIG LEAF MAPLE TREE IS NATIVE TO CALIFORNIA

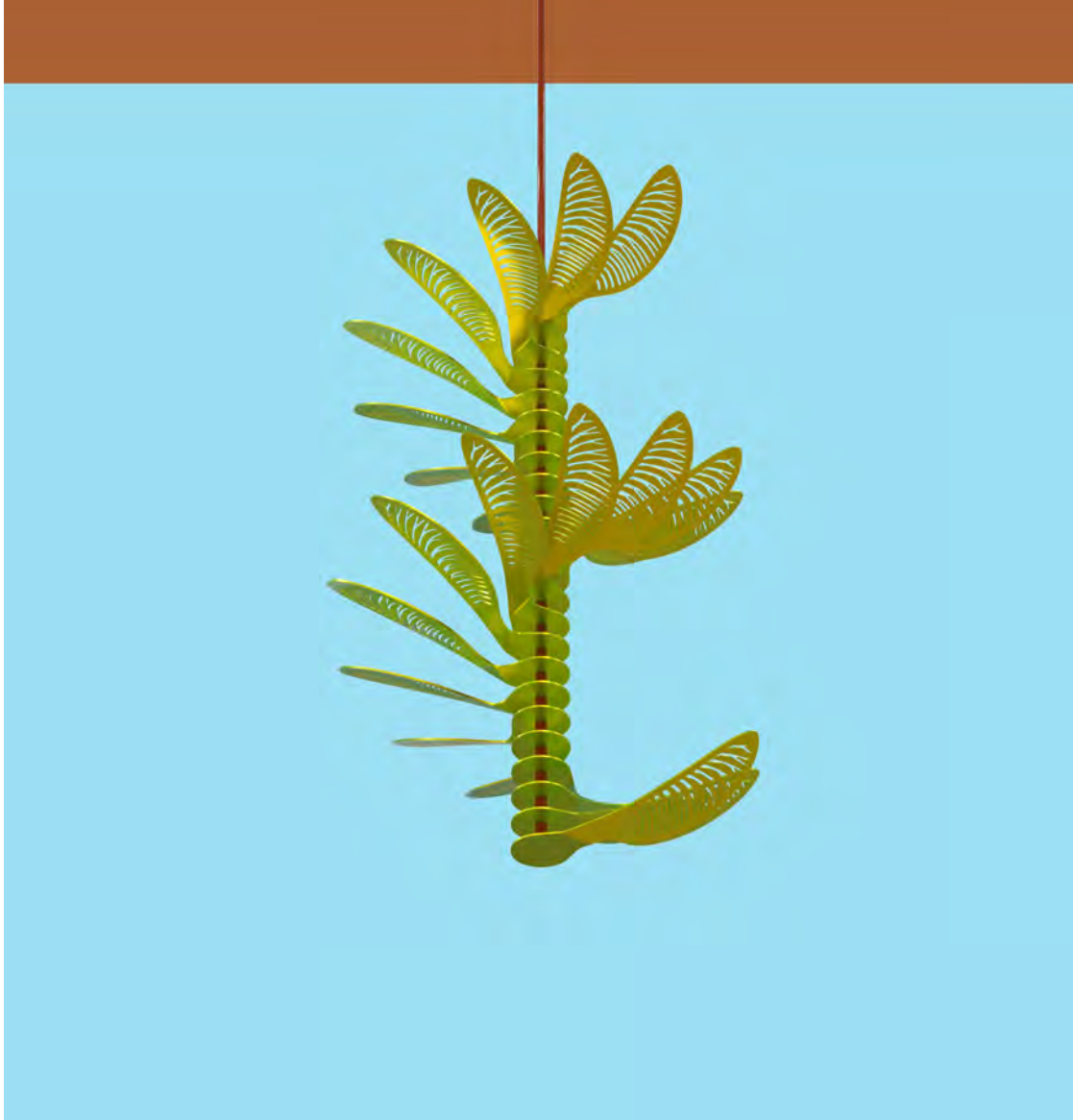

Aluminum sculpture finished with color-shifting exterior grade polyurethane chromatic finish.

