

COLD WEATHER SHELTER PROGRAM—North County**November 30, 2015 to March 31, 2016****PARTICIPANT ELIGIBILITY**

Individuals/households are eligible to participate in this program if they meet the following criteria:

- Literally homeless: Living in places not meant for human habitation: cars, parks, sidewalks, and abandoned buildings.
- Claim residency (where one stays the most time or one's last permanent residence) in one of the following jurisdictions/areas: Cupertino, Los Altos, Los Altos Hills, Milpitas, Mountain View, Palo Alto, or Sunnyvale. If occupancy permits, residents from other areas in the County can be accepted.

AGENCIES PARTICIPATING IN THIS PROGRAM

- Downtown Streets Team (outreach and referrals)
- Emergency Assistance Network Agencies (Community Services Agency: Mountain View, Opportunity Center, Sunnyvale Community Services, West Valley Community Services: referrals)
- HomeFirst Services of Santa Clara County (outreach, and shelter services)
- InnVision Shelter Network (shelter and case management services)
- Project We Hope (shelter and case management services)
- Valley Health Care for the Homeless (outreach and medical services)

OUTREACH

- Valley Health Care for the Homeless conducts outreach all throughout the County daily from 5:00 p.m. to 8:00 p.m. during November weekdays and during proclaimed inclement weather days.
- HomeFirst conducts outreach in the north County during the work week.
- Downtown Streets Team conducts outreach twice a week in Palo Alto and once a week in Sunnyvale.

REFERRAL PROCESS

1. Individuals/households meeting the eligibility criteria can be referred by:
 - The above participating agencies doing outreach, providing shelter or case management services; or
 - Any of the Emergency Assistance Network agencies; or
 - Any city housing or public safety departments in the County of Santa Clara.

Please note that all referring entities will use the appropriate referral form designed for this program. When persons are referred, they will know if a bed is available or if they will be put on a waitlist. At least 50% of beds will be reserved; the rest will be filled on a first-come/first-served basis.

2. The referring agency will fill out the referral form and email/fax it to the shelter.
3. Referred clients will be able to stay at the shelter for the whole CWSP period.
4. If a referred client does not show up by 7:00 p.m. on a given day, the bed that was to be occupied is declared "open."
5. Public Safety and Emergency Medical Services can refer individuals and bring them to the site.
6. When referred individuals are confirmed by HomeFirst staff, they will be allowed to enter the shelter. Non-referred clientele will have to wait to see if there are beds available that evening.

SHELTER BEDS FOR INDIVIDUALS

Shelter services will be provided as follows:

- County shelter (212 N. Fair Oaks Ave., Sunnyvale): single adults/families.....100 beds for 120 days
- Hotel de Zink (rotating churches in Palo Alto): single adults5 beds for 120 days
- Project WeHOPE (1858 Bay Rd., East Palo Alto): single adults10 beds for 120 days

TRANSPORTATION SERVICES

- Project WeHOPE will provide transportation to County shelters or the Opportunity Center.
- Transportation available from outreach providers according to the hours of operation while conducting outreach.

INCLEMENT WEATHER

When the Office of Emergency Services (in collaboration with the State Weather Service) declares an "inclement weather" episode, notice is communicated via the media, outreach is done by Valley Health Care for the Homeless and other agencies/volunteers, emergency shelter beds are expanded as necessary and supplies are delivered.

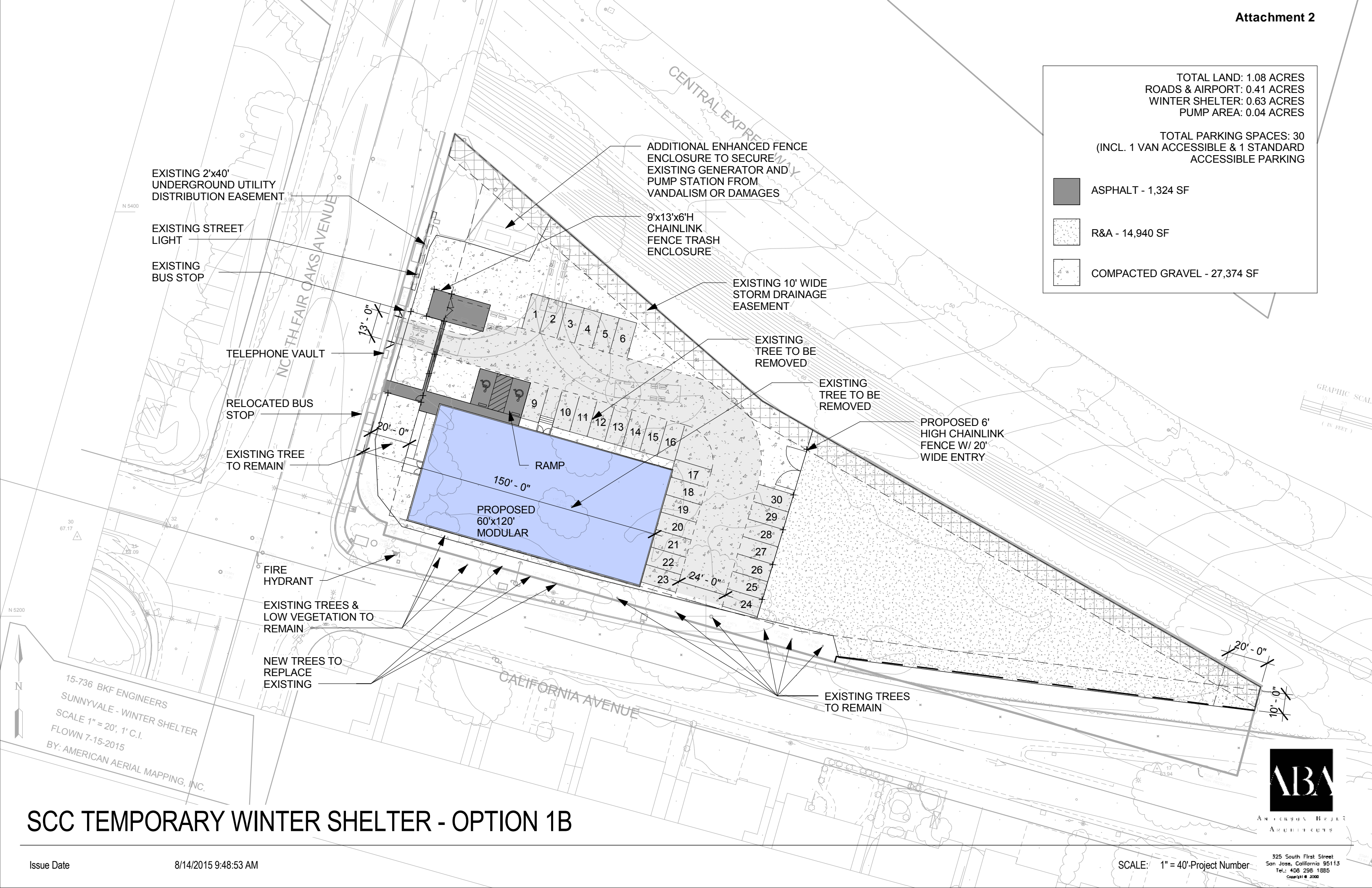

TOTAL LAND: 1.08 ACRES
ROADS & AIRPORT: 0.41 ACRES
WINTER SHELTER: 0.63 ACRES
PUMP AREA: 0.04 ACRES

TOTAL PARKING SPACES: 30
(INCL. 1 VAN ACCESSIBLE & 1 STANDARD ACCESSIBLE PARKING)

- ASPHALT - 1,324 SF
- R&A - 14,940 SF
- COMPACTED GRAVEL - 27,374 SF



15-736 BKF ENGINEERS
SUNNYVALE - WINTER SHELTER
SCALE 1" = 20', 1" C.I.
FLOWN 7-15-2015
BY: AMERICAN AERIAL MAPPING, INC.

SCC TEMPORARY WINTER SHELTER - OPTION 1B

TEMPORARY COLD WEATHER SHELTER SCHEDULE AS OF Fri 8/14/15 AT 2:37 PM

| ID | Task Mode | Task Name | Duration | Start | Finish | Predecessors | 3rd Quarter | | | | 4th Quarter | | |
|----|-----------|---|----------------|---------------------|---------------------|------------------|-------------|-----|-----|-----|-------------|-----|-----|
| | | | | | | | Jun | Jul | Aug | Sep | Oct | Nov | Dec |
| 1 | | TEMPORARY COLD WEATHER SHELTER | | | | | | | | | | | |
| 2 | | MODULARS | 80 days | Wed 7/22/15 | Tue 11/10/15 | | | | | | | | |
| 3 | | FLOOR PLAN | 5 days | Wed 7/22/15 | Tue 7/28/15 | | | | | | | | |
| 4 | | REQUEST FOR PROPOSAL | 6 days | Wed 7/29/15 | Wed 8/5/15 | 3 | | | | | | | |
| 5 | | RECEIVE PROPOSAL | 8 days | Thu 8/6/15 | Mon 8/17/15 | 4 | | | | | | | |
| 6 | | AWARD MODULAR CONTRACT | 1 day | Tue 8/18/15 | Tue 8/18/15 | 5 | | | | | | | |
| 7 | | DELIVERY TO SITE | 55 days | Wed 8/19/15 | Tue 11/3/15 | 6 | | | | | | | |
| 8 | | INSTALL AND UTILITY CONNECTIONS | 5 days | Wed 11/4/15 | Tue 11/10/15 | 7,15,22,23,24,25 | | | | | | | |
| 9 | | SITE PREPARATION | 66 days | Wed 7/22/15 | Wed 10/21/15 | | | | | | | | |
| 10 | | SITE SCOPE OF WORK | 18 days | Wed 7/22/15 | Fri 8/14/15 | | | | | | | | |
| 11 | | SITE CONSTRUCTION DOCUMENTS | 5 days | Mon 8/17/15 | Fri 8/21/15 | 10 | | | | | | | |
| 12 | | REQUEST FOR PROPOSAL - JOB ORDER CONTRACTOR | 1 day | Mon 8/17/15 | Mon 8/17/15 | 10 | | | | | | | |
| 13 | | RECEIVE PROPOSAL | 6 days | Tue 8/18/15 | Tue 8/25/15 | 12 | | | | | | | |
| 14 | | AWARD AND NTP | 2 days | Wed 8/26/15 | Thu 8/27/15 | 13 | | | | | | | |
| 15 | | CONSTRUCTION - SITE WORK | 30 days | Thu 9/10/15 | Wed 10/21/15 | 14,18 | | | | | | | |
| 16 | | PERMITS | 63 days | Mon 8/24/15 | Wed 11/18/15 | | | | | | | | |
| 17 | | BUILDING PLANNING - PLAN CHECK | 3 days | Mon 8/24/15 | Wed 8/26/15 | 11 | | | | | | | |
| 18 | | FIRE MARSHAL - PLAN CHECK | 10 days | Thu 8/27/15 | Wed 9/9/15 | 17 | | | | | | | |
| 19 | | FIRE MARSHAL - SITE INSPECTION | 5 days | Wed 11/11/15 | Tue 11/17/15 | 8 | | | | | | | |
| 20 | | CITY OF SUNNYVALE - ENCROACHMENT PERMIT | 63 days | Mon 8/24/15 | Wed 11/18/15 | 11 | | | | | | | |
| 21 | | UTILITIES | 58 days | Wed 7/29/15 | Fri 10/16/15 | | | | | | | | |
| 22 | | PG&E | 40 days | Mon 8/24/15 | Fri 10/16/15 | 11 | | | | | | | |
| 23 | | WATER - SUNNYVALE | 40 days | Mon 8/24/15 | Fri 10/16/15 | 11 | | | | | | | |
| 24 | | SANITARY SEWER - SUNNYVALE | 40 days | Mon 8/24/15 | Fri 10/16/15 | 11 | | | | | | | |
| 25 | | AT&T PHONE | 20 days | Wed 7/29/15 | Tue 8/25/15 | 3 | | | | | | | |
| 26 | | MOVE IN | 2 days | Thu 11/19/15 | Fri 11/20/15 | 19,20 | | | | | | | |
| 27 | | | | | | | | | | | | | |