



CWSP FY17—North County Update

1

Robert A. Dolci, M.A.
Office of Supportive Housing

August 9, 2016

Location



Outreach to the Local Community

Mailing to Neighboring Businesses/Homeowners/Residents

- Collaboration with City: over 2,500 addresses: invitation to two community meetings and the Board of Supervisors meeting
- Local businesses: flyers delivered

Community Meetings: June 13th

- 41 attendees (including 2 City Council members)
- Program and preparatory work needed explained
- Concerns expressed and addressed

Community Program Planning Meeting: July 13th

- Operational, Good Neighbor, Security Transportation Plans introduced/revised
- Monthly meetings scheduled

999 Hamlin Court Site: Interior Plan

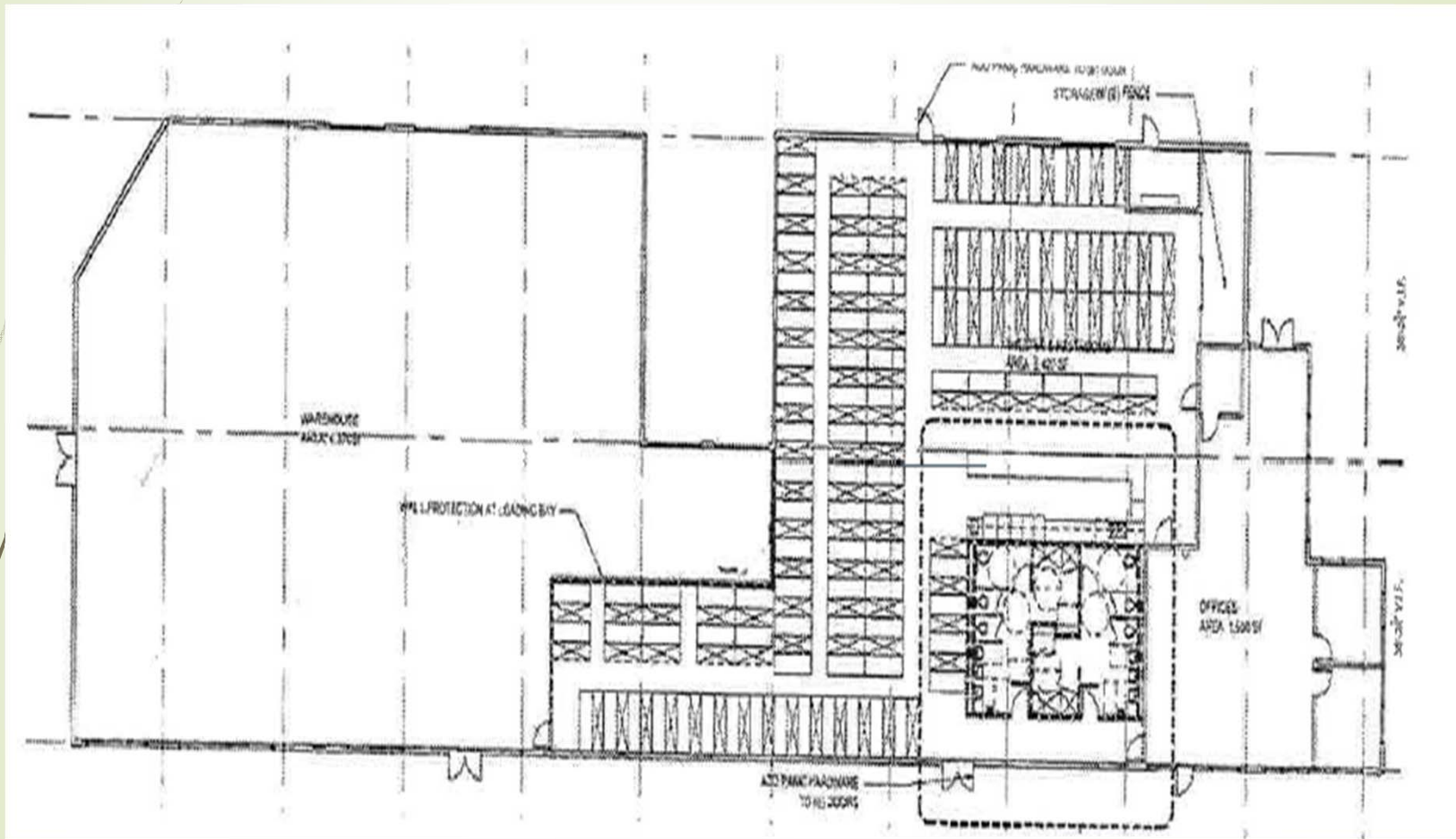

Site Preparations

- Modular Building: will not be used;
- Design work is completed and has been submitted to County Building Dept. for permits; will include:
 - Capacity for serving 125 people (not to be expanded during Inclement Weather Episodes)
 - New bathrooms, showers, HVAC system, additional windows
 - Washers and dryers, bicycle rack, storage for clients' things
 - Designated smoking area
- Work to begin September 1st and be completed by November 15th.

Responses to Issues/Concerns

- ▶ Street lighting: City trimmed trees and all existing lighting is up to code
- ▶ Lack of sidewalks: Service Provider will provide shuttle service to/from nearest bus stop on Mathilda and other sites used by the clientele.
- ▶ County contracting with Sandis Civil Engineers to study sidewalks & lighting issues.
- ▶ Parking: With the removal of the modular building, there will be adequate parking on site.

Responses to Issues/Concerns (con't.)

- ▶ Client disruption of local businesses: Under the direction of the County, the local businesses and the service provider are developing a plan to address all security issues. Parts of the response:
 - ▶ 24/7 call number and regular communication/meetings
 - ▶ Outreach workers to ensure all issues are communicated & disruption minimized.
- ▶ Program approaches of FY16 to continue:
 - ▶ Shuttle service
 - ▶ Security 24/7
 - ▶ Referral system

REPORTED DEATHS: HOMELESS/TRANSIENT INDIVIDUALS

Period: December 1st to March 30th

Reported Deaths	13-14	14-15	15-16	Grand	%
Natural	11	8	19	38	38%
Accident	11	12	8	31	31%
Undetermined	1	2	17	20	20%
Suicide	1	2	2	5	5%
Hypothermia	1	1	2	4	4%
Homicide	1		2	3	3%
Total	26	25	50	101	100%

Cold Weather Shelter Period

13/14 CWSP from 1/4/14 to 03/31/14

14/15 CWSP from 11/29/14 to 03/25/15

15/16 CWSP from 12/1/15 to 03/31/16

The Manner & Causes of Death Include:

Accidents: Drug/alcohol overdose, fractures, falls, car crashes, burns, etc.

Homicide: Blunt force trauma, physical altercation, etc.

Natural Causes: Strokes, infections, COPD, renal failure, alcoholism, heart attack, etc.

Suicide: Self-inflicted/caused wounds, asphyxia, collisions, overdose, etc.

Undetermined/Pending: Multiple issues, manner has not been resolved.

Hypothermia: Exposure to cold environmental temperatures