



# City of Sunnyvale

## Notice and Agenda Arts Commission

---

Wednesday, March 18, 2020

7:00 PM

Laurel Room - Senior Center, Sunnyvale  
Community Center, 550 E. Remington Dr.,  
Sunnyvale, CA 94087

---

### **CALL TO ORDER**

### **SALUTE TO THE FLAG**

### **ROLL CALL**

### **PRESENTATION**

[20-0287](#) PRESENTATION - Study Issues Overview

[20-0289](#) PRESENTATION - Hands on the Arts

### **ORAL COMMUNICATIONS**

*This category provides an opportunity for members of the public to address the commission on items not listed on the agenda and is limited to 15 minutes (may be extended or continued after the public hearings/general business section of the agenda at the discretion of the Chair) with a maximum of up to three minutes per speaker. Please note the Brown Act (Open Meeting Law) does not allow commissioners to take action on an item not listed on the agenda. If you wish to address the commission, please complete a speaker card and give it to the Recording Secretary. Individuals are limited to one appearance during this section.*

### **CONSENT CALENDAR**

- 1.a [20-0290](#) Approve the Arts Commission Meeting Minutes of January 15, 2020

**Recommendation:** Approve the Arts Commission Minutes of January 15, 2020 as submitted.

### **PUBLIC HEARINGS/GENERAL BUSINESS**

- 2      [20-0349](#)      Approve Art in Private Development Project - Hunter Properties/CityLine: Double Drip (Phase 1, Artwork 2 of 2)

**Recommendation:** Alternative 2: Recommend approval of the artwork as it is proposed with the following condition of approval: Require the developer to submit a landscape plan prior to installation of the art to the City's Visual Arts Coordinator.

Staff concludes that the proposal adequately meets the criteria of the Art in Private Development requirement. However, the landscape plan is not finalized so the art proposal has been reviewed without considering nearby landscaping and tree locations.

**STANDING ITEM: CONSIDERATION OF POTENTIAL STUDY ISSUES**

[20-0292](#)      Arts Commission Proposed Study Issues, Calendar Year: 2021

**NON-AGENDA ITEMS & COMMENTS**

-Commissioner Comments

-Staff Comments

**ADJOURNMENT***Notice to the Public:*

*Any agenda related writings or documents distributed to members of this meeting body regarding any item on this agenda will be made available for public inspection in the originating department or can be accessed through the Office of the City Clerk located at 603 All America Way, Sunnyvale, CA. during normal business hours and at the meeting location on the evening of the commission meeting, pursuant to Government Code §54957.5.*

*Agenda information is available by contacting Community Services Administration at (408) 730-7336. Agendas and associated reports are also available on the City's website at [sunnyvale.ca.gov](http://sunnyvale.ca.gov) or at the Sunnyvale Public Library, 665 W. Olive Ave., Sunnyvale, 72 hours before the meeting.*

*Pursuant to the Americans with Disabilities Act, if you need special assistance in this meeting, please contact Community Services Administration at (408) 730-7336. Notification of 48 hours prior to the meeting will enable the City to make reasonable arrangements to ensure accessibility to this meeting. (28 CFR 35.160 (b) (1))*







# City of Sunnyvale

## Agenda Item

---

**20-0287**

**Agenda Date: 3/18/2020**

---

PRESENTATION - Study Issues Overview



# City of Sunnyvale

## Agenda Item

---

**20-0289**

**Agenda Date:** 3/18/2020

---

PRESENTATION - Hands on the Arts



# City of Sunnyvale

## Agenda Item

---

**20-0290**

**Agenda Date:** 3/18/2020

---

**SUBJECT**

Approve the Arts Commission Meeting Minutes of January 15, 2020

**RECOMMENDATION**

Approve the Arts Commission Minutes of January 15, 2020 as submitted.





# City of Sunnyvale

## Meeting Minutes - Draft Arts Commission

---

Wednesday, January 15, 2020

6:00 PM

Laurel Room - Senior Center, Sunnyvale  
Community Center, 550 E. Remington Dr.,  
Sunnyvale, CA 94087

---

### Special Meeting

#### **CALL TO ORDER**

Vice Chair Eskridge called the meeting to order at 6:10 p.m. in the Laurel Room at the Sunnyvale Senior Center.

#### **SALUTE TO THE FLAG**

Vice Chair Eskridge led the salute to the flag.

#### **ROLL CALL**

**Present:** 4 - Vice Chair Dawna Eskridge  
Commissioner Jeremie Gluckman  
Commissioner Sue Serrone  
Commissioner Agnes Veith  
**Absent:** 1 - Chair Susannah Vaughan

Chair Vaughan's absence is excused.

Council Liaison Smith present

City Staff present:

Damon Sparacino, Superintendent of Community Services  
Trenton Hill, Community Services Manager  
Kristin Dance, Community Services Coordinator  
Jackie Davison, Administrative Aide

#### **ORAL COMMUNICATIONS**

None.

#### **CONSENT CALENDAR**

Commissioner Serrone moved and Commissioner Gluckman seconded the motion to approve the Arts Commission Meeting Minutes of November 20, 2019 as submitted. The motion carried by the following vote

**Yes:** 4 - Vice Chair Eskridge  
Commissioner Gluckman  
Commissioner Serrone  
Commissioner Veith

**No:** 0

**Absent:** 1 - Chair Vaughan

**1.a**     [20-0082](#)     Approve the Arts Commission Meeting Minutes of November 20, 2019  
Approve the Arts Commission Minutes of November 20, 2019 as submitted.

### **PUBLIC HEARINGS/GENERAL BUSINESS**

**2**        [20-0182](#)     Approve Art in Private Development Project - Hunter Properties/CityLine  
Community Services Coordinator, Kristin Dance, gave an overview of the piece and noted that it met code requirements. She also reminded the commission that they heard this presentation in November.

Ms. Dance, introduced Deke Hunter, President of Hunter Properties. Mr Hunter, presented to the commissioners on the project. Highlights from the presentation include: Sketches of work, artwork location and views from various areas, concept diagram, sun studies, artist statement, colors, materials and assembly, seating, night lighting and maintenance.

Commissioners inquired and Mr. Hunter or staff responded:

- Do the blue and yellow overlap and cause a mixing of colors? You'll get some shadowing and a mix of light in about 25% of the pieces.
- Can you clarify the information related to landscaping in the recommendation. We want to make sure to review the landscape plan to assure the piece is not being blocked.
- Will the street where the artwork is remain open or closed. All streets to stay open.
- Are there spot lights at night? There will be uplighting at night to highlight the piece.

Vice Chair Eskridge open it up for Public Comments. Being none, it was closed.

Vice Chair Eskridge asked if there was a motion.

Commissioner Veith moved and Commissioner Gluckman seconded the motion to recommend approval of the artwork as it is proposed and require the developer to submit a landscape plan to the Visual Arts Coordinator prior to the installation of the art. The motion carried by the following vote:

**Yes:** 4 - Vice Chair Eskridge  
Commissioner Gluckman  
Commissioner Serrone  
Commissioner Veith

**No:** 0

**Absent:** 1 - Chair Vaughan

**3**      [20-0176](#)      Review and Recommendation of Public Art - Washington Community Swim Center

Community Services Coordinator, Kristin Dance provided an overview of the process. Ms. Dance reminded commissioners that what they were seeing were concepts only and that after the presentations, the commission would rank the proposals. Ms. Dance then introduced the first speaker, Denise Hart.

Ms. Hart spoke on her proposed glass mosaic mural. Presentation highlights included: design concept, images of proposed mural, community involvement aspects, maintenance and samples of past work.

Commissioners inquired and Ms. Hart or staff responded:

- Is what you are showing to scale? No, the piece will be 18-feet tall.
- How big will illustrations in piece be, could you see it from street? You would be able to see waves and different blues, but may not be able to make out all sea creatures. They could be adjusted in size.
- Can the community be involved in design? I am happy to do that.
- Is this the only piece you are proposing? Yes.

Ms. Dance, then introduced the second speaker, Solomon Bassoff of Faducci.

Mr. Bassoff spoke on Faducci's proposed sculptures and mosaic panels. Presentation highlights included: design concept, images of proposed pieces, community involvement aspects, maintenance and samples of past work.

Commissioners inquired and Mr. Bassoff or staff responded:

- Can you explain the creation process? Mr. Bassoff explained the process for making the sculptures.
- Can you interact with the creatures? Yes, they were made to be climbed on.
- Could the octopus have flippers? Yes, that is a great idea. We could also ask people what types of shoes they'd like to see.
- How are the panels created? Mr. Bassoff explained the process for making the panels.
- Will the panels have a more cartoony feel as well? Yes, they will have personality.

Ms. Dance, then introduced the third speaker, Archie Held.

Mr. Held spoke on his proposed abstract forms. Presentation highlights included: design concept, images of proposed pieces, community involvement aspects, maintenance and samples of past work.

Commissioners inquired and Mr. Held or staff responded:

- How tall are the panels? The panels are approximately 4-feet tall and 3-feet wide.
- What is the fence that the panels will be on made of? Ms Dance replied that the fence is made of iron railings with spacing in-between.
- Do you think children will try to climb the pieces? They could however it would be difficult due to the material they are made of.
- Is there a way to add texture or color to the piece? The piece is meant to be smooth. I have no objective of adding color.
- Is there a way to rooting us in place (more directly related to Sunnyvale) in the piece? That could be done in the panels(s).
- Will there be lighting? Yes, there will be in-ground lights that uplight the piece at night.

Ms. Dance, then introduced the fourth speaker, Adrian Litman.

Mr. Litman spoke on his proposed stainless steel wall mural and kinetic sculpture. Presentation highlights included: design concept, images of proposed pieces, materials, and samples of past work.

Commissioners inquired and Mr. Held or staff responded:

- What is the circumference at top? Approximately 12-feet in diameter.
- How is the piece made? Mr. Held explained the design process.
- Is the mural in a frame? Yes.



- Are there different layers of the mural? Yes.
- How big is the piece? Wall mural is approximately 15 x 18-feet.
- Will the person who designed the building object to this being placed on the building? Ms. Dance informed the commissioners that the architect was on the panel that chose the artists.
- Can kids get their hand in-between the mural layers. This can be addressed. The ones lower to the ground could be closer together so that kids could not get their hands in between.
- Is it windy enough for the kinetic piece? The piece will move at 3 mph.
- Will there be lighting? That is a consideration. It would depend on how budget could accommodate. We could look into lighting.
- What about just lighting the panel? Yes, that is easier.

Ms. Dance informed the commission that that concluded the presentations for the Washington Community Swim Center.

Vice Chair Eskridge asked if there were any Public Comments. Being none, they moved forward.

Commissioners ranked the proposed pieces.

The Commission ranked the four proposed pieces for the Washington Community Swim Center in the following order:

1. Denise Hart
2. Faducci
3. Adrian Litman
4. Archie Held

Vice Chair Eskridge moved, and Commissioner Gluckman seconded, the motion to approve the ranking of the proposed pieces for the Washington Community Swim Center. The motion carried by the following vote:

**Yes:** 4 - Vice Chair Eskridge  
Commissioner Gluckman  
Commissioner Serrone  
Commissioner Veith

**No:** 0

**Absent:** 1 - Chair Vaughan

**4**      [20-0177](#)      Review and Recommendation of Public Art - Fair Oaks Park Renovation

Community Services Coordinator, Kristin Dance provided an overview of the park and proposed locations for public art. Ms. Dance reminded commissioners that what they were seeing were concepts only and that after the presentations, the commission would rank the proposals. Ms. Dance then introduced the first speaker, Solomon Bassoff of Faducci.

Mr. Bassoff spoke on Faducci's proposed pieces. Presentation highlights included: design concept, images of proposed pieces, and community involvement aspects.

Commissioners inquired and Mr. Bassoff or staff responded:

- How big is the dog? Six-feet, six-inches tall and six-feet wide.
- Why medieval theme? That is the theme of the park.
- Is it possible to design the figures for individuals that may not be able to climb onto the foot holds? We could possibly do a ramp.
- Will there be lighting? Ms. Dance informed the commission that lighting is a requirement.

Ms. Dance introduced the second speaker, Archie Held.

Mr. Held spoke on his castle structure. Presentation highlights included: design concept, images of proposed pieces, and community involvement aspects.

Commissioners inquired and Mr. Held or staff responded:

- How big are the windows? Could youth fall through? The structure is sealed at the top and at the windows.
- It is easily maintained? Yes, it is powder-coated.

Ms. Dance introduced the third speaker, Cork Marcheschi.

Mr. Marcheschi spoke on his proposed abstract sculptures. Presentation highlights included: design concept, images of proposed pieces, materials, and samples of past work.

Commissioners inquired and Mr. Marcheschi or staff responded:

- Will all the items be out front of the park? Yes
- Maintenance on lights? I can guarantee 15 years life from any LED light we use.
- Are the colors you showed, the colors you will use? Not planning much, we could discuss colors.

- Are the lights solar powered? The lights are electrical and will run at 125 watts per pole.
- Are there any movable parts? Only when being assembled.
- Are there three pieces? Ms. Dance informed the commissioners that Cork's vision was to have three, however only two are guaranteed.
- Could two be done out front and then a smaller one at the dog park? Yes, that is possible.

Ms. Dance introduced the fourth speaker, James Moore.

Mr. Moore spoke on his proposed sculptures. Presentation highlights included: importance of public art, design concept, images of proposed pieces, materials, and samples of past work.

Commissioners inquired and Mr. Moore or staff responded:

- What is the connection to the Old English Theme? The nod to Old English is in the finish of the pieces.
- The sculptures show playing certain sports. Are these sports played at Fair Oaks? Ms. Dance replied, yes.
- First park with cricket, could we include that? These are conceptual pieces. Yes, we could take that into consideration.
- Do we have to connect to the theme? Ms. Dance replied that was up to the commission and what they wanted to see in the park.

Ms. Dance informed the commission that the fifth speaker, Vickie Jo Sowell was not there. Community Services Manager, Trenton Hill read the description of Ms. Sowell's sculpture.

Commissioners inquired and staff responded:

- Is it to scale in image? I believe so.
- Who maintains the site for the URL or QR code? That would need to be looked into. As a general rule, the City does not promote other webpages.
- What are the materials? Stainless steel and patinaed with antique silver and black finish.

Vice Chair Eskridge asked if there were any other questions.

With no additional questions, Ms. Dance stated that that concluded the presentations for Fair Oaks Park.

Vice Chair Eskridge asked if there were any Public Comments. Being none, they moved forward.

Commissioners ranked the proposed pieces.

The Commission ranked the five proposed pieces for Fair Oaks Park in the following order:

1. James Moore
2. Cork Marcheschi
3. Vickie Jo Sowell
4. Archie Held
5. Faducci

Commissioner Gluckman made a motion that the preferred art include all sports at Fair Oaks Parks. Vice Chair Eskridge seconded the motion. Commissioner Serrone suggested a friendly amendment, that the sculptures remain more abstract to depict a mix of sport options available at Fair Oaks Parks. Commissioner Gluckman accepted the friendly amendment and Vice Chair Eskridge seconded. The motion carried by the following vote:

**Yes: 4 -** Vice Chair Eskridge  
Commissioner Gluckman  
Commissioner Serrone  
Commissioner Veith

**No: 0**

**Absent: 1 -** Chair Vaughan

**5**      [20-0083](#)      Rank 2020 Study Issues

Vice Chair Eskridge asked if anyone had any questions of staff on the proposed study issue. There were none.

Vice Chair Eskridge if there was a motion to defer or drop the Study Issue. With there being none, she asked if commissioners had any other questions.

Commissioners inquired and staff responded:

- If study issue is possibly going to be in another area, should it be moved forward?

Superintendent of Community Services, Damon Sparacino explained the process. Mr. Sparacino noted that by moving it forward, it would be considered on its own merits.

- Would this study issue apply to developers as well? No, we don't have pervue in that area.

Vice Chair Eskridge moved and Commissioner Serrone seconded the motion, to promote the study issue to Council. The motion carried by the following vote:

**Yes:** 4 - Vice Chair Eskridge  
Commissioner Gluckman  
Commissioner Serrone  
Commissioner Veith

**No:** 0

**Absent:** 1 - Chair Vaughan

#### **STANDING ITEM: CONSIDERATION OF POTENTIAL STUDY ISSUES**

[20-0084](#)

Arts Commission Proposed Study Issues, Calendar Year: 2021

Standing item. No action taken.

#### **NON-AGENDA ITEMS & COMMENTS**

##### **-Commissioner Comments**

Commissioner Serrone shared the adult and youth bags from the Library Art Contest.

##### **-Staff Comments**

Superintendent of Community Services, Damon Sparacino and Community Services Manager, Trenton Hill shared that the February Arts Commission meeting may be canceled and to bring any potential commission art project ideas for Hands on the Arts to the March meeting.

Commissioner Serrone asked about the Gallery. Mr. Hill noted that financial resources have not yet ben allocated for it and that we will keep the commission informed.

Superintendent Sparacino informed commissioners that there would be a Study Session for the Master Plan for Public Art on March 17.

Commissioner Serrone asked when the commission would see the proposed plan. Mr. Hill let her know that it would be in the meeting agenda packet for March 17, 2020.

### **INFORMATION ONLY REPORTS/ITEMS**

[20-0203](#)      2020 Master Work Plan

Superintendent Sparacino handed out the final 2020 Master Work Plan.

### **ADJOURNMENT**

Vice Chair Eskridge adjourned the meeting at 9:19 p.m.



# City of Sunnyvale

## Agenda Item

---

20-0349

Agenda Date: 3/18/2020

---

### REPORT TO ARTS COMMISSION

#### SUBJECT

Approve Art in Private Development Project - Hunter Properties/CityLine: *Double Drip* (Phase 1, Artwork 2 of 2)

#### BACKGROUND

Under the City's Art in Private Development Ordinance (Sunnyvale Municipal Code (SMC) Chapter 19.52), the CityLine development in downtown Sunnyvale is required to provide public art. The public art component must be equal in value to 1% of the building permit valuation. The artwork will be commissioned and installed in two phases.

Phase 1 will include two large scale sculptures. The first sculpture, *1000 Suns* by Future Forms, was reviewed by the Arts Commission on Jan. 15, 2020, and was approved by the City Council on Feb. 25, 2020. The second sculpture is being presented in this report. The combined minimum artwork expenditure for Phase 1 of the project has been established as \$451,381.

The procedure established for reviewing the artwork is:

- 1) Review the artist's background, including their experience and ability to design, fabricate and install large-scale artwork;
- 2) Review the artwork to determine whether the nature and style of the artwork is appropriate to the site;
- 3) Determine whether the proposed artwork is appropriate in scale for the overall development; and
- 4) Review the location of the artwork for accessibility to the public.

This report provides information for the Arts Commission review and recommendation to City Council to approve the second piece of proposed artwork for Phase 1 of the CityLine project. The artwork for Phase 2 will be reviewed at a future date.

Although the Arts Commission usually has final approval for Art in Private Development projects, due to the high visibility of this development the conditions of approval state: "Upon approval by the Arts Commission the plan shall be forwarded for review and approval by the City Council." The Arts Commission's recommendation will be considered by the City Council for final approval at an upcoming Council meeting.

#### EXISTING POLICY

Sunnyvale Municipal Code 19.52 - Art in Private Development

#### ENVIRONMENTAL REVIEW

In 2016 (RTC No. 16-0458), the Planning Commission approved a special development permit to amend the Final Conditions of Approval for the Sunnyvale Town Center project. Required public art was included in those amended conditions of approval. The approved amendments to the Special Development Permit Final Conditions of Approval, including the public art requirement, were determined to be within the scope of the previous environmental analysis for the Downtown Program Improvement Update in accordance with the California Environmental Quality Act (CEQA) Guidelines Section 15168(c)(2). Subsequent environmental review is not required as none of the exceptions to the exemptions specified in CEQA Guidelines Section 15300.2 had occurred, and the amended conditions were deemed categorically exempt from CEQA pursuant to CEQA Guidelines Sections 15304 and 15305.

## **DISCUSSION**

**Project Location:** In 2007, the City Council approved a master land use and site development plan for the CityLine project (previously referred to as “Sunnyvale Town Center”). The site covers six blocks located between South Mathilda, South Sunnyvale, West Washington and West Iowa Avenues (Attachment 1 - Vicinity Map).

**Project Description:** The development includes a mixture of retail, commercial, office and residential apartment units. The project will retain the Target store, Nokia and Apple office spaces and the existing Redwood Square along McKinley Avenue. The former Macy’s building will be demolished in a future phase (Attachment 2 - Site Plan).

A two-story commercial building will be occupied by Whole Foods on the ground floor and AMC Theaters on the second floor with a public parking garage immediately adjacent on the southwest corner of McKinley and Sunnyvale avenues. This part of the project is slated to open in early 2020.

**Artwork Location:** Hunter Properties is curating a “dynamic installation of public art that invigorates communal spaces and provides a link between the past, present and future of Downtown Sunnyvale...by engaging avant-garde contemporary artists whose work addresses methodologies and ideas of our time.”

The artwork is being developed, approved and installed in two phases. Phase 1 addresses the McKinley Avenue corridor, which runs through the center of the development. Phase 2 locations and proposals are still being developed.

Phase 1 artwork includes two locations (Attachment 3 - Site Plan with Art Locations):

- 1) *1000 Suns* by Future Forms (previously approved), will be installed in the median along McKinley Avenue between Taaffe and Mathilda avenues (Attachment 4 - *1000 Suns* by Future Forms)
- 2) *Double Drip* by Woody de Othello, the artwork presented for approval in the report, will be located on the Northeast corner of Murphy and McKinley avenues, directly across from the Whole Foods and AMC Theaters.

**Selected Artist:** The selected artist for the *Double Drip* location is Oakland-based sculptor Woody De Othello (Attachment 5 - Artist Resume). Mr. De Othello has been actively exhibiting his ceramic sculptures in gallery and museum settings since 2012. He recently completed three large scale sculptures for an outside terrace at San Francisco International Airport, Boarding Area G, in addition to a recent installation for Art Basel Miami Beach, Florida.



Currently, he is exhibiting at the San Jose Museum of Art thru April 5, 2020. More information and images for the artist can be found at [woodyothello.com](http://woodyothello.com).

**Artwork Proposal:** The artwork selected for the Murphy/McKinley intersection is a large scale, bronze sculpture entitled *Double Drip* (Attachment 6 - Elevation Rendering). The design incorporates the artist's signature style of mutating everyday recognizable objects to address the tension between animate and inanimate, energy and exhaustion, and hospitality and hostility.

*Double Drip* incorporates the form of a faucet, inspired by a sink in the artist's apartment that has separate faucet spigots for hot and cold water. The artist was intrigued by this separation, which he understood as analogous to polarized moods or temperaments that offer no possibility for meeting in the middle and producing "warm" water. This observation was a launching point for a more complex discussion on the importance of water as a resource.

In *Double Drip*, the "hot" and "cold" faucets are playfully merged into a single, stacked, double-headed faucet that leans against another faucet, which has been tied into a knot (Attachment 7 - Artist Sketches and Attachment 8 - Ceramic Models). The artist states: "This piece connects broader environmental concerns about water to a personal, domestic, or everyday state. The double-headed faucet brings up ideas of water as it related to abundance or consumption, something integral to our everyday experience. In contrast, the knotted-up faucet speaks to issues of scarcity or conservation. Using this recognizable object, I hope people can relate personally with the scale of the importance of the resource, and that one will stop and question and reflect upon their own relationship to it."

The sculpture will be 10 feet tall and sit atop a 1 to 2 feet tall pedestal (Attachment 9 - Elevation Rendering Showing Scale). To create this large-scale piece, the artist will hand-build a smaller ceramic model, pushing the form to a point where it nearly collapses. This "state of precariousness" adds psychological weight and creates a sense of movement and emotion. The model will then be 3D scanned. The scans will be used to create the large-scale mold into which bronze will be poured to form the piece. The sculpture will be stabilized by metal rods inserted into the mold.

The sculpture will be treated with a blue patina and sealed with a wax for easy cleaning. Overall, the piece will be a matte finish, not shiny like the glazed clay model (Attachment 10 - Patina Example). The exception to this will be the faucet knobs, which will be powder coated to have a slightly shinier finish.

**Lighting Plan:** The sculpture will be washed in ground light where possible and spot-lit from three in-ground light poles encircling the sculpture (Attachment 11 - Lighting Proposal). There will also be ambient light from the surrounding buildings and streets.

**Maintenance:** Patinaed bronze is durable and long-lasting, which resists vandalism and graffiti. It requires a biannual cleaning, waxing and buffing, unless vandalized. Graffiti and scratches to the bronze will only require a sanding and new coat of patina. Paint and marker can also be easily removed from the powder coated faucet knobs with a non-abrasive cleaner.

**Art Bond:** The City has collected a security in the form of a bond to guarantee installation of the art. The bond will be held until completion of the public art requirement, consistent with SMC Chapter 19.52 (Art in Private Development). The requirement will be deemed complete when the following

conditions are met:

1. Installation of the art
2. Installation of plaques for each art location
3. Installation of lighting for each artwork
4. Registration of the artwork(s), and the property owner's obligation to maintain the artwork, with the County of Santa Clara.
5. Verification of the 1% expenditure
6. Submission of the landscape plan to the City's Visual Arts Coordinator

### **FISCAL IMPACT**

If the artwork is approved, the developer will be responsible for design, fabrication and installation costs of the artwork, as well as ongoing maintenance. There is no fiscal impact on the City's operating budget other than incidental staff time to monitor the project, which is budgeted in the Art in Private Development Program.

The developer anticipates the budget for the two artworks for Phase 1 of the project will be equal to or greater than the 1% requirement; if it is not, the developer will be required to contribute the difference to the City's Public Art Fund. The developer is required to provide backup documentation to substantiate all art expenditures.

### **PUBLIC CONTACT**

Public contact was made through posting of the Arts Commission agenda on the City's official-notice bulletin board, on the City's website, and the availability of the agenda and report in the Office of the City Clerk.

### **ALTERNATIVES**

1. Recommend approval of the artwork as it is proposed.
2. Recommend approval of the artwork as it is proposed with the following condition of approval: Require the developer to submit a final landscape plan prior to installation of the art to the City's Visual Arts Coordinator.
3. Do not recommend approval of the artwork as it is proposed.

### **RECOMMENDATION**

Alternative 2: Recommend approval of the artwork as it is proposed with the following condition of approval: Require the developer to submit a landscape plan prior to installation of the art to the City's Visual Arts Coordinator.

Staff concludes that the proposal adequately meets the criteria of the Art in Private Development requirement. However, the landscape plan is not finalized so the art proposal has been reviewed without considering nearby landscaping and tree locations.

Prepared by: Kristin Dance, Community Services Coordinator II

Reviewed by: Trenton Hill, Community Services Manager

Reviewed by: Damon Sparacino, Superintendent of Community Services

Reviewed by: Cherise Brandell, Director, Department of Library and Community Services

Reviewed by: Teri Silva, Assistant City Manager

Approved by: Kent Steffens, City Manager

**ATTACHMENTS**

1. Vicinity Map
2. Site Plan
3. Site Plan with Art Locations
4. *1000 Suns* by Future Forms
5. Artist Resume
6. Elevation Rendering
7. Artist Sketches
8. Ceramic Models
9. Elevation Rendering Showing Scale
10. Example of Patina
11. Lighting Plan

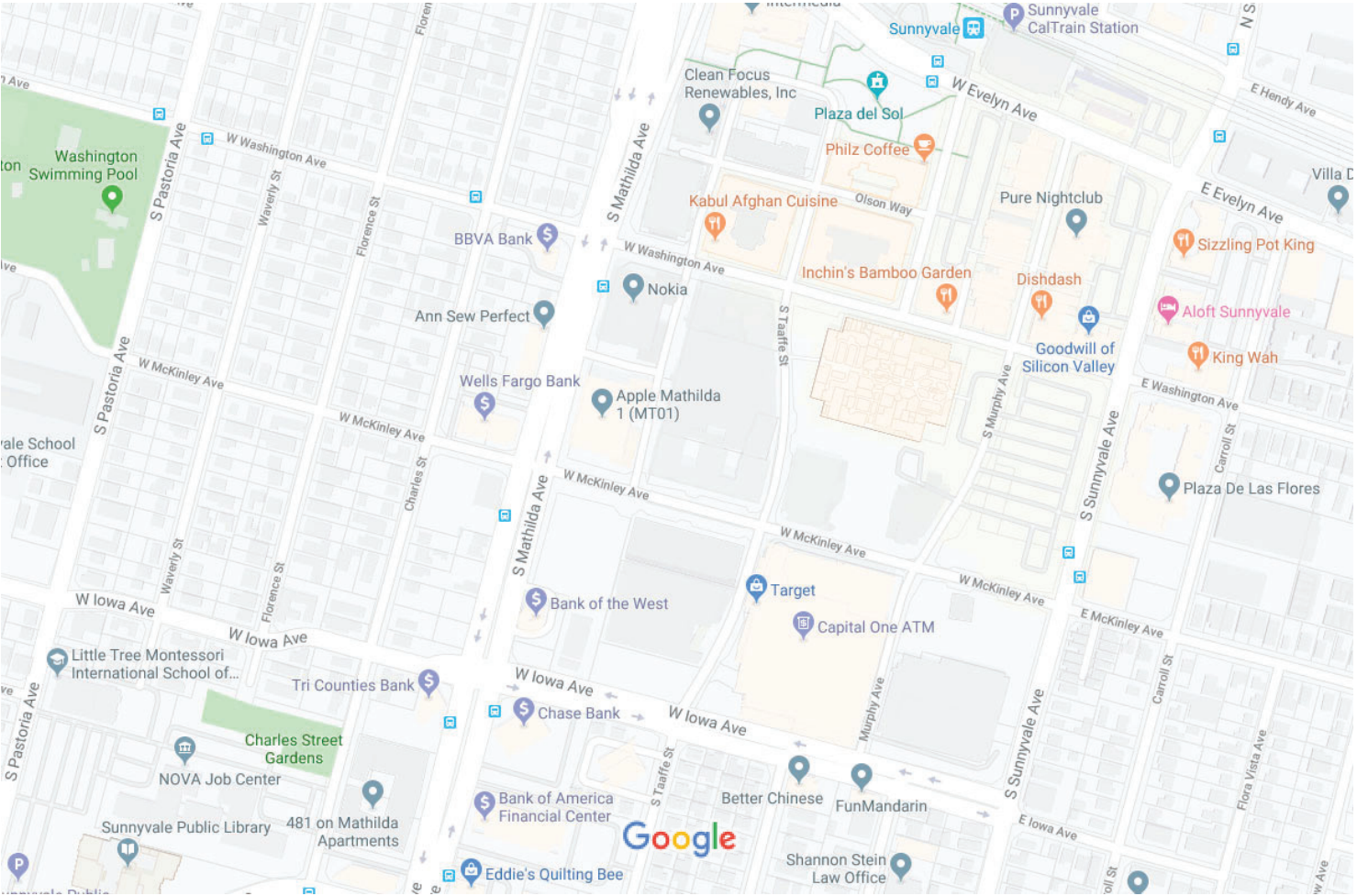

Map data ©2019 Google 200 ft

S. MATHILDA AVE

S. MATHILDA AVE

W. WASHINGTON AVE

S. SUNNYVALE AVE

S. SUNNYVALE AVE

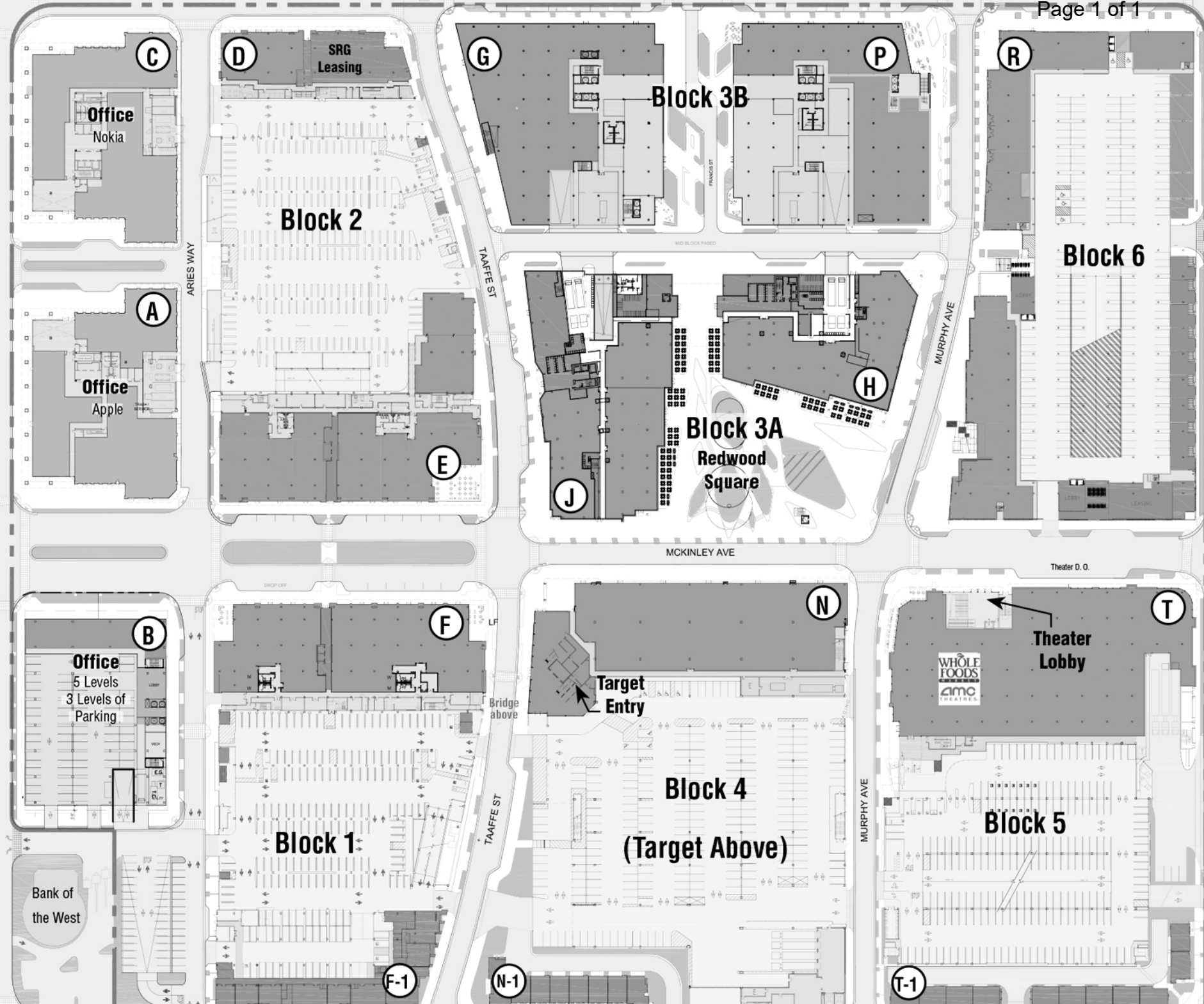

Office  
Nokia

Office  
Apple

Office  
5 Levels  
3 Levels of  
Parking

Bank of  
the West

SRG  
Leasing

Block 3B

Block 3A  
Redwood  
Square

Block 4  
(Target Above)

Block 6

Theater  
Lobby

WHOLE  
FOODS  
MARKET  
AMC  
THEATRES



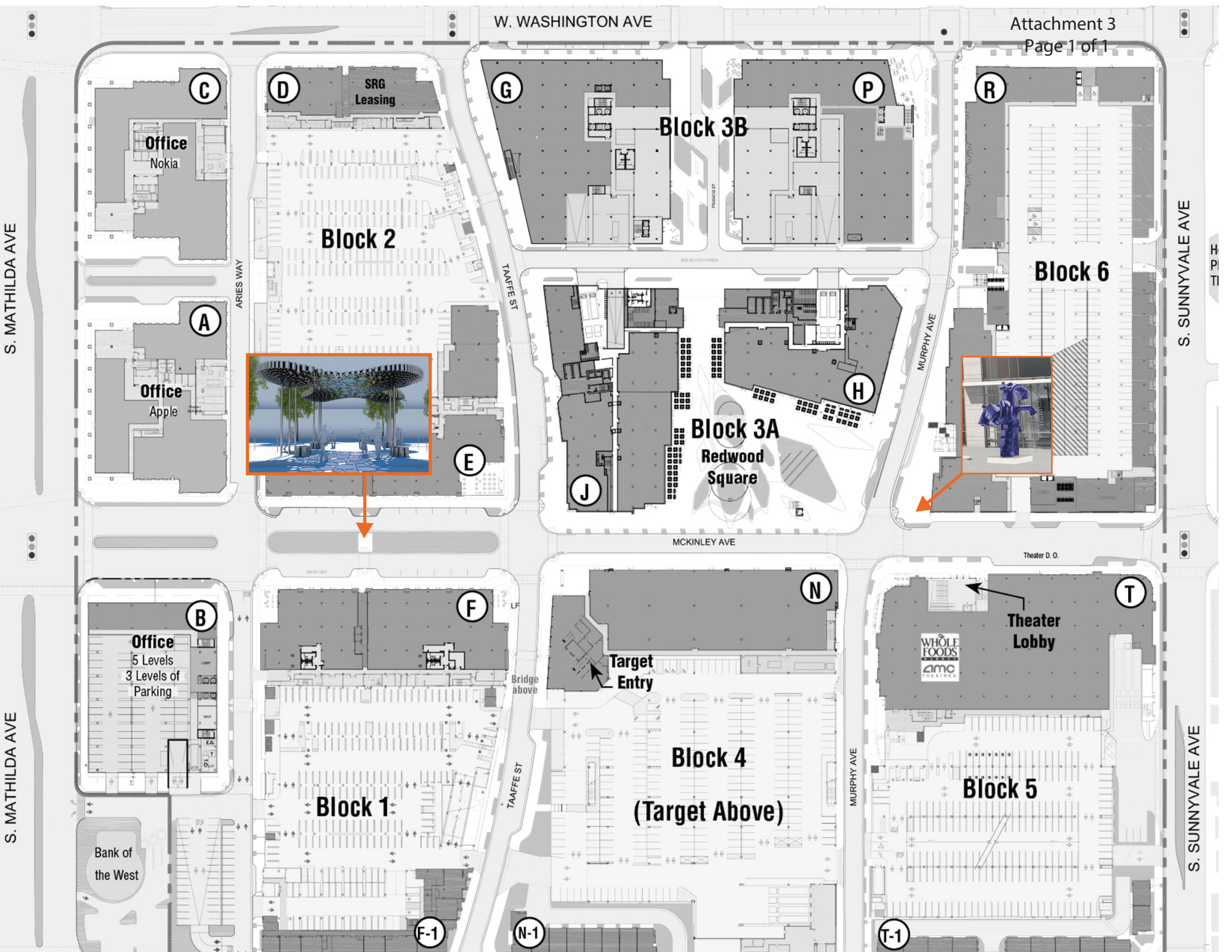

S. MATHILDA AVE

S. MATHILDA AVE

W. WASHINGTON AVE

ARIES WAY

TAAFFE ST

FRANCIS ST

MURPHY AVE

S. SUNNYVALE AVE

H

S. SUNNYVALE AVE

MURPHY AVE

TAAFFE ST

N-1

T-1

Office  
Nokia

Office  
Apple

SRG  
Leasing

Office  
5 Levels  
3 Levels of  
Parking

Bank of  
the West

Target  
Entry

Theater  
Lobby

WHOLE  
FOODS  
MARKET  
AMC  
THEATRES

Block 2

Block 3B

Block 6

Block 3A  
Redwood  
Square

Block 4  
(Target Above)

Block 5



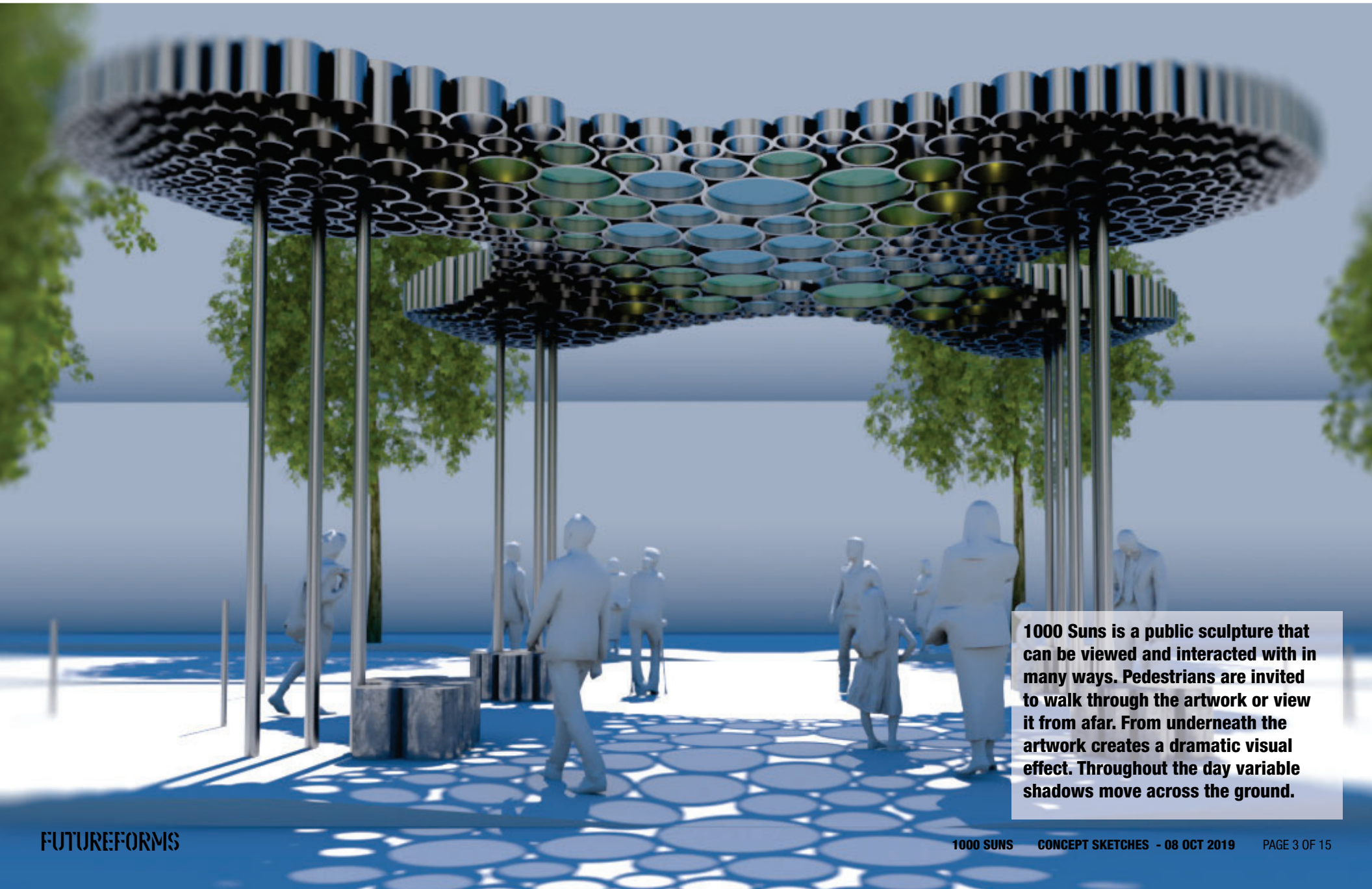

**1000 Suns is a public sculpture that can be viewed and interacted with in many ways. Pedestrians are invited to walk through the artwork or view it from afar. From underneath the artwork creates a dramatic visual effect. Throughout the day variable shadows move across the ground.**





# JESSICA SILVERMAN GALLERY

## Woody De Othello

Born 1991, Miami, Florida  
MFA, California College of Arts, San Francisco, CA, 2017  
BFA, Florida Atlantic University, Boca Raton, FL, 2013  
Lives and works in Berkeley, CA

### Solo Exhibitions

- 2020            John Michael Kohler Arts Center, Sheboygan, WI  
                  Lulu, Mexico City
- 2019            *Woody De Othello*, Karma, New York, NY  
                  San Jose Museum of Art, San Jose, California  
                  Meridians, Art Basel Miami Beach, Miami, Florida
- 2018            *Living Room*, Jessica Silverman Gallery, San Francisco, CA
- 2016            *Lights Out Night Out*, Quality, Oakland, CA  
                  *Real Life Still Life*, Old New England, Berkeley, CA  
                  *Patty's Mashed Potatoes*, UFO Gallery, Berkeley, CA
- 2015            *It's Going To Be Okay*, Unit 1, Lake Worth, FL

### Group Exhibitions

- 2019            *Roommates*, Shulamit Nazarian, Los Angeles, CA  
                  33<sup>rd</sup> Ljubljana Biennial of Graphic Arts, Ljubljana, Slovenia  
                  *Blow Up*, Friedman Benda Gallery, New York, NY
- 2018            *Bay Area Now*, Yerba Buena Center for the Arts, San Francisco, CA  
                  *Horizon Lines*, Jessica Silverman Gallery at 288 Pacific, San Francisco, CA  
                  *Kinship*, Jessica Silverman Gallery, San Francisco, CA  
                  *FRONT International Cleveland Triennial For Contemporary Art*, Cleveland, OH  
                  *From the Ground Up*, Carrie Secrist Gallery, Chicago, IL  
                  *Kinder Gentler Nation*, Karma, New York, NY
- 2017            *Working TWO Scale: New Bay Area Ceramic Sculpture*, Sonoma State University Art Gallery,  
                  Sonoma, CA  
                  *Matt Kleberg and Woody De Othello*, Johansson Projects, Oakland, CA  
                  *Homo Mundus Minor*, Gallery T293, Rome, Italy  
                  *30th Annual Barclay Simpson Master of Fine Arts Award Exhibition*, Perry Family Event Center,  
                  San Francisco, CA  
                  *To Speak of Trees*, Alter Space at Minnesota Street Projects, San Francisco, CA
- 2016            *All College Honors*, Hubbell Street Gallery, San Francisco, CA  
                  *Rocks and Socks*, College Avenue Gallery, Oakland, CA  
                  *Ottawa Makers Market*, The Rideau Curling Club, Ottawa, ON, Canada  
                  *Clay Bodies*, 7264 N. Miami Ct, Miami, FL
- 2015            *Grayscale*, 5&J Gallery, Lubbock, TX

# JESSICA SILVERMAN GALLERY

- 2014 *Possessed*, Fat Village Projects, Ft. Lauderdale, FL  
*Resident Exit Show*, Armory Arts Center, West Palm Beach, FL  
*The Contenders*, Unit 1, Lake Worth, FL  
*Monstrous Strange*, Fat Village Projects, Ft. Lauderdale, FL  
*Acid Reflux*, Fat Village Projects, Ft. Lauderdale, FL  
*The Strange Ones*, Unit 1, Lake Worth, FL  
*Southern Exposure: New Work Now*, Palm Beach Cultural Council, Lake Worth, FL  
*Outside The Box 2*, White Space Gallery, West Palm Beach, FL  
*Fluidity*, Artserve, Ft. Lauderdale, FL  
*All Florida Ceramics Invitational*, Nathan H. Wilson Center, Jacksonville, FL
- 2013 *Small Wonders*, World and Eye Arts Center, Ft. Lauderdale, FL  
*Apex: Fall 2013 BFA Exhibition*, Ritter Art Gallery, Boca Raton, FL  
*Inferno*, Armory Art Center, West Palm Beach, FL  
*College of Arts & Letters Dean's Reception*, Northern Trust Bank, Boca Raton, FL  
*Red Eye Art*, Artserve, Ft. Lauderdale, FL  
*Lounge Series*, Arts Council of Martin County, Stuart, FL  
*Arts After Darks*, Arts Council of Martin County, Stuart, FL
- 2012 *23rd Annual University Juried Student Exhibition*, Atlantic Center of The Arts, New Smyrna Beach, FL  
*Four Minutes, Thirty Three Seconds*, Legal Art, Miami, FL

## Awards/Grants

- 2018 SFO International Terminal Boarding Area G Outdoor Terrace Commission
- 2017 Toby Devan Lewis Award
- 2016 Barclay Simpson Award  
CCA Merit Scholarship
- 2015 CCA All College Honors  
CCA Merit Scholarship
- 2013 Claire V. Dorst Scholarship (FAU)  
Runner-up of Fine Art in Creative Quarterly  
John McCoy Scholarship (FAU)  
Rothenberger Endowed Scholarship for Humanities (FAU)
- 2012 Marvin and Eileen Reingold Contemporary Ceramics Collection
- 2011 Rothenberger Endowed Scholarship for Humanities: Printmaking (FAU)

## Residencies

- 2020 John Michael Kohler Arts Center, Sheboygan, WI
- 2018 Liquitex Research Residency, Minnesota Street Project, San Francisco, CA
- 2016 Old New England, Berkeley, CA

# JESSICA SILVERMAN GALLERY

2015                    Pentaculum Resident, Arrowmont, Gatlinburg, TN

2014-15               Sculpture Artist in Residence, Armory Arts Center, West Palm Beach, FL

## Selected Bibliography

2019                    Desmarais, Charles. "Bay Area ceramics scene fired up in news ways." *Datebook*. July 24, 2019.  
Desmarais, Charles. "6 ceramic sculpture exhibitions not to miss." *Datebook*. July 22, 2019.

2018                    Gerrity, Jeanne. "Critic's Pick." *Artforum*. October 11, 2018.  
Fancher, Lou. "Hope, danger, humor coexist in exhibit spotlighting top SF Bay Area artists." *Easy Bay Times*. September 20, 2018.  
Desmarais, Charles. "Woody De Othello's clay bodies at Jessica Silverman Gallery" *SF Chronicle*, September 18, 2018.  
Guadagnino, Kate. "Funky Ceramics Are Everywhere. Including in Galleries." *T Magazine*. June 14, 2018.

2017                    De Othello, Woody. "Ceramics and Preservation in the Bay" *The Brooklyn Rail*. November 2, 2017.

## Collections

San Francisco Museum Art, San Francisco, CA  
San Jose Museum of Art, San Jose, CA  
Rennie Collection, Vancouver, B.C.









*Double Drip* | Sketches & Inspiration



A small ceramic sculpture that Othello created in 2019 served as a starting point in the conception of this public artwork.

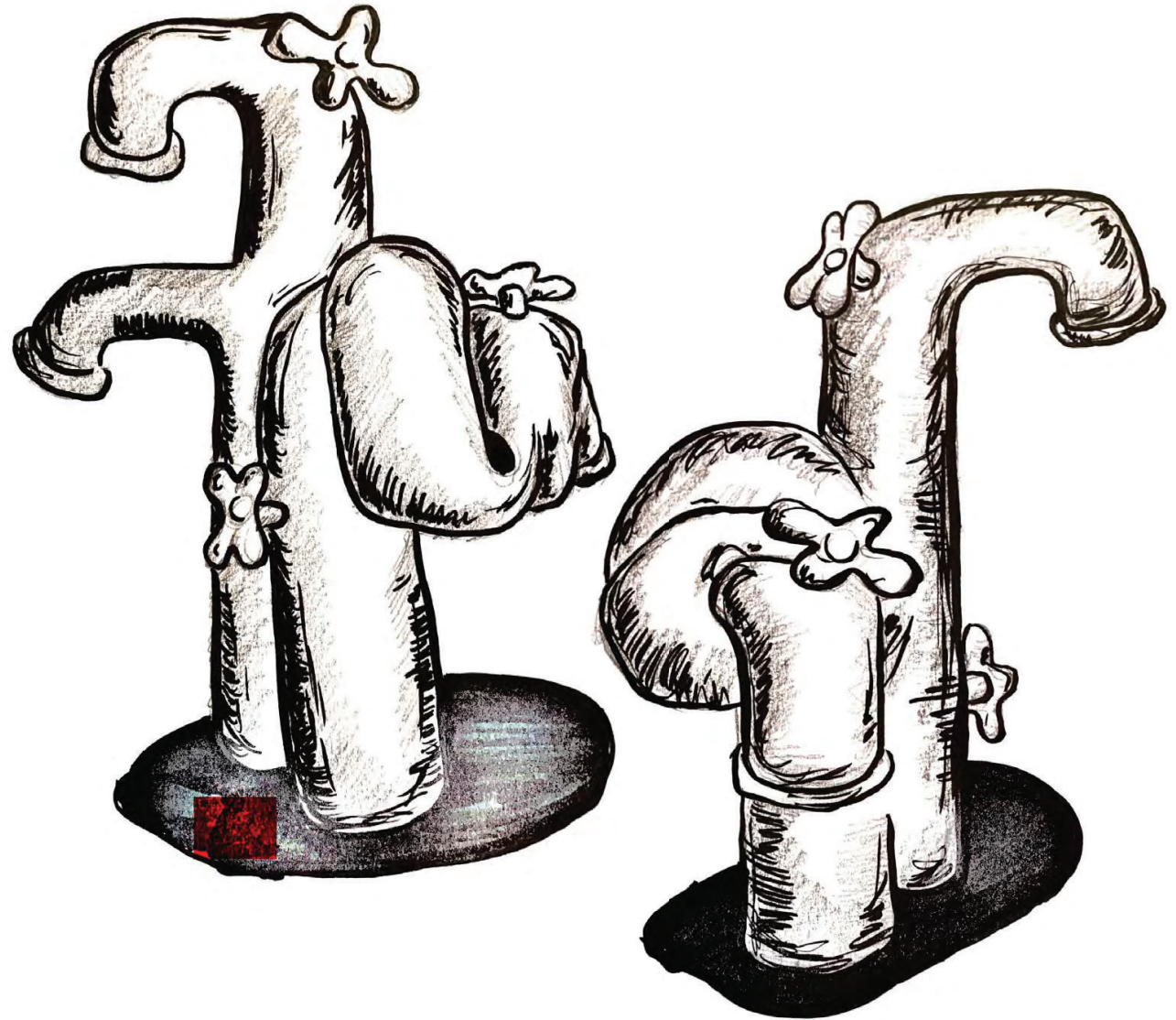

*Double Drip* | Ceramic Maquette Views



**\*\* PLEASE NOTE:** The ceramic maquettes are representative of the form and the massing of the object. Because they are made with a ceramic glaze, they are NOT representative of the finish of the final work, which will be a patina on cast bronze. The final finish is best represented on pages 12 and 13, in the SFO Commission sculptures.



## Double Drip | Elevation



10' Tall bronze sculpture

1'6" Tall pedestal

20' Ground floor  
ceiling height

At highest point,  
sculpture sits 11'6"  
above sidewalk



- The sculpture will be situated on a cement pedestal that is coherent with the other streetscape elements. The pedestal will add about 2' to the height of the piece, and will create a boundary around the work to prevent pedestrians from touching, climbing, or running into the sculpture. We are considering landscaping within the pedestal to further discourage anyone from physically interacting with the piece.



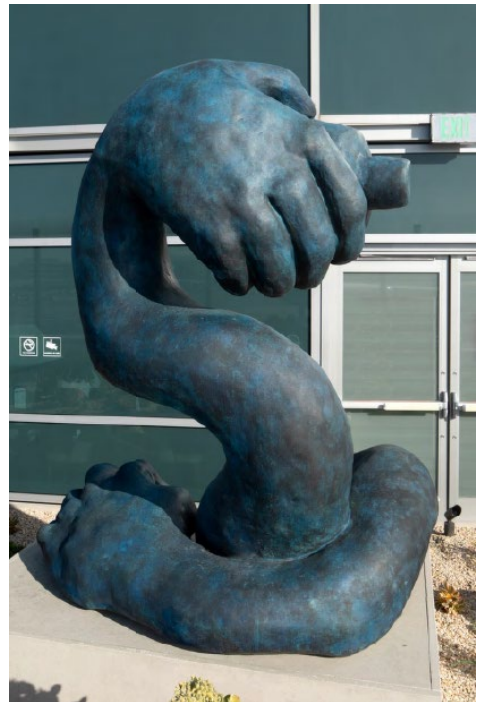
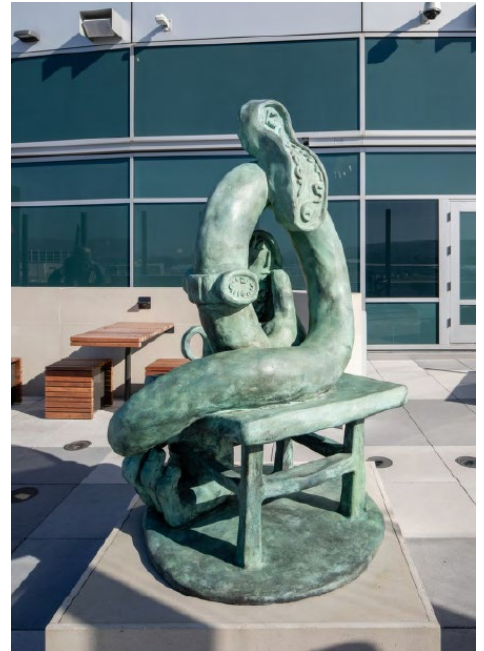



## Double Drip | Lighting Plan

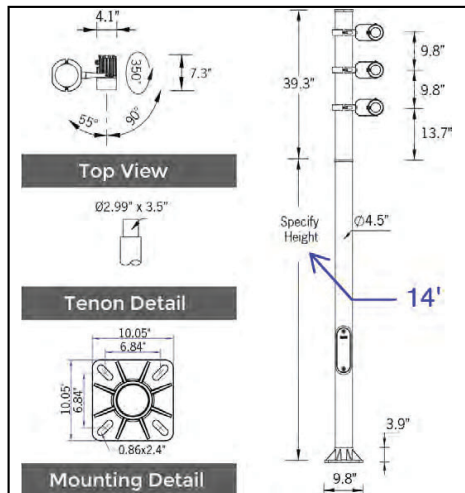
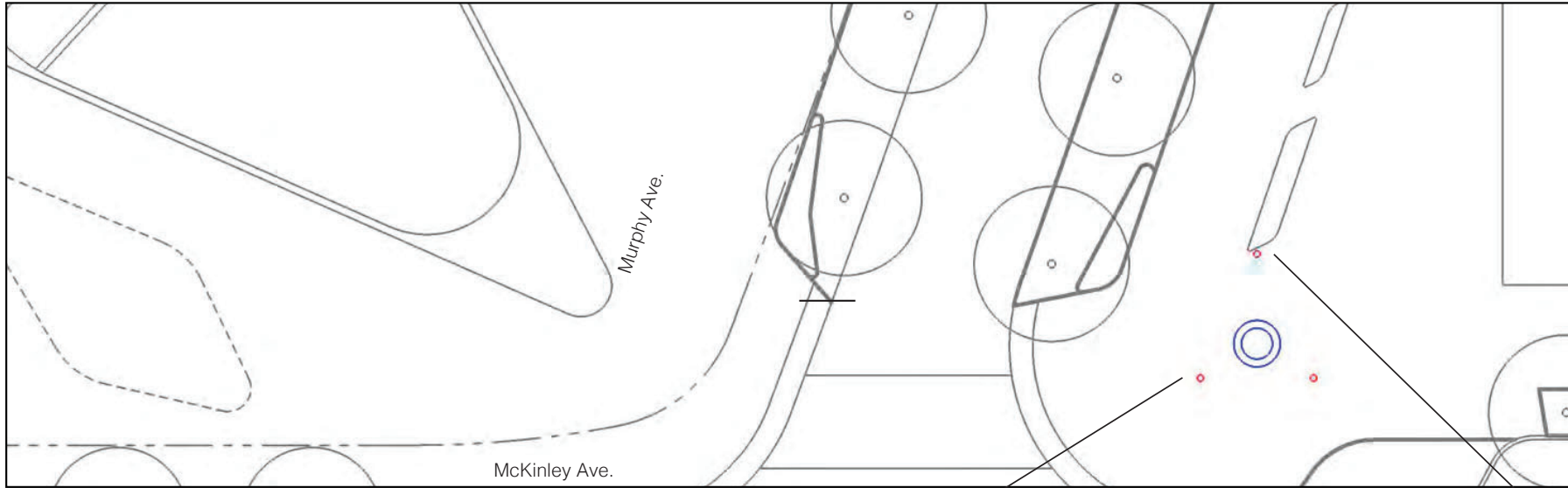

- (3) In-ground light poles 14' high will spotlight the sculpture from three angles. The height allows for the lights to point down at the sculpture so they don't interfere with oncoming traffic or pedestrian sightlines.

We intend to incorporate lighting hardware into streetscape elements wherever possible, as to leave the sidewalk as clear from pedestrian obstruction as possible.





# City of Sunnyvale

## Agenda Item

---

**20-0292**

**Agenda Date:** 3/18/2020

---

Arts Commission Proposed Study Issues, Calendar Year: 2021

Proposed Study Issues\*

Date	Working Title	Summary of Scope	Staff Comments

\*The study issues have been proposed for future sponsorship

Toward the end of the calendar year, no later than October, boards and commissions will review the list of proposed study issues and officially vote on sponsorship for each individually listed study issue. Official sponsorship means that the study issue is approved for ranking with a majority vote of the board or commission. Staff will then prepare the sponsored study issue papers, including fiscal impact **but not** the staff recommendation.