



DISH Wireless L.L.C. SITE ID:

SFSFO00173A

DISH Wireless L.L.C. SITE ADDRESS:

919 HAMLIN COURT
SUNNYVALE, CA 94089

CALIFORNIA CODE OF COMPLIANCE

ALL WORK SHALL BE PERFORMED AND MATERIALS INSTALLED IN ACCORDANCE WITH THE CURRENT EDITIONS OF THE FOLLOWING CODES AS ADOPTED BY THE LOCAL GOVERNING AUTHORITIES. NOTHING IN THESE PLANS IS TO BE CONSTRUED TO PERMIT WORK NOT CONFORMING TO THESE CODES

CODE TYPE	CODE
BUILDING	2019 CALIFORNIA BUILDING CODE (CBC)/2018 IBC
MECHANICAL	2019 CALIFORNIA MECHANICAL CODE (CMC)/2018 UMC
ELECTRICAL	2019 CALIFORNIA ELECTRICAL CODE (CEC)/2017 NEC

SHEET INDEX

SHEET NO.	SHEET TITLE
T-1	TITLE SHEET
LS-1	SITE SURVEY (SPECIFICATIONS PROVIDED BY OTHERS)
A-1	OVERALL AND ENLARGED SITE PLAN
A-2.1	EXISTING AND FINAL ELEVATION
A-2.2	ANTENNA LAYOUT AND SCHEDULE
A-3	EQUIPMENT PAD AND H-FRAME DETAILS
A-4	EQUIPMENT DETAILS (SPECIFICATIONS PROVIDED BY OTHERS)
A-5	EQUIPMENT DETAILS (SPECIFICATIONS PROVIDED BY OTHERS)
A-6	EQUIPMENT DETAILS (SPECIFICATIONS PROVIDED BY OTHERS)
E-1.1	ELECTRICAL/FIBER ROUTE PLAN AND NOTES
E-1.2	ELECTRICAL/FIBER ROUTE PLAN AND NOTES
E-2	ELECTRICAL DETAILS
E-3	ELECTRICAL ONE-LINE, FAULT CALCS & PANEL SCHEDULE
G-1	GROUNDING PLANS AND NOTES
G-2	GROUNDING DETAILS
G-3	GROUNDING DETAILS
RF-1	RF CABLE COLOR CODE (SPECIFICATIONS PROVIDED BY OTHERS)
GN-1	LEGEND AND ABBREVIATIONS
GN-2	GENERAL NOTES
GN-3	GENERAL NOTES
GN-4	GENERAL NOTES
ATTACHED	RADIO FREQUENCY – ELECTROMAGNETIC ENERGY JURISDICTIONAL REPORT

SCOPE OF WORK

THIS IS NOT AN ALL INCLUSIVE LIST. CONTRACTOR SHALL UTILIZE SPECIFIED EQUIPMENT PART OR ENGINEER APPROVED EQUIVALENT. CONTRACTOR SHALL VERIFY ALL NEEDED EQUIPMENT TO PROVIDE A FUNCTIONAL SITE. THE PROJECT GENERALLY CONSISTS OF THE FOLLOWING:

- TOWER SCOPE OF WORK:
- INSTALL (3) PROPOSED PANEL ANTENNAS (1 PER SECTOR)
 - INSTALL (3) PROPOSED ANTENNA T-ARM MOUNTS
 - INSTALL PROPOSED JUMPERS
 - INSTALL (8) PROPOSED RRUs (2 PER SECTOR)
 - INSTALL (1) PROPOSED OVER VOLTAGE PROTECTION DEVICE (OVP)
 - INSTALL (1) PROPOSED HYBRID CABLE

- GROUND SCOPE OF WORK:
- INSTALL 6'-0" x 8'-0" COMPOUND EXPANSION
 - INSTALL (1) PROPOSED CONCRETE PAD
 - INSTALL (1) PROPOSED ICE BRIDGE
 - INSTALL (1) PROPOSED PPC CABINET
 - INSTALL (1) PROPOSED EQUIPMENT CABINET
 - INSTALL (1) PROPOSED POWER CONDUIT
 - INSTALL (1) PROPOSED TELCO CONDUIT
 - INSTALL (1) PROPOSED TELCO-FIBER BOX
 - INSTALL (1) PROPOSED GPS UNIT
 - INSTALL (1) PROPOSED SAFETY SWITCH (IF REQUIRED)
 - INSTALL (1) PROPOSED FIBER NID (IF REQUIRED)
 - INSTALL (1) PROPOSED MULTI-METER PANEL BOARD (PG&E STANDARD)
 - INSTALL (1) 400A BUSSED GUTTER WITH (1) 200A METER MAIN & (1) SPARE 200A METER MAIN
 - INSTALL (1) 400A SERVICE ENTRANCE TERMINATION ENCLOSURE

SITE PHOTO



UNDERGROUND SERVICE ALERT
UTILITY NOTIFICATION CENTER OF CALIFORNIA
(800) 642-2444
WWW.CALIFORNIA811.ORG

CALL 2-14 WORKING DAYS UTILITY NOTIFICATION PRIOR TO CONSTRUCTION



GENERAL NOTES

THE FACILITY IS UNMANNED AND NOT FOR HUMAN HABITATION. A TECHNICIAN WILL VISIT THE SITE AS REQUIRED FOR ROUTINE MAINTENANCE. THE PROJECT WILL NOT RESULT IN ANY SIGNIFICANT DISTURBANCE OR EFFECT ON DRAINAGE. NO SANITARY SEWER SERVICE, POTABLE WATER, OR TRASH DISPOSAL IS REQUIRED AND NO COMMERCIAL SIGNAGE IS PROPOSED.

11"x17" PLOT WILL BE HALF SCALE UNLESS OTHERWISE NOTED

CONTRACTOR SHALL VERIFY ALL PLANS, EXISTING DIMENSIONS, AND CONDITIONS ON THE JOB SITE, AND SHALL IMMEDIATELY NOTIFY THE ENGINEER IN WRITING OF ANY DISCREPANCIES BEFORE PROCEEDING WITH THE WORK.

SITE INFORMATION

PROPERTY OWNER: RICHARD & JANE PEATTIE
ADDRESS: 40 PLEASANT STREET
LOS GATOS, CA 95030

TOWER TYPE: MONOPOLE

TOWER CO SITE ID: 856177

TOWER APP NUMBER: 562371

COUNTY: SANTA CLARA

LATITUDE (NAD 83): 37.400861

LONGITUDE (NAD 83): -122.030222

ZONING JURISDICTION: CITY OF SUNNYVALE

ZONING DISTRICT: UNKNOWN

PARCEL NUMBER: 110-07-040

OCCUPANCY GROUP: U

CONSTRUCTION TYPE: II-B

POWER COMPANY: PACIFIC GAS & ELECTRIC

TELEPHONE COMPANY: AT&T

PROJECT DIRECTORY

APPLICANT: DISH Wireless L.L.C.
5701 SOUTH SANTA FE DRIVE
LITTLETON, CO 80120

TOWER OWNER: CROWN CASTLE USA INC.
2000 CORPORATE DRIVE
CANONSBURG, PA 15317
(877) 486-9377

SITE DESIGNER: POD
11490 BLUEGRASS PARKWAY
LOUISVILLE, KY 40299
(502) 437-5252

SITE ACQUISITION: HEIDI PAYNE
HEIDI.PAYNE@CROWNCastle.COM

CONSTRUCTION MANAGER: TIMOTHY FEHR
TIMOTHY.FEHR@DISH.COM

RF ENGINEER: POOJA SHAH
POOJA.SHAH@DISH.COM

DIRECTIONS

DIRECTIONS FROM SAN FRANCISCO INTERNATIONAL AIRPORT:

1. FOLLOW US-101 S TO N MATHILDA AVE IN SUNNYVALE. TAKE EXIT 3B FROM CA-237 E
2. TAKE ROSS DR AND HAMLIN CT TO YOUR DESTINATION

VICINITY MAP

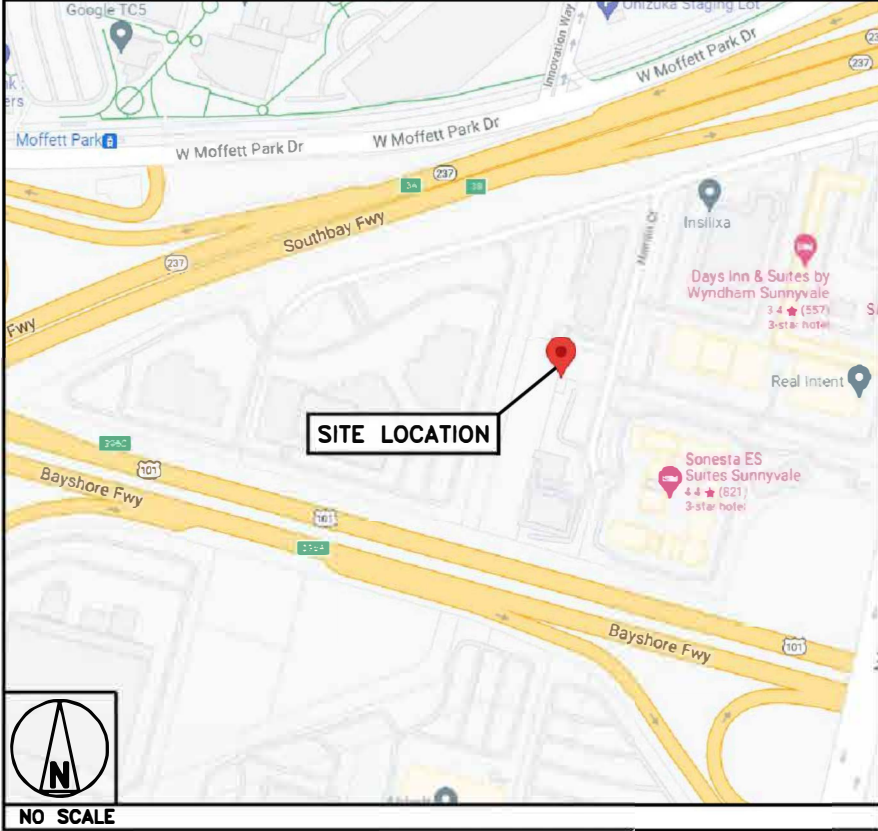

5701 SOUTH SANTA FE DRIVE
LITTLETON, CO 80120



11490 BLUEGRASS PKWY
LOUISVILLE, KY 40299



08/09/2022

IT IS A VIOLATION OF LAW FOR ANY PERSON, UNLESS THEY ARE ACTING UNDER THE DIRECTION OF A LICENSED PROFESSIONAL ENGINEER, TO ALTER THIS DOCUMENT.

DRAWN BY: CHECKED BY: APPROVED BY:

AJM AK MEP

RFDS REV #: 1 9/14/2021

CONSTRUCTION DOCUMENTS

SUBMITTALS		
REV	DATE	DESCRIPTION
A	02/17/2022	ISSUED FOR REVIEW
0	04/28/2022	ISSUED FOR CONSTRUCTION
1	08/08/2022	ISSUED FOR CONSTRUCTION

A&E PROJECT NUMBER
856177

DISH Wireless L.L.C.
PROJECT INFORMATION
SFSFO00173A
919 HAMLIN COURT
SUNNYVALE, CA 94089

SHEET TITLE
TITLE SHEET

SHEET NUMBER
T-1



5701 SOUTH SANTA FE DRIVE
LITTLETON, CO 80120



11490 BLUEGRASS PKWY
LOUISVILLE, KY 40299

FOR REFERENCE
PURPOSES ONLY

IT IS A VIOLATION OF LAW FOR ANY PERSON,
UNLESS THEY ARE ACTING UNDER THE DIRECTION
OF A LICENSED PROFESSIONAL ENGINEER,
TO ALTER THIS DOCUMENT.

DRAWN BY: CHECKED BY: APPROVED BY:

AJM AK MEP

RFDS REV #: 1 9/14/2021

CONSTRUCTION
DOCUMENTS

SUBMITTALS		
REV	DATE	DESCRIPTION
A	02/17/2022	ISSUED FOR REVIEW
0	04/28/2022	ISSUED FOR CONSTRUCTION
1	08/08/2022	ISSUED FOR CONSTRUCTION

A&E PROJECT NUMBER
856177

DISH Wireless L.L.C.
PROJECT INFORMATION

SFSF000173A
919 HAMLIN COURT
SUNNYVALE, CA 94089

SHEET TITLE
SITE SURVEY
SITE PLAN

SHEET NUMBER

LS-1

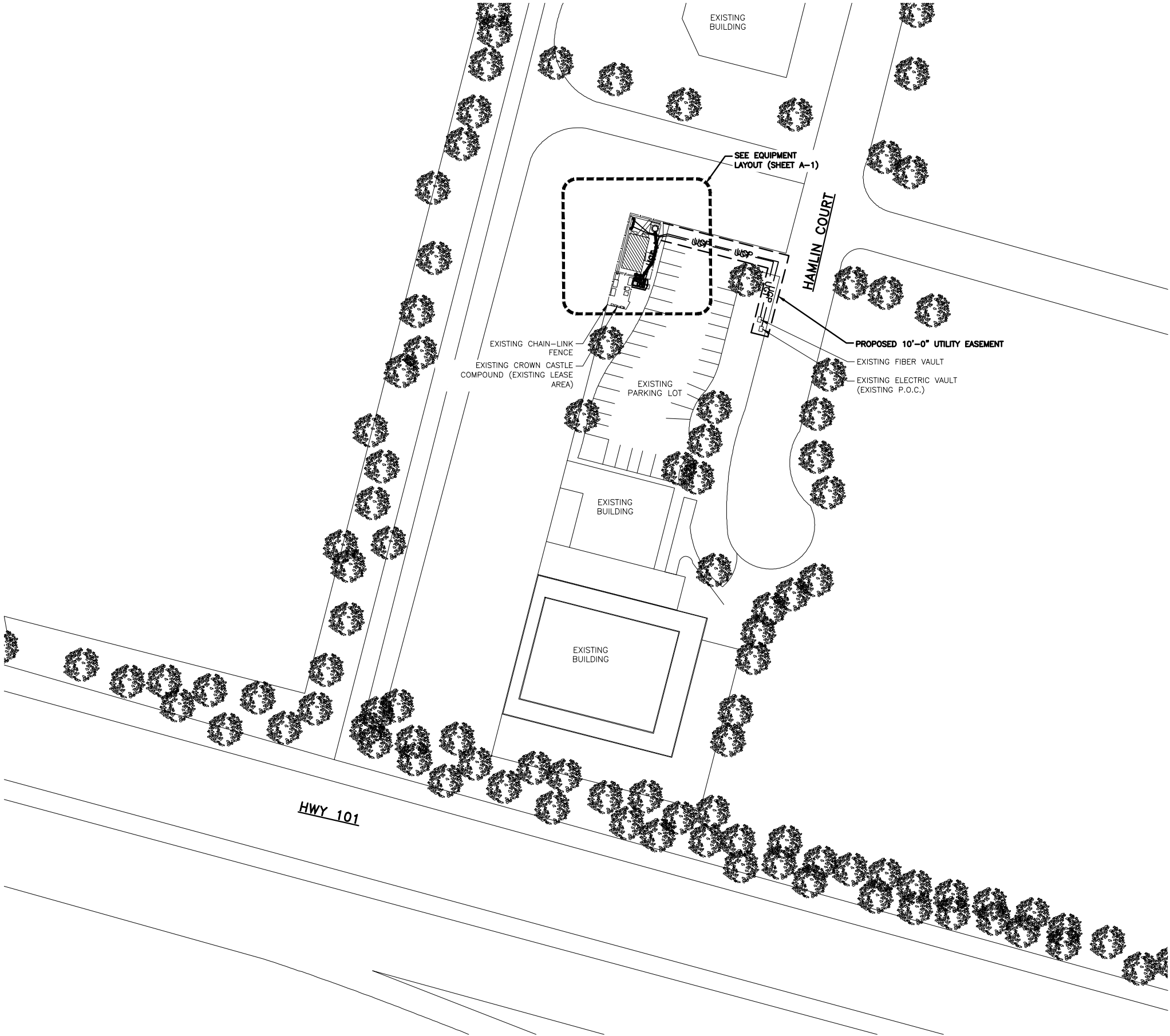

SITE SURVEY

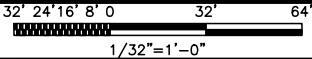



5701 SOUTH SANTA FE DRIVE
LITTLETON, CO 80120



11490 BLUEGRASS PKWY
LOUISVILLE, KY 40299



08/09/2022

IT IS A VIOLATION OF LAW FOR ANY PERSON,
UNLESS THEY ARE ACTING UNDER THE DIRECTION
OF A LICENSED PROFESSIONAL ENGINEER,
TO ALTER THIS DOCUMENT.

DRAWN BY: CHECKED BY: APPROVED BY:

AJM AK MEP

RFDS REV #: 1 9/14/2021

CONSTRUCTION DOCUMENTS

SUBMITTALS		
REV	DATE	DESCRIPTION
A	02/17/2022	ISSUED FOR REVIEW
0	04/28/2022	ISSUED FOR CONSTRUCTION
1	08/08/2022	ISSUED FOR CONSTRUCTION

A&E PROJECT NUMBER
856177

DISH Wireless L.L.C.
PROJECT INFORMATION

SFSF000173A
919 HAMLIN COURT
SUNNYVALE, CA 94089

SHEET TITLE
OVERALL AND ENLARGED
SITE PLAN

SHEET NUMBER

A-1

NOTES

1. CONTRACTOR SHALL FIELD VERIFY ALL DIMENSIONS.
2. ANTENNAS AND MOUNTS OMITTED FOR CLARITY.

NOTES

1. CONTRACTOR SHALL FIELD VERIFY ALL DIMENSIONS.
2. CONTRACTOR SHALL MAINTAIN A 10'-0" MINIMUM SEPARATION BETWEEN THE PROPOSED GPS UNIT, TRANSMITTING ANTENNAS AND EXISTING GPS UNITS.
3. ANTENNAS AND MOUNTS OMITTED FOR CLARITY.

PROPOSED DISH Wireless
L.L.C. 12" WIDE ICE BRIDGE

SEE EQUIPMENT
LAYOUT (SHEET A-3)

7'-0"
LEASE AREA/PAD

5'-0"
LEASE AREA/PAD



ENLARGED SITE PLAN

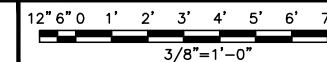

2

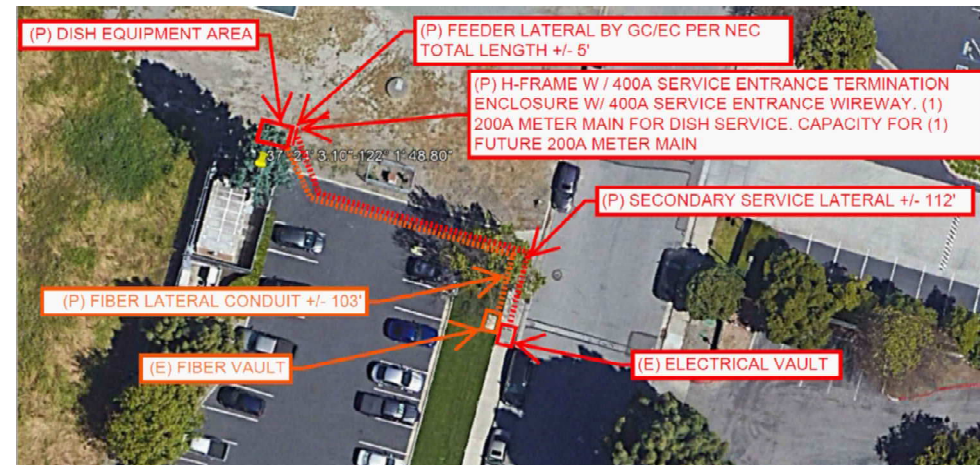

AERIAL UTILITY ROUTE

NO SCALE

3

NOTES

1. CONTRACTOR SHALL FIELD VERIFY ALL DIMENSIONS.
2. ANTENNAS AND MOUNTS OMITTED FOR CLARITY.

PROPOSED DISH Wireless L.L.C.
MULTI-METER PANEL BOARD
(PG&E STANDARD)

PROPOSED DISH Wireless L.L.C. 400A
SERVICE ENTRANCE TERMINATION ENCLOSURE

PROPOSED DISH Wireless L.L.C. 400A BUSSED
GUTTER WITH (1) 200A METER MAIN & (1)
SPARE 200A METER MAIN FOR FUTURE USE

EXISTING CROWN CASTLE
COMPOUND (EXISTING LEASE
AREA)

EXISTING ICE
BRIDGE (TYP)

EXISTING EQUIPMENT
SHELTER
(20'-8"x11'-10")

EXISTING 15' WIDE
CHAIN-LINK GATE

PROPOSED 10'-0"
UTILITY EASEMENT

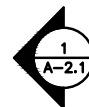

EXISTING
PARKING LOT

SEE ENLARGED
SITE PLAN
PROPOSED 6'-0"
CHAIN-LINK GATE
W/ PRIVACY
SLATS (TYP)

6'-0"
(PROPOSED FENCE)

8'-0"
(PROPOSED FENCE)

PROPOSED CHAIN-LINK FENCE
W/ PRIVACY SLATS

EXISTING 4' WIDE
CHAIN-LINK GATE

EXISTING CHAIN-LINK
FENCE

OVERALL SITE PLAN

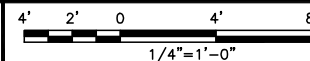

1

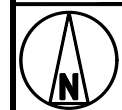



5701 SOUTH SANTA FE DRIVE
LITTLETON, CO 80120



11490 BLUEGRASS PKWY
LOUISVILLE, KY 40299



08/09/2022

IT IS A VIOLATION OF LAW FOR ANY PERSON,
UNLESS THEY ARE ACTING UNDER THE DIRECTION
OF A LICENSED PROFESSIONAL ENGINEER,
TO ALTER THIS DOCUMENT.

DRAWN BY:	CHECKED BY:	APPROVED BY:
AJM	AK	MEP

RFDS REV #: 1 9/14/2021

CONSTRUCTION
DOCUMENTS

SUBMITTALS		
REV	DATE	DESCRIPTION
A	02/17/2022	ISSUED FOR REVIEW
0	04/28/2022	ISSUED FOR CONSTRUCTION
1	08/08/2022	ISSUED FOR CONSTRUCTION

A&E PROJECT NUMBER
856177

DISH Wireless L.L.C.
PROJECT INFORMATION

SFSF000173A
919 HAMLIN COURT
SUNNYVALE, CA 94089

SHEET TITLE
ELEVATION, ANTENNA
LAYOUT AND SCHEDULE

SHEET NUMBER

A-2.1

NOTES

1. CONTRACTOR SHALL FIELD VERIFY ALL DIMENSIONS.
2. ANTENNA SPECIFICATIONS REFER TO ANTENNA SCHEDULE AND TO FINAL CONSTRUCTION RFDS FOR ALL RF DETAILS
3. EXISTING EQUIPMENT AND FENCE OMITTED FOR CLARITY.
4. PAINT AND CAMOUFLAGE PROPOSED EQUIPMENT TO MATCH EXISTING EQUIPMENT

EXISTING BRANCHES
TOP EL. @ 72'-5" AGL

EXISTING MONOPOLE
TOP EL. @ 67'-0" AGL

EXISTING PANEL ANTENNAS
RAD CENTER @ 65'-0" AGL

EXISTING PANEL ANTENNAS
RAD CENTER @ 54'-0" AGL

EXISTING PANEL ANTENNAS
RAD CENTER @ 48'-0" AGL

(3) PROPOSED DISH Wireless L.L.C. ANTENNAS
RAD CENTER @ 39'-0" AGL

PROPOSED DISH Wireless L.L.C. ENTRY PORT
RAD CENTER @ ±35'-0" AGL

EXISTING MONOPOLE

(1) PROPOSED DISH Wireless L.L.C.
HYBRID CABLE ROUTED INSIDE POLE

PROPOSED DISH Wireless L.L.C.
ICE BRIDGE

PROPOSED DISH Wireless L.L.C.
EQUIPMENT ON PROPOSED
CONCRETE PAD

PROPOSED DISH Wireless L.L.C.
GPS UNIT

EXISTING MONOPOLE
BOTTOM EL. @ 6" AGL

EXISTING ENTRY PORT

EXISTING BRANCHES
TOP EL. @ 72'-5" AGL

EXISTING MONOPOLE
TOP EL. @ 67'-0" AGL

EXISTING PANEL ANTENNAS
RAD CENTER @ 65'-0" AGL

EXISTING PANEL ANTENNAS
RAD CENTER @ 54'-0" AGL

EXISTING PANEL ANTENNAS
RAD CENTER @ 48'-0" AGL

EXISTING MONOPOLE
BOTTOM EL. @ 6" AGL

EXISTING ENTRY PORT

EXISTING EAST ELEVATION

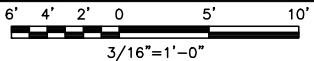

1

PROPOSED EAST ELEVATION

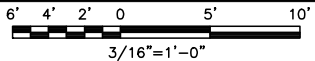

2



5701 SOUTH SANTA FE DRIVE
LITTLETON, CO 80120



11490 BLUEGRASS PKWY
LOUISVILLE, KY 40299



08/09/2022

IT IS A VIOLATION OF LAW FOR ANY PERSON,
UNLESS THEY ARE ACTING UNDER THE DIRECTION
OF A LICENSED PROFESSIONAL ENGINEER,
TO ALTER THIS DOCUMENT.

DRAWN BY: CHECKED BY: APPROVED BY:

AJM AK MEP

RFDS REV #: 1 9/14/2021

CONSTRUCTION
DOCUMENTS

SUBMITTALS

REV	DATE	DESCRIPTION
A	02/17/2022	ISSUED FOR REVIEW
0	04/28/2022	ISSUED FOR CONSTRUCTION
1	08/08/2022	ISSUED FOR CONSTRUCTION

A&E PROJECT NUMBER

856177

DISH Wireless L.L.C.
PROJECT INFORMATION

SFSF000173A
919 HAMLIN COURT
SUNNYVALE, CA 94089

SHEET TITLE
ELEVATION, ANTENNA
LAYOUT AND SCHEDULE

SHEET NUMBER

A-2.2

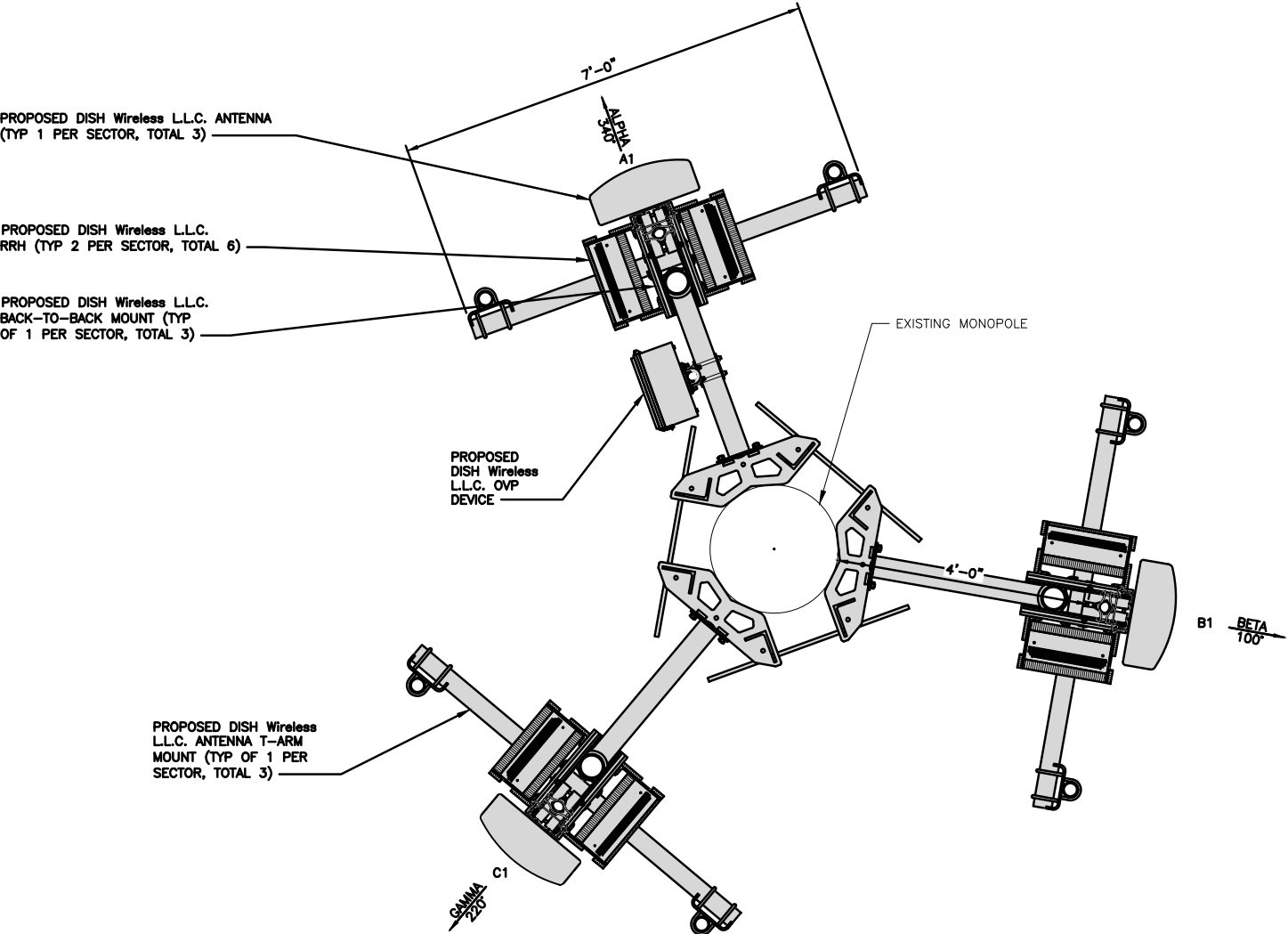

ANTENNA LAYOUT

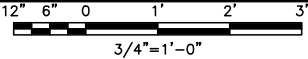

1

SECTOR	POSITION	ANTENNA						TRANSMISSION CABLE
		EXISTING OR PROPOSED	MANUFACTURER – MODEL NUMBER	TECHNOLOGY	SIZE (HxW)	AZIMUTH	RAD CENTER	FEED LINE TYPE AND LENGTH
ALPHA	A1	PROPOSED	CELLMAX TECHNOLOGIES CMA-UBTULBULBHH/6516/16/21/21	5G	72.4" x 26.7"	340°	39°-0"	(1) HIGH-CAPACITY HYBRID CABLE (70'-0" LONG)
BETA	B1	PROPOSED	CELLMAX TECHNOLOGIES CMA-UBTULBULBHH/6516/16/21/21	5G	72.4" x 26.7"	100°	39°-0"	
GAMMA	C1	PROPOSED	CELLMAX TECHNOLOGIES CMA-UBTULBULBHH/6516/16/21/21	5G	72.4" x 26.7"	220°	39°-0"	

SECTOR	POSITION	RRH			NOTES 1. CONTRACTOR TO REFER TO FINAL CONSTRUCTION RFDS FOR ALL RF DETAILS. 2. ANTENNA AND RRH MODELS MAY CHANGE DUE TO EQUIPMENT AVAILABILITY. ALL EQUIPMENT CHANGES MUST BE APPROVED AND REMAIN IN COMPLIANCE WITH THE PROPOSED DESIGN AND STRUCTURAL ANALYSES.
		MANUFACTURER – MODEL NUMBER	TECHNOLOGY	BAND	
ALPHA	A1	FUJITSU – TA08025-B604	5G	N71 N29	
	A1	FUJITSU – TA08025-B605	5G	N70 N66	
BETA	B1	FUJITSU – TA08025-B604	5G	N71 N29	
	B1	FUJITSU – TA08025-B605	5G	N70 N66	
GAMMA	C1	FUJITSU – TA08025-B604	5G	N71 N29	
	C1	FUJITSU – TA08025-B605	5G	N70 N66	

ANTENNA SCHEDULE

NO SCALE

2

