

Little Tree Montessori International School

小樹苗蒙特梭利國際學校

Parking Management Plan **11/13/13**

A. Staff Parking

Little Tree Montessori plans to employ 12 full-time and 6 part-time employees. The employees will work in shifts due to the staggered class schedule. For the 18 total employees, the anticipated shift schedule is as follows:

2 will work from 7:45AM to 4:45PM
2 will work from 8:00AM to 3:30PM
2 will work from 8:30AM to 5:30PM
4 will work from 8:45AM to 12:30PM
6 will work from 9:00AM to 6:00PM
2 will work from 9:30AM to 6:30PM

Staff will be instructed to park at specific parking spaces as shown on the attached Exhibit A. There are 6 spaces in Parking Lot A and 9 spaces in Parking Lot B, total of 15 spaces to be used by staff.

B. Drop off / Pick up Parking

Parents can use both Parking Lots A and B for drop off and pick up parking. The daily drop off and pick up times are as follows:

AM Drop off hours: 8:00-9:30

PM Pick up hours: 12:00-12:15, 3:00-3:30, and 5:15-6:30

Parents will be instructed at the time of enrollment that to park in either Parking Lot A or Parking Lot B. There are 14 spaces in Parking Lot A (2 of which are ADA spaces) and 18 spaces in Parking Lot B, total of 32 spaces to be used by parents.

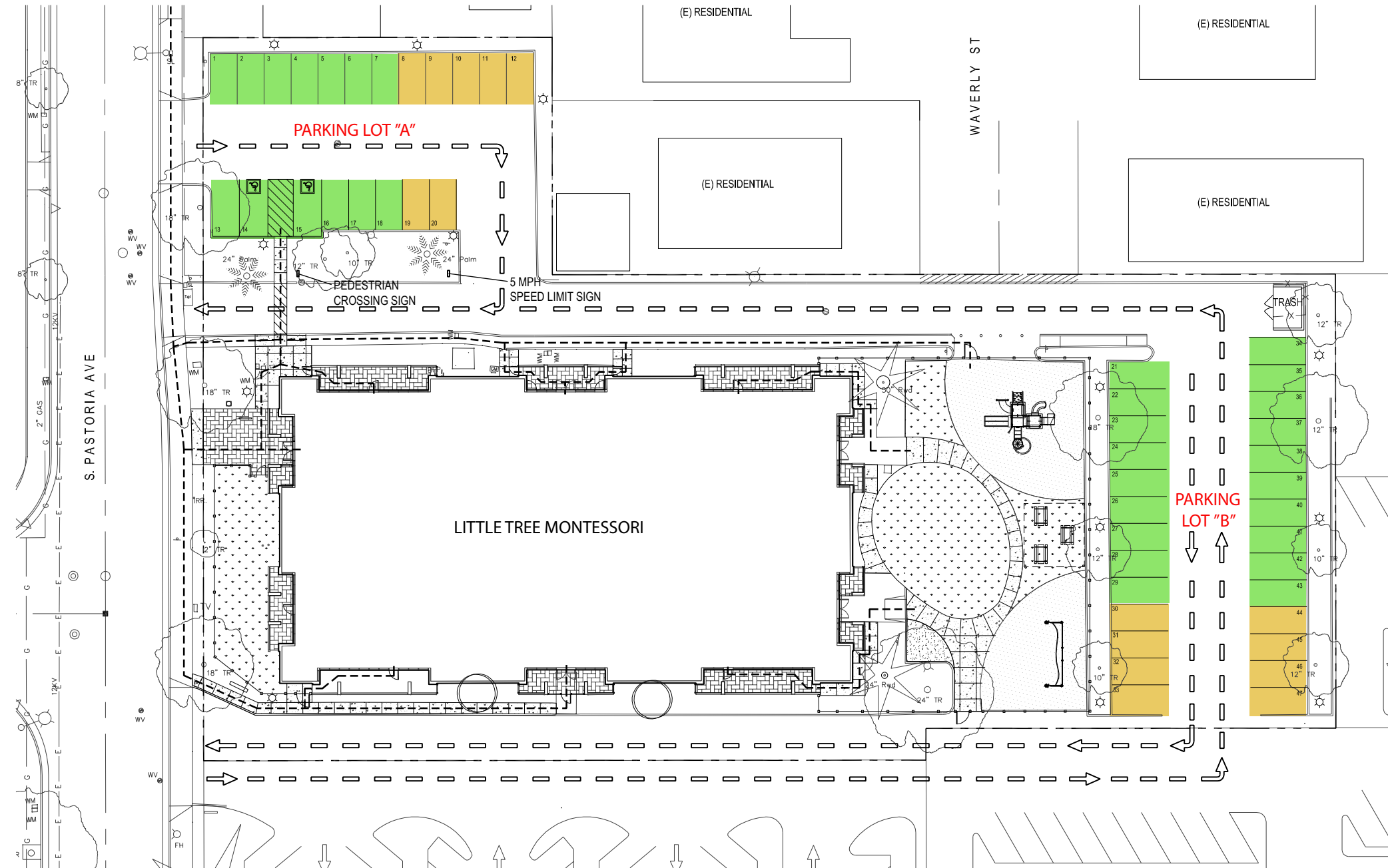

Parking Management Plan - Exhibit A

Legend

- Staff Parking (15)
- Pick up / Drop off Parking (32)