

GYM PARKING SUMMARY

1/16" = 1'-0"

15

SEATING CALCULATION

NET INTERIOR GYM AREA = 10,710 S.F.
TOTAL POSTED MAXIMUM OCCUPANCY = 1,754

	AREA	PARKING RATIO	PARKING REQUIRED
BLEACHER SEATING (1,154 SEATS)	2,994 S.F.	1 PER 3 SEATS	385 STALLS
USEABLE AREA	3,264 S.F.	1 PER 21 S.F.	156 STALLS
OTHER AREA	4,452 S.F.	1 PER 400 S.F.	11 STALLS
EXIT CIRCULATION	2,281 S.F.		
NON-SEATING AREA	731 S.F.		
STAGE	1,440 S.F.		
TOTAL AREA	10,710 S.F.		552 STALLS

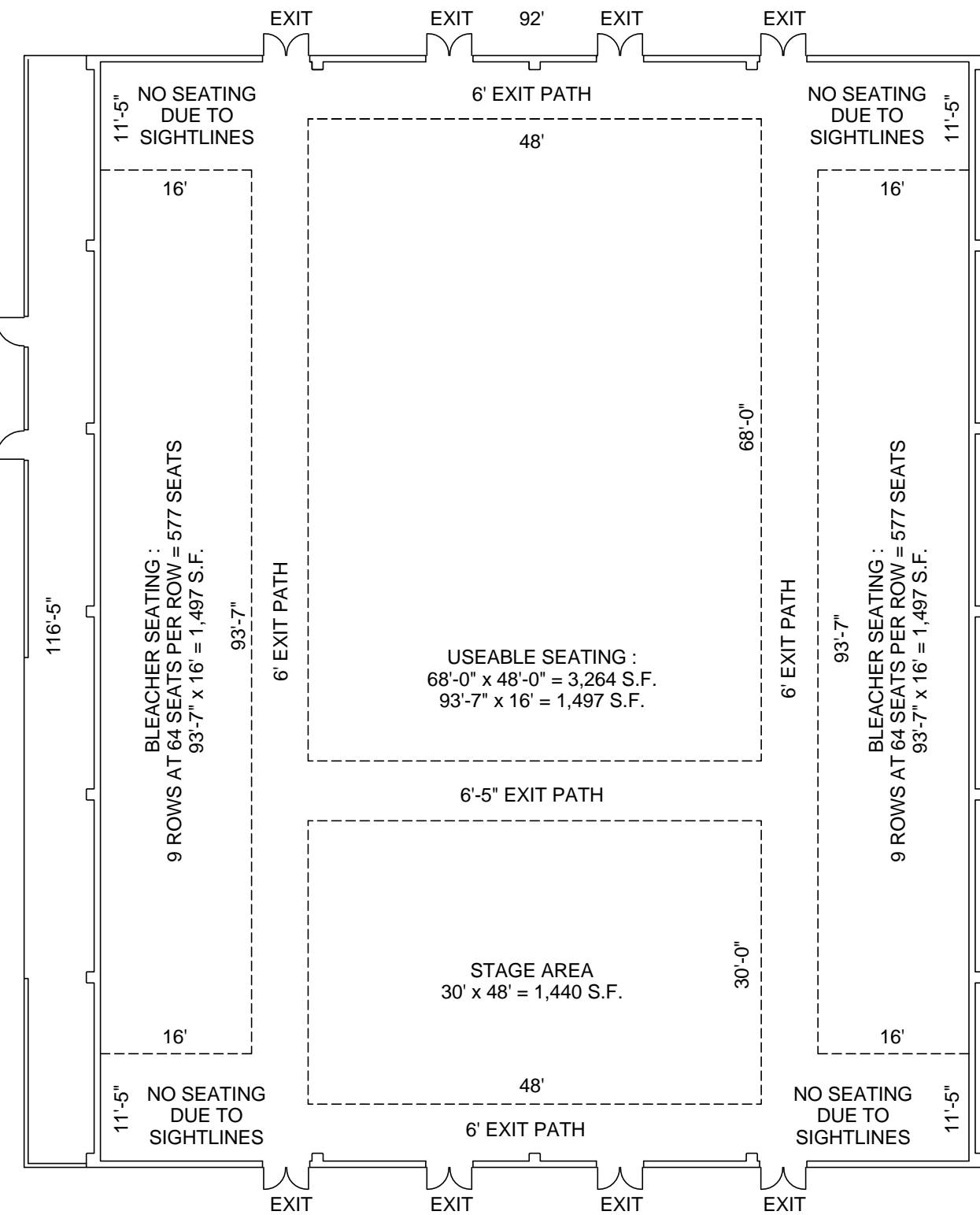

EXISTING PARKING PLAN

DAVE AVENUE

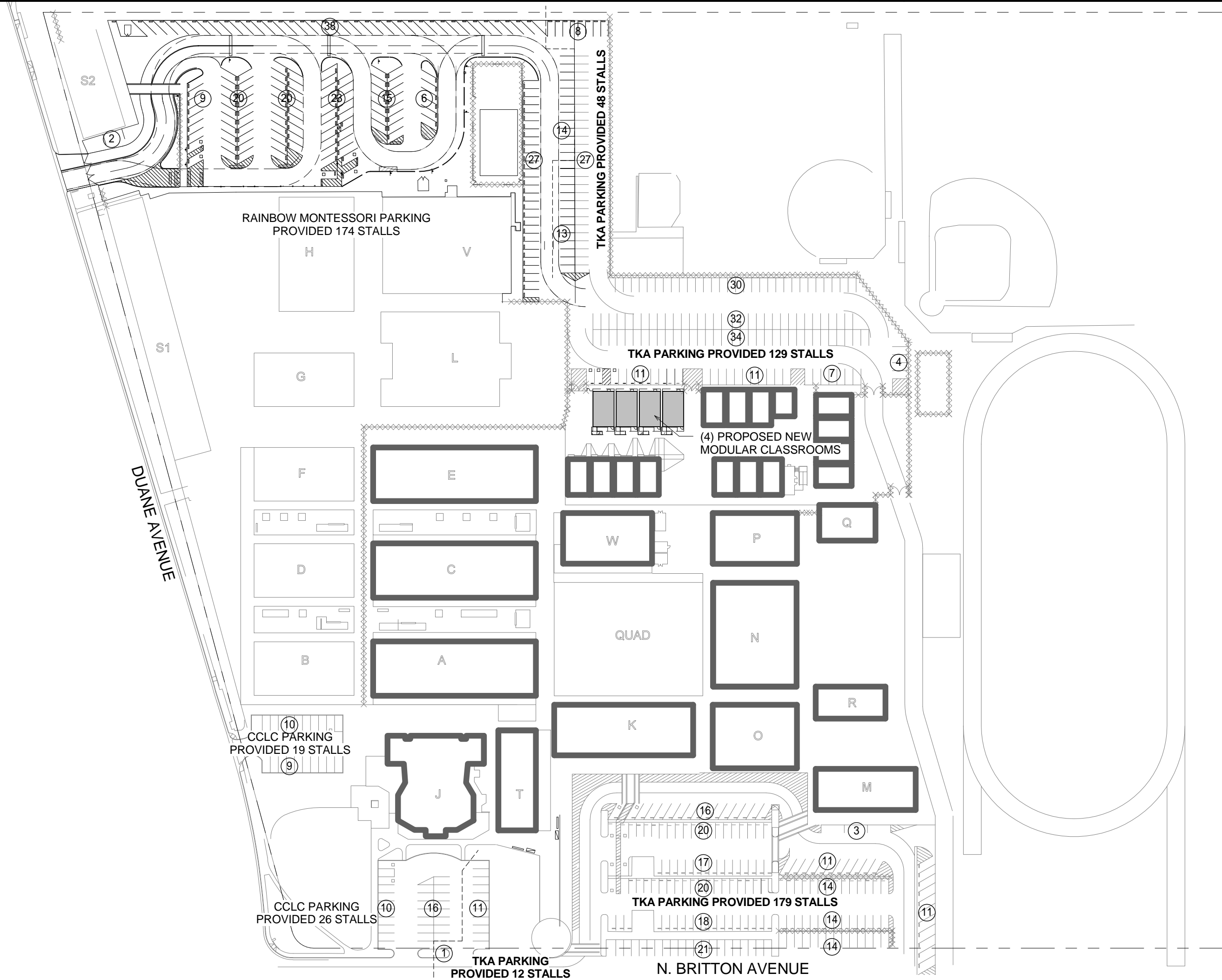

SEE 15 / A0.2

Attachment 5 - Page 2 of 6

PARKING SUMMARY

	PARKING REQUIRED	PARKING PROVIDED
THE KINGS ACADEMY	248 STALLS	368 STALLS
K - 8	60 STALLS	
9 - 12	152 STALLS	
OFFICE STAFF	36 STALLS	
SUB-TOTAL	248 STALLS	
ACCESSORY USES*		
ACCESSORY GYM***	552 STALLS	552 STALLS
ACCESSORY THEATER	52 STALLS	
ACCESSORY FOOTBALL	52 STALLS	
ACCESSORY ASSEMBLY	52 STALLS	
*ACCESSORY USES ARE NOT SCHEDULED CONCURRENTLY		
RAINBOW MONTESSORI **	174 STALLS	174 STALLS
CHILDREN'S LEARNING CENTER **	45 STALLS	45 STALLS
TOTAL	467 STALLS	587 STALLS

**THESE USES DO NOT REQUIRE PARKING AFTER 6:00 PM
***PARKING PROVIDED BASED ON MOST INTENSIVE USE AND THAT USE OCCURS AFTER 6:00 PM WHEN ALL ON-SITE PARKING IS AVAILABLE.00 PM

BICYCLE PARKING REQUIRED
5% x 368 PARKING STALLS - 18.4 BIKE RACKS REQUIRED
21 BIKE RACKS PROVIDED, INCLUDING 4 COVERED BIKE LOCKERS

MILBURN

Architecture, Inc

6049 DOUGLAS BLVD. STE 6, GRANITE BAY, CA 95746

PH: 916 622-3232 FAX: 877 780-1858

PROJECT

TKA MODULAR CLASSROOMS
562 N. BRITTON AVENUE
SUNNYVALE, CA 94085-3841

CLIENT

THE KINGS ACADEMY

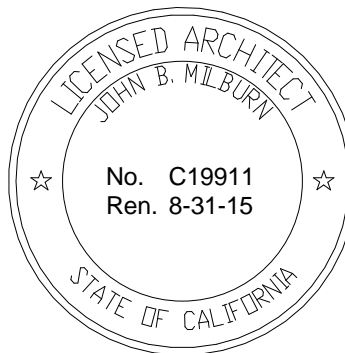

No.	Description	Date

THIS DRAWING EMBODIES DESIGNS, IDEAS, PLANS, ARRANGEMENTS, AND SPECIFICATIONS WHICH ARE PROPRIETARY TO MILBURN ARCHITECTURE, INC., AND WHICH WERE DESIGNED, CREATED, EVOLVED, AND DEVELOPED FOR THE USE SOLELY IN CONNECTION WITH THE SPECIFIED PROJECT. NO TRANSFER OF ANY RIGHTS THERE TO IS INTENDED OR EFFECTED BY DELIVERY THEREOF, AND EXCEPT UPON WRITTEN PERMISSION OF MILBURN ARCHITECTURE, INC., THIS DRAWING IS NOT TO BE REPRODUCED OR COPIED IN WHOLE OR PART, OR USED IN THE FABRICATION OR CONSTRUCTION OF BUILDINGS, STRUCTURES, OR ANY PORTIONS THEREOF FOR OTHER THAN THE SPECIFIED PROJECT.

COPYRIGHT 2015 MILBURN ARCHITECTURE, INCORPORATED

PARKING ANALYSIS

JOB NO : 1322

DATE : 06-03-15

DRAWN : JBM

CHECK : -

SHEET NO.

A0.2

OF

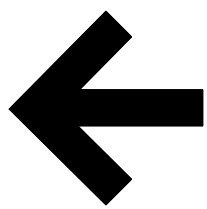

1" = 100'-0"

4

3" = 1'-0"

PARKING SUMMARY

12" = 1'-0"

2

MILBURN

Architecture, Inc
6049 DOUGLAS BLVD. STE 6, GRANITE BAY, CA 95746
PH: 916 622-3232 FAX: 877 780-1858

PROJECT

TKA MODULAR CLASSROOMS
562 N. BRITTON AVENUE
SUNNYVALE, CA 94085-3841

CLIENT

THE KINGS ACADEMY

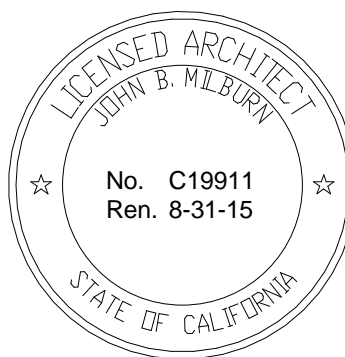

No.	Description	Date

THIS DRAWING EMBODIES DESIGNS, IDEAS, PLANS, ARRANGEMENTS, AND SPECIFICATIONS WHICH ARE PROPRIETARY TO MILBURN ARCHITECTURE, INC., AND WHICH WERE DESIGNED, CREATED, EVOLVED, AND DEVELOPED FOR THE USE SOLELY IN CONNECTION WITH THE SPECIFIED PROJECT. NO TRANSFER OF ANY RIGHTS THERE TO IS INTENDED OR EFFECTED BY DELIVERY THEREOF, AND EXCEPT UPON WRITTEN PERMISSION OF MILBURN ARCHITECTURE, INC., THIS DRAWING IS NOT TO BE REPRODUCED OR COPIED IN WHOLE OR PART, OR USED IN THE FABRICATION OR CONSTRUCTION OF BUILDINGS, STRUCTURES, OR ANY PORTIONS THEREOF FOR OTHER THAN THE SPECIFIED PROJECT.

COPYRIGHT 2015 MILBURN ARCHITECTURE, INCORPORATED

FIRE ACCESS SITE PLAN

JOB NO : 1322
DATE : 06-03-15
DRAWN : JBM
CHECK : -

SHEET NO.
A0.5
OF

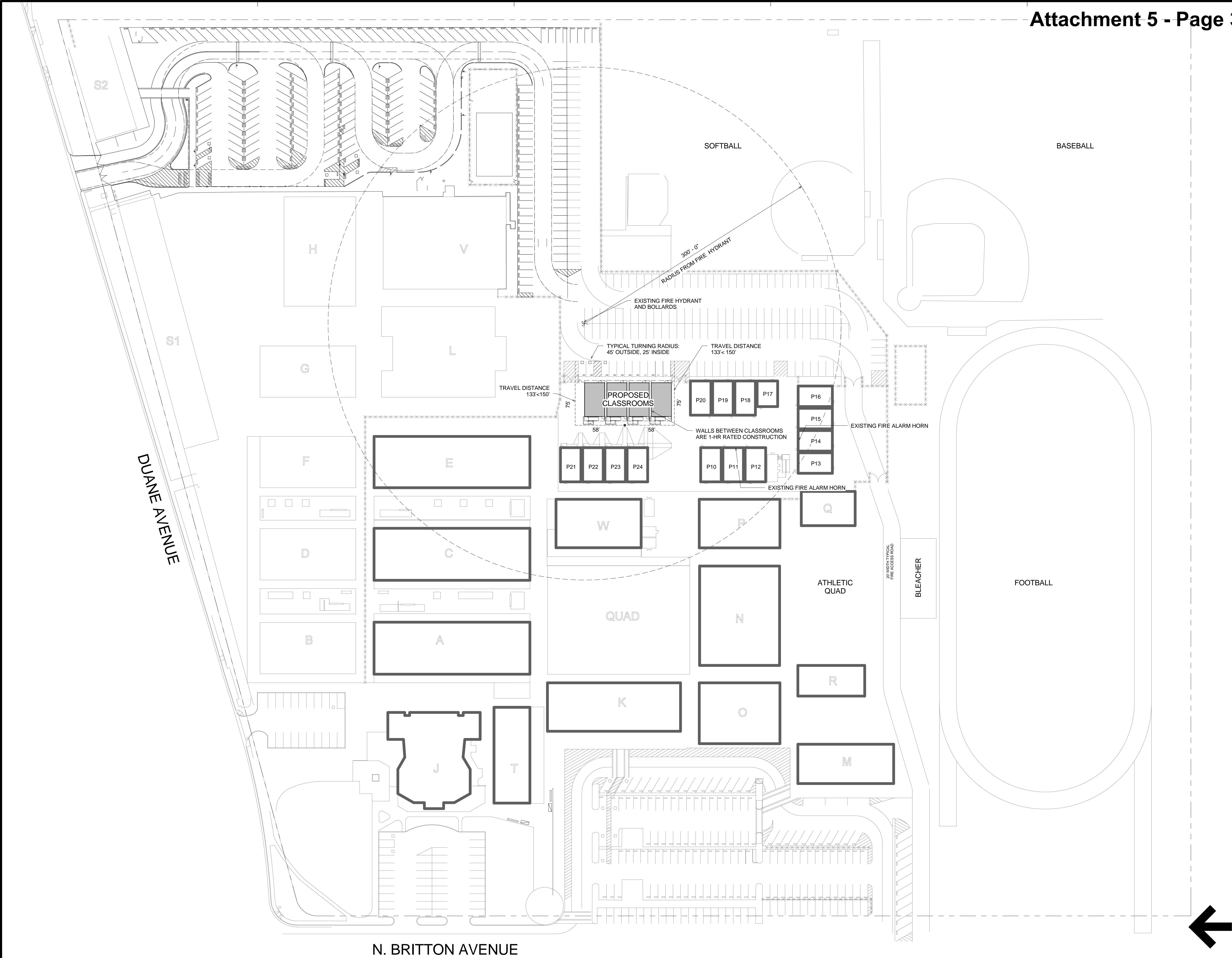

MILBURN

Architecture, Inc
6049 DOUGLAS BLVD. STE 6, GRANITE BAY, CA 95746
PH: 916 622-3232 FAX: 877 780-1858

PROJECT

TKA MODULAR CLASSROOMS
562 N. BRITTON AVENUE
SUNNYVALE, CA 94085-3841

CLIENT

THE KINGS ACADEMY

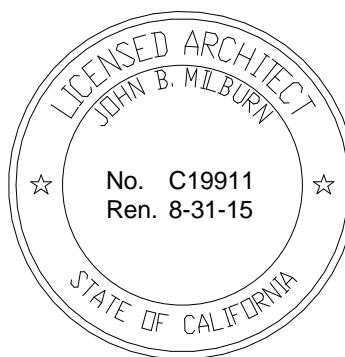

No.	Description	Date

THIS DRAWING EMBODIES DESIGNS, IDEAS, PLANS, ARRANGEMENTS, AND SPECIFICATIONS WHICH ARE PROPRIETARY TO MILBURN ARCHITECTURE, INC., AND WHICH WERE DESIGNED, CREATED, EVOLVED, AND DEVELOPED FOR THE USE SOLELY IN CONNECTION WITH THE SPECIFIED PROJECT. NO TRANSFER OF ANY RIGHTS THERE TO IS INTENDED OR EFFECTED BY DELIVERY THEREOF, AND EXCEPT UPON WRITTEN PERMISSION OF MILBURN ARCHITECTURE, INC., THIS DRAWING IS NOT TO BE REPRODUCED OR COPIED IN WHOLE OR PART, OR USED IN THE FABRICATION OR CONSTRUCTION OF BUILDINGS, STRUCTURES, OR ANY PORTIONS THEREOF FOR OTHER THAN THE SPECIFIED PROJECT.

COPYRIGHT 2015 MILBURN ARCHITECTURE, INCORPORATED

SITE PLAN

JOB NO : 1322
DATE : 06-03-15
DRAWN : JBM
CHECK : -

SHEET NO.
A1.1
OF

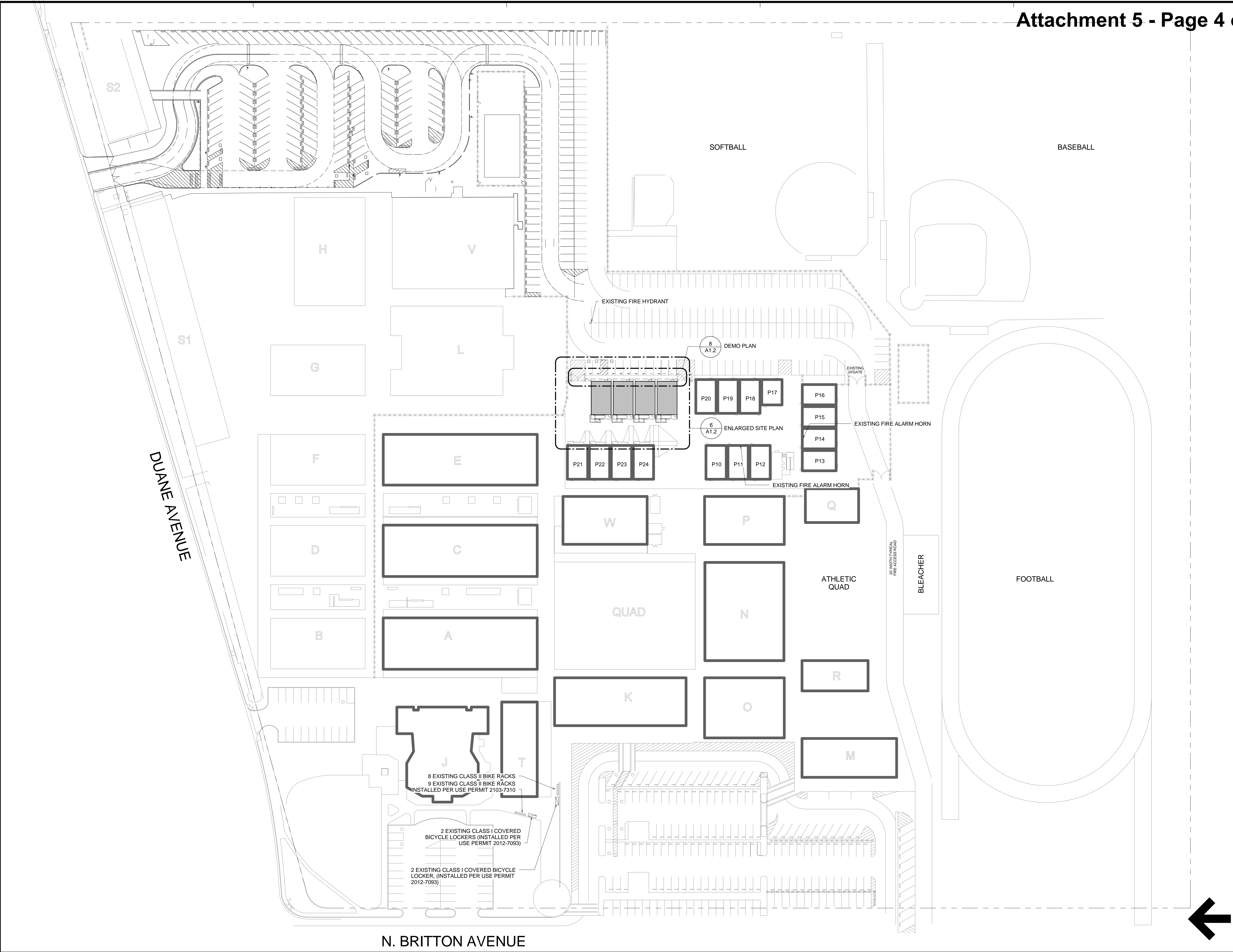

OVERALL SITE PLAN

1" = 50'-0"

- PLAN KEY NOTES
- A NEW 6'-0" CHAIN LINK FENCE AND 36" CLEAR CHAIN LINK GATE. PROVIDE EXIT DEVICE AND CLOSER SALVAGED FROM ABANDONED GATE.
 - B PREFABRICATED METAL ADA COMPLIANT RAMP
 - C CONCRETE LANDING AND RAMP EXTENSION TO EXISTING GRADE, SEE 3 / A1.3
 - D NEW PARKING BUMPER, SEE 18 / A5.1
 - E RESTRIPE PARKING, 4" WIDE WHITE TRAFFIC PAINT
 - F 1-HOUR RATED WALL, SEE 12 / A0.1
 - G EXISTING 1:20 RAMP TRANSITION
 - H EXISTING GATE
 - J CLOSE OFF GAP BETWEEN GATE POST AND MODULAR CLASSROOM WITH CHAIN LINK FENCE FABRIC

PLAN KEY NOTES

12" = 1'-0" 1

PROJECT

TKA MODULAR CLASSROOMS
562 N. BRITTON AVENUE
SUNNYVALE, CA 94085-3841

CLIENT

THE KINGS ACADEMY

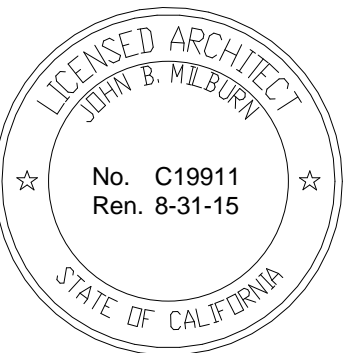

No.	Description	Date

THIS DRAWING EMBODIES DESIGNS, IDEAS, PLANS, ARRANGEMENTS, AND SPECIFICATIONS WHICH ARE PROPRIETARY TO MILBURN ARCHITECTURE, INC., AND WHICH WERE DESIGNED, CREATED, EVOLVED, AND DEVELOPED FOR THE USE SOLELY IN CONNECTION WITH THE SPECIFIED PROJECT. NO TRANSFER OF ANY RIGHTS THERE TO IS INTENDED OR EFFECTED BY DELIVERY THEREOF, AND EXCEPT UPON WRITTEN PERMISSION OF MILBURN ARCHITECTURE, INC. THIS DRAWING IS NOT TO BE REPRODUCED OR COPIED IN WHOLE OR PART, OR USED IN THE FABRICATION OR CONSTRUCTION OF BUILDINGS, STRUCTURES, OR ANY PORTIONS THEREOF FOR OTHER THAN THE SPECIFIED PROJECT.

COPYRIGHT 2015 MILBURN ARCHITECTURE, INCORPORATED

ENLARGED SITE PLAN

JOB NO : 1322

DATE : 06-03-15

DRAWN : JBM

CHECK : -

SHEET NO.

A1.2

OF

PLAN KEY NOTES

12" = 1'-0" 4

- ENLARGED SITE PLAN KEYNOTES
- A REMOVE EXISTING CHAIN LINK FENCE AND POSTS.
 - B BLACK OUT ACCESSIBLE PARKING STRIPING AND SYMBOL. REMOVE SIGNAGE AND SALVAGE FOR ELOCATION TO NEW ACCESSIBLE PARKING STALLS
 - C SALVAGE GATE, GATE FRAME, CLOSER, AND EXIT DEVICE AND RELOCATE TO NEW LOCATION, SEE PLAN

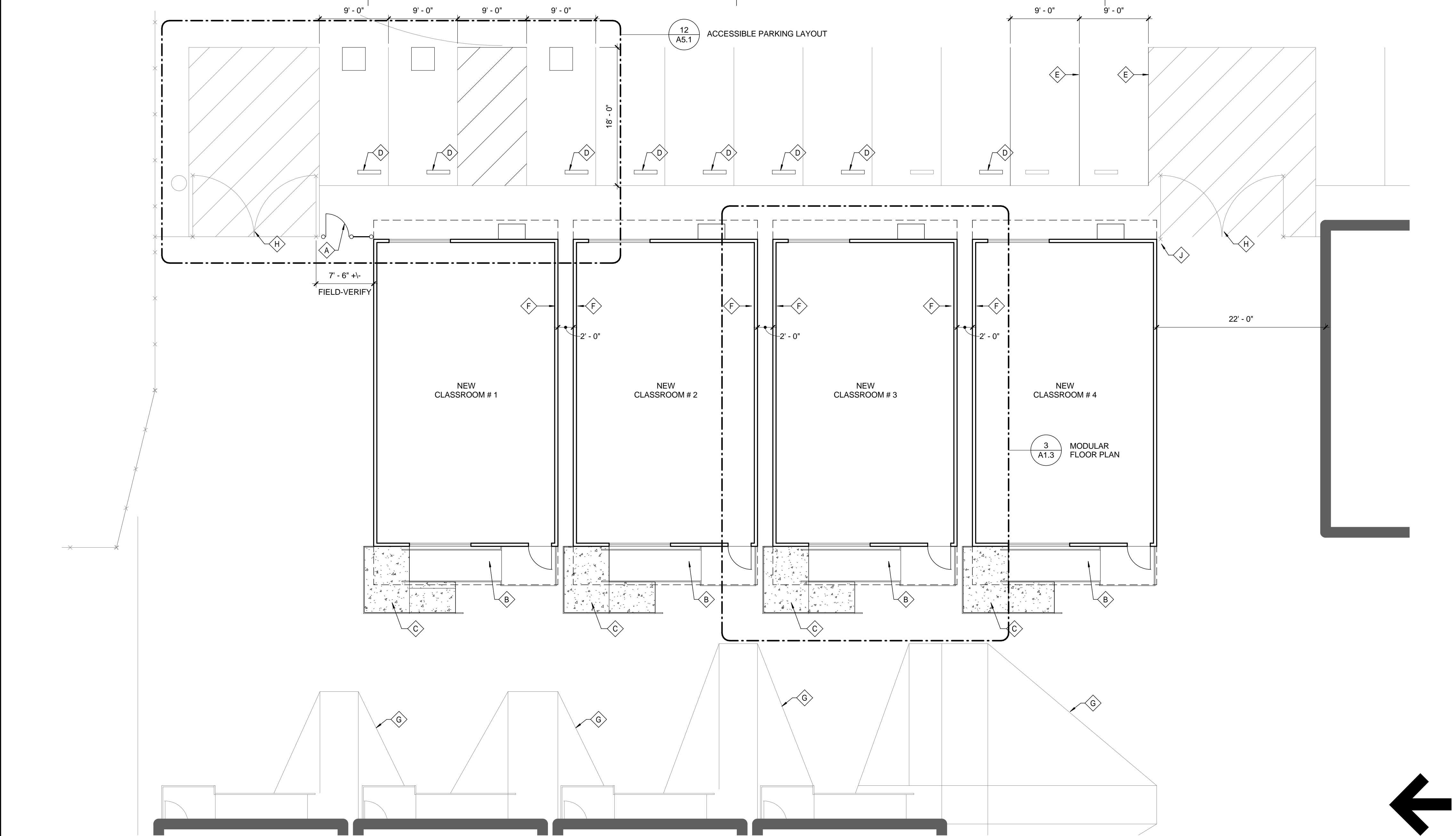

ENLARGED SITE PLAN

1/8" = 1'-0" 6

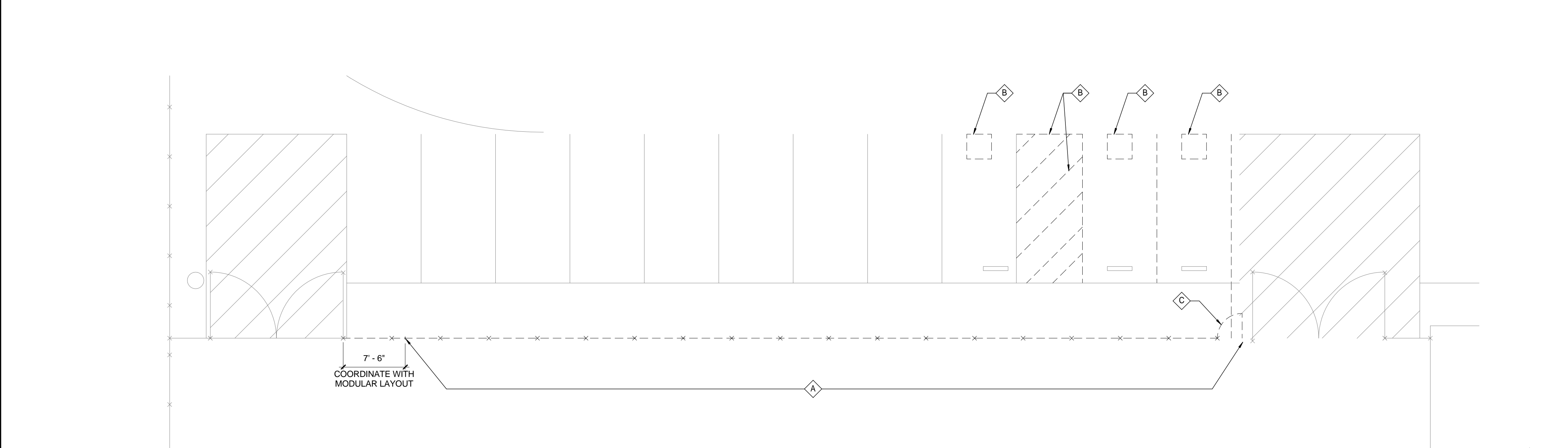

ENLARGED DEMO SITE PLAN

1/8" = 1'-0" 8

MILBURN

Architecture, Inc

6049 DOUGLAS BLVD. STE 6, GRANITE BAY, CA 95746

PH: 916 622-3232 FAX: 877 780-1858

PROJECT

TKA MODULAR CLASSROOMS
562 N. BRITTON AVENUE
SUNNYVALE, CA 94085-3841

CLIENT

THE KINGS ACADEMY

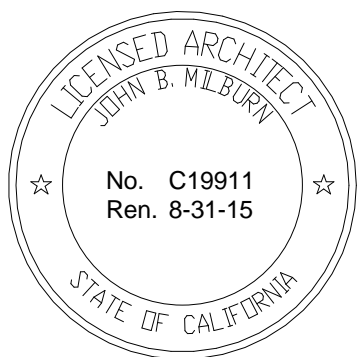

No.	Description	Date

THIS DRAWING EMBODIES DESIGNS, IDEAS, PLANS, ARRANGEMENTS, AND SPECIFICATIONS WHICH ARE PROPRIETARY TO MILBURN ARCHITECTURE, INC., AND WHICH WERE DESIGNED, CREATED, EVOLVED, AND DEVELOPED FOR THE USE SOLELY IN CONNECTION WITH THE SPECIFIED PROJECT. NO TRANSFER OF ANY RIGHTS THERE TO IS INTENDED OR EFFECTED BY DELIVERY THERE OF, AND EXCEPT UPON WRITTEN PERMISSION OF MILBURN ARCHITECTURE, INC. THIS DRAWING IS NOT TO BE REPRODUCED OR COPIED IN WHOLE OR PART, OR USED IN THE FABRICATION OR CONSTRUCTION OF BUILDINGS, STRUCTURES, OR ANY PORTIONS THERE OF FOR OTHER THAN THE SPECIFIED PROJECT.

COPYRIGHT 2015 MILBURN ARCHITECTURE, INCORPORATED

FLOOR PLAN

JOB NO : 1322	SHEET NO.
DATE : 06-03-15	A1.3
DRAWN : JBM	OF
CHECK : -	

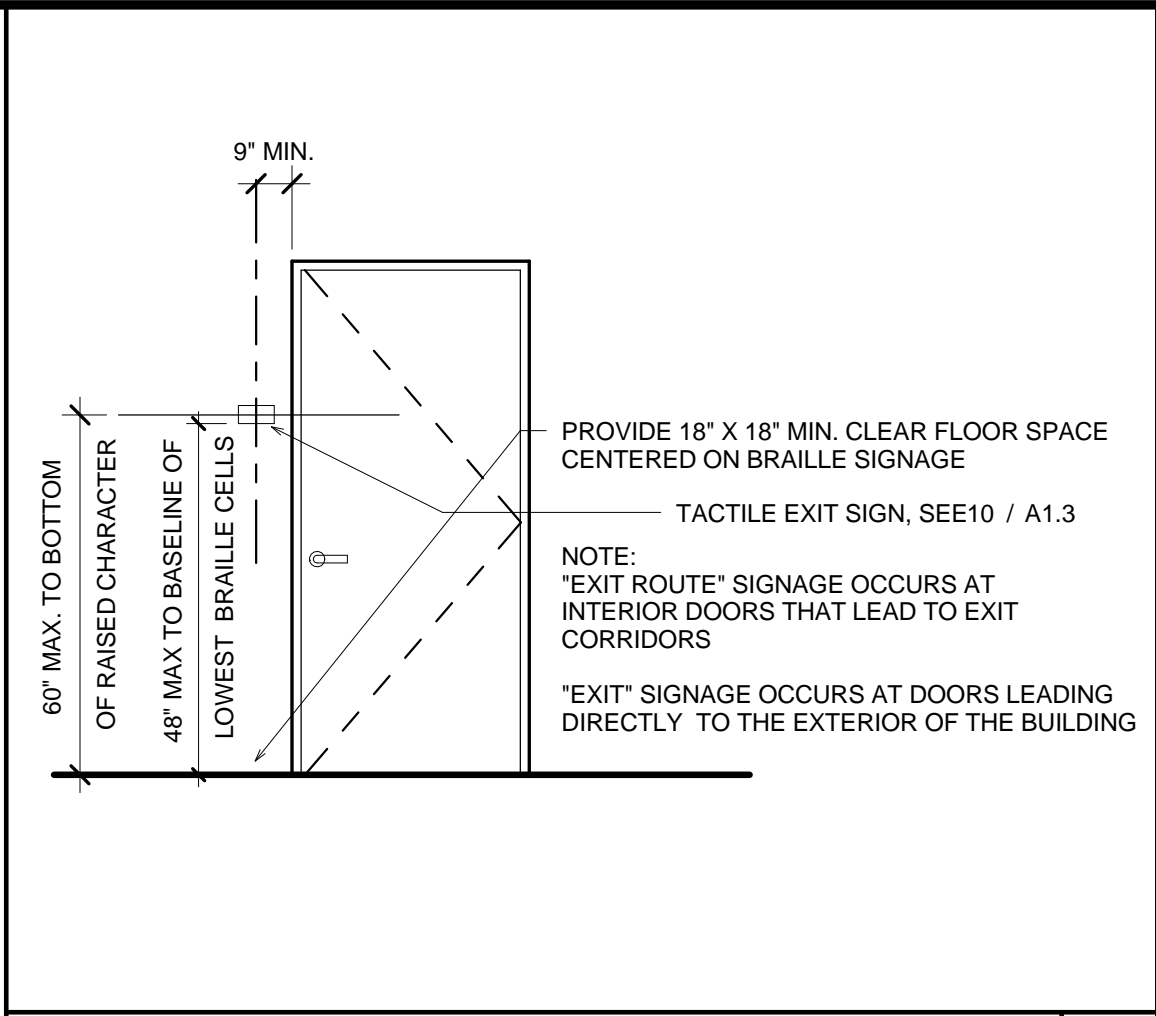

EXIT SIGNAGE 3/8" = 1'-0" 9

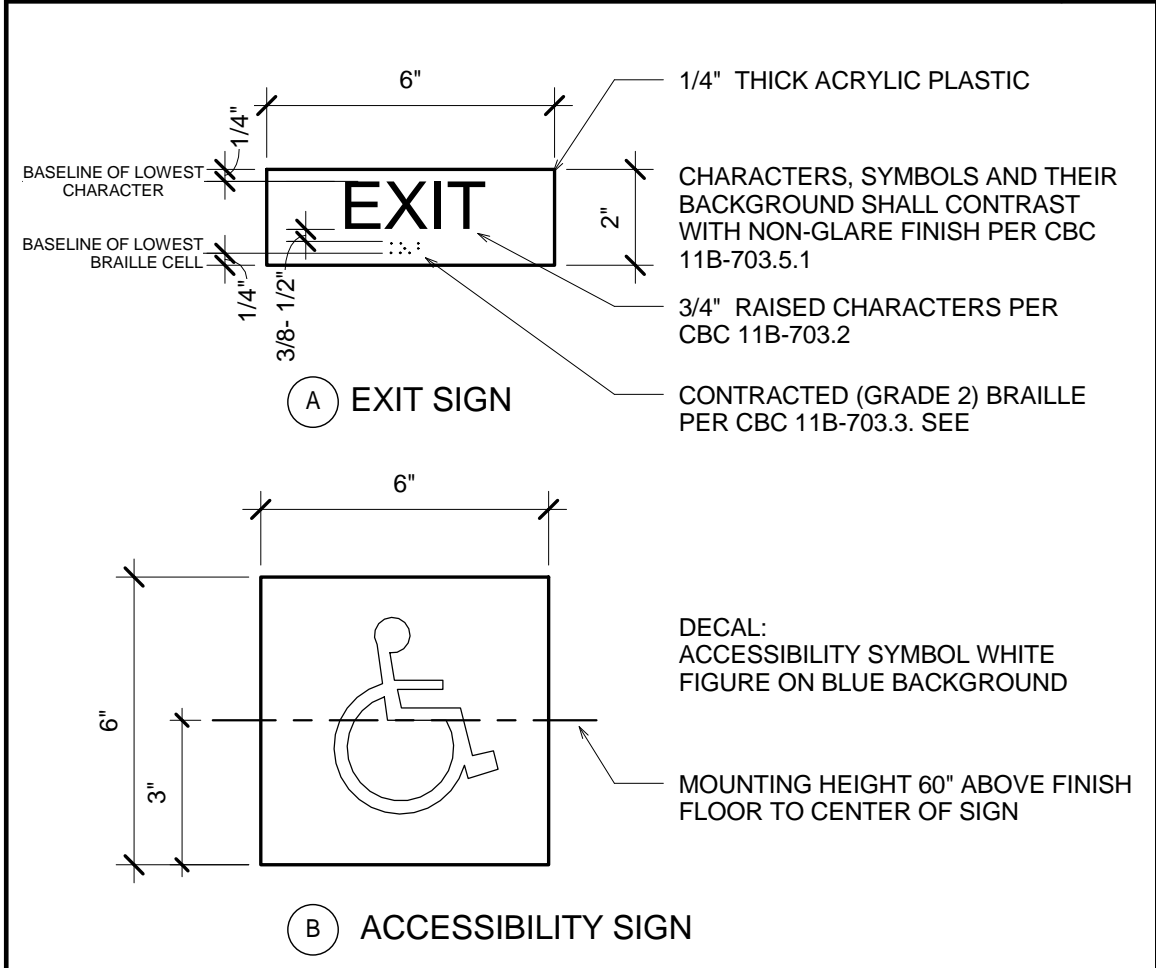

ENTRANCE SIGNAGE 3" = 1'-0" 10

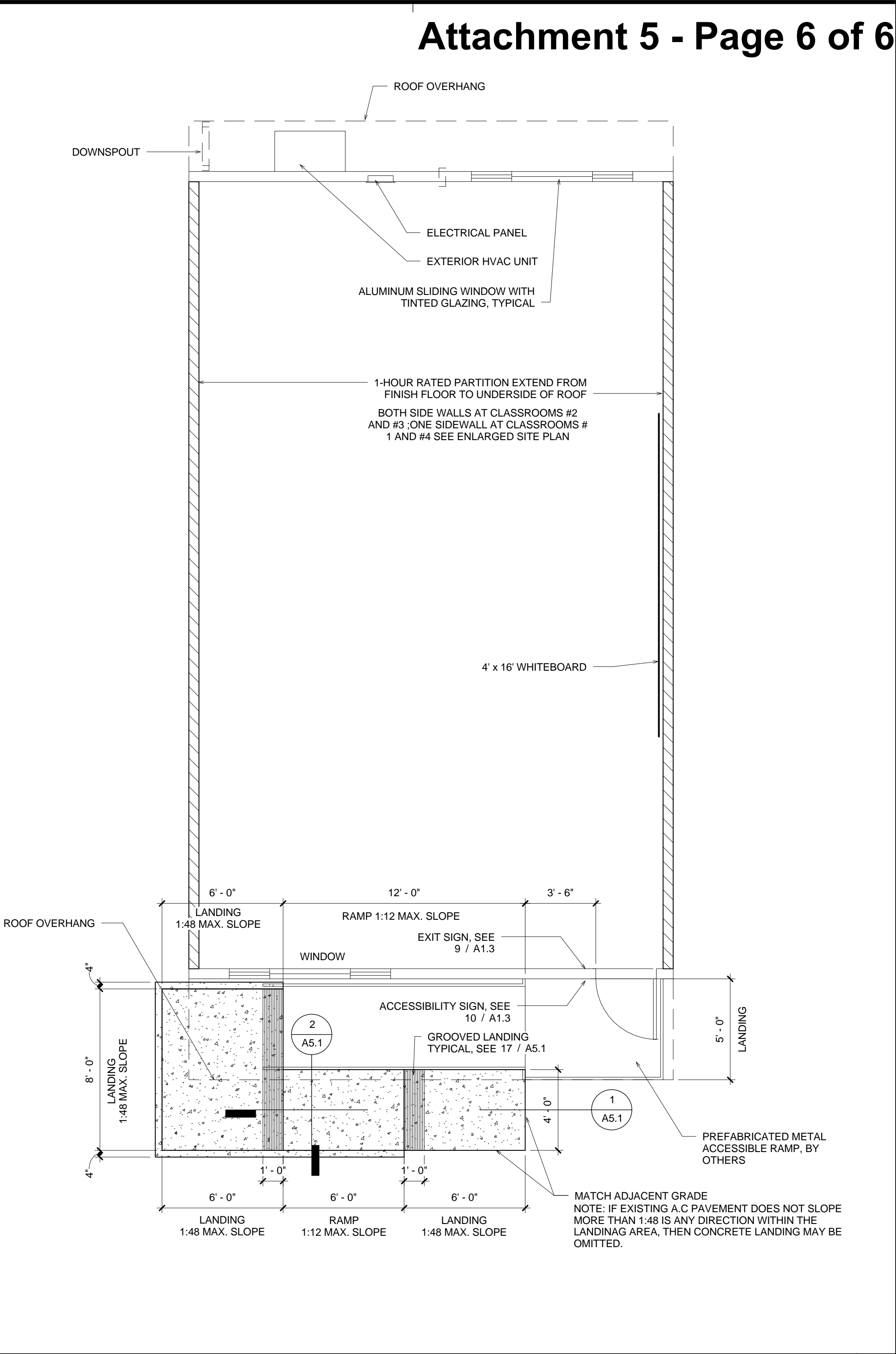

MODULAR FLOOR PLAN 1/4" = 1'-0" 3

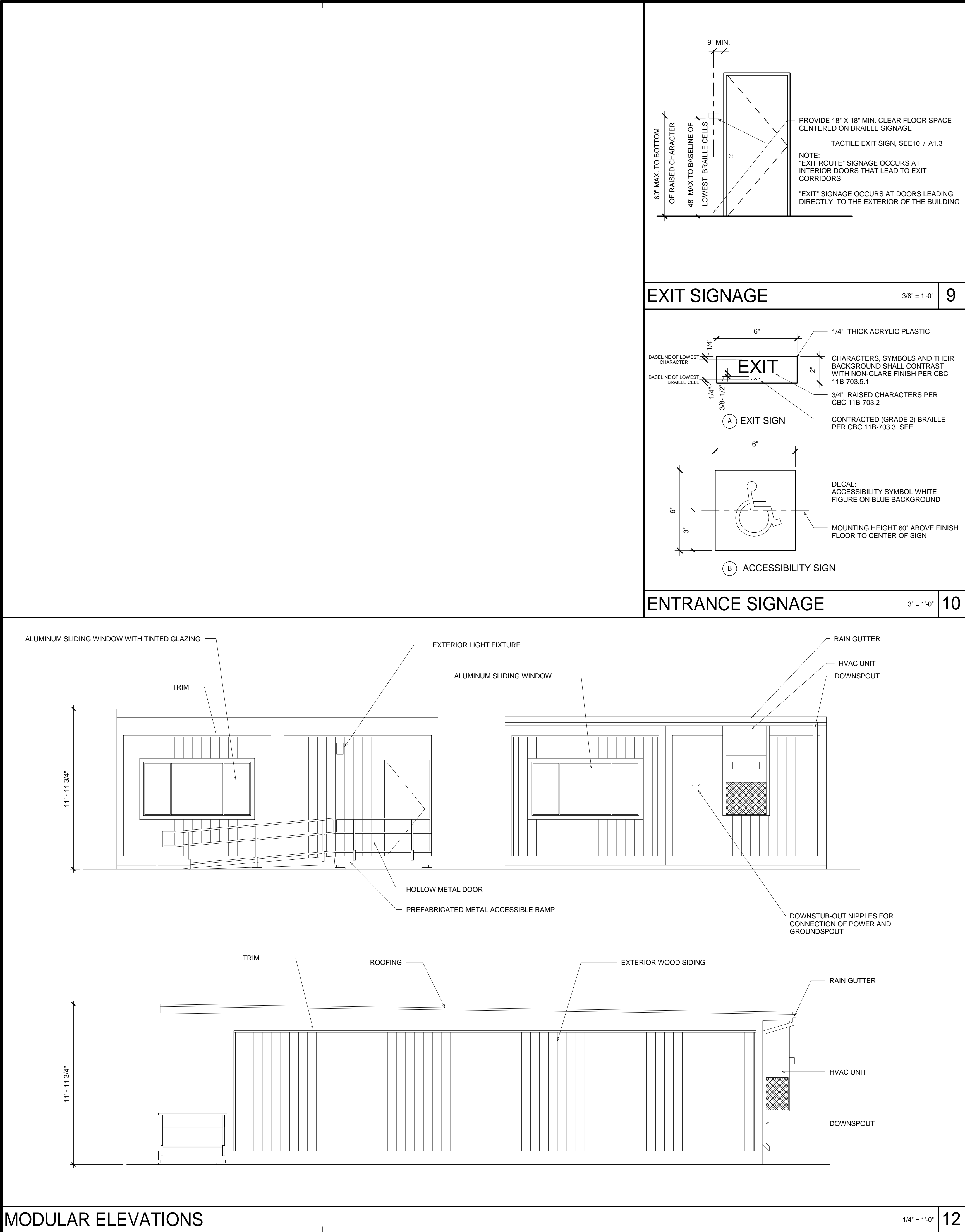

MODULAR ELEVATIONS 1/4" = 1'-0" 12