



Sunnyvale

Bordeaux Drive Bicycle and Pedestrian Facility Improvements

Lillian Tsang, P.E.
Principal Transportation Engineer
June 20, 2019



Project Overview

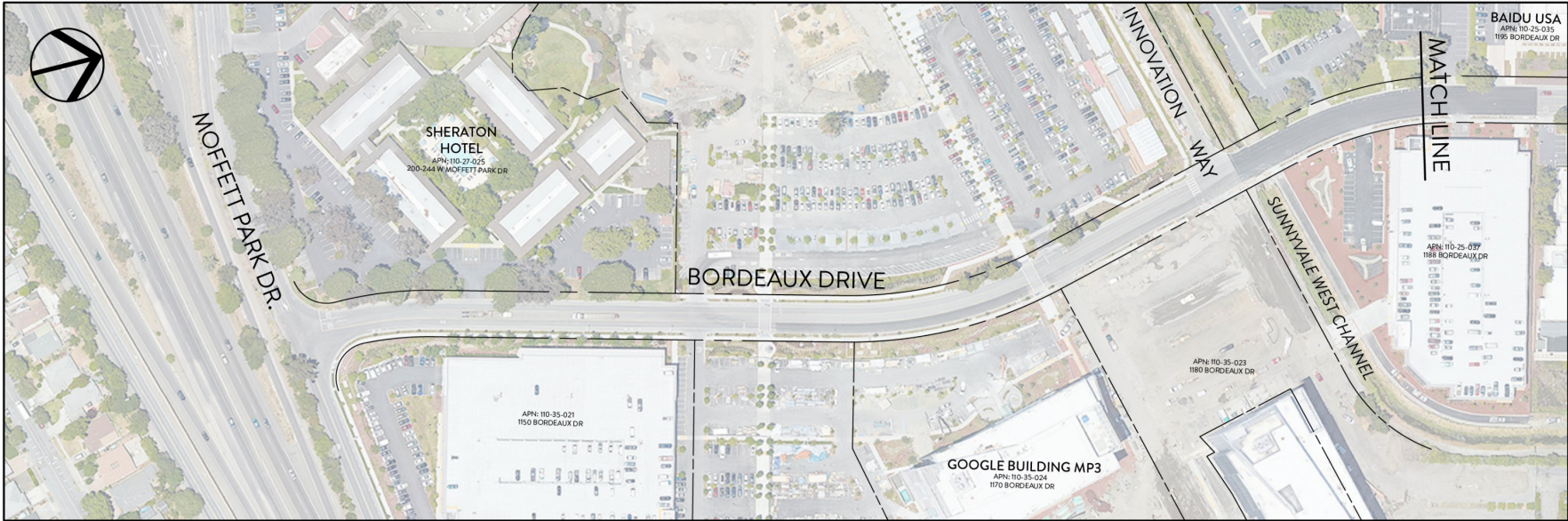

Project Overview

- Bordeaux Drive
 - ◆ Between Moffett Park Drive & N. Mathilda Avenue
- Improve Bicycle and Pedestrian Connectivity
 - ◆ Install Bike Lanes
 - ◆ Close Sidewalk Gaps
- Consistent with the improvements identified in the 2006 Sunnyvale Bicycle Plan – remove on-street parking to install bike lanes

Bordeaux Drive Cross Section

Moffett Park Drive to W. Java Drive

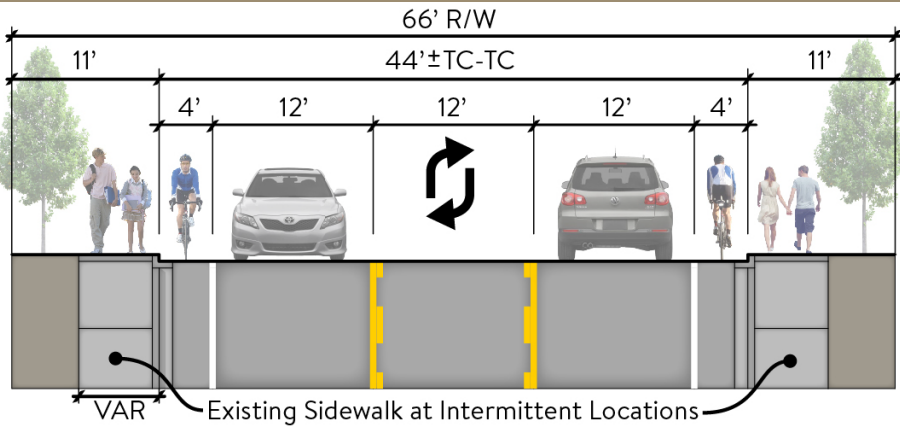

Existing
Conditions

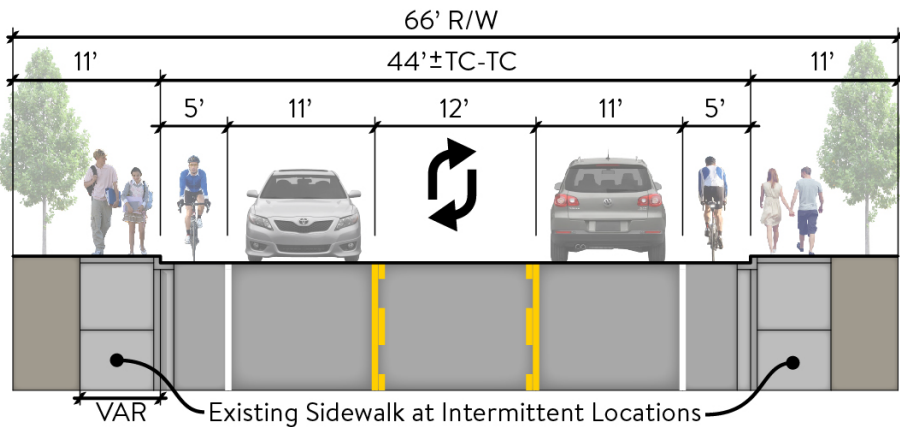

Proposed
Conditions

W. Java Drive to N. Mathilda Avenue

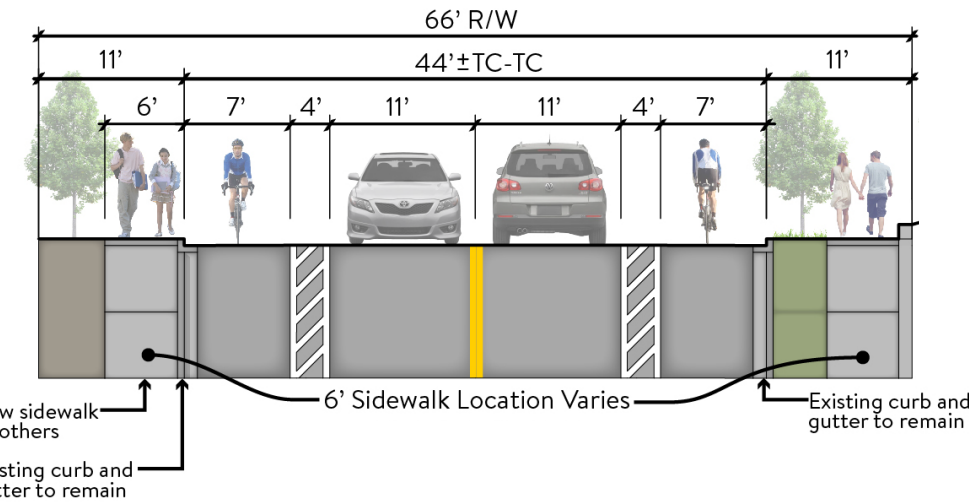
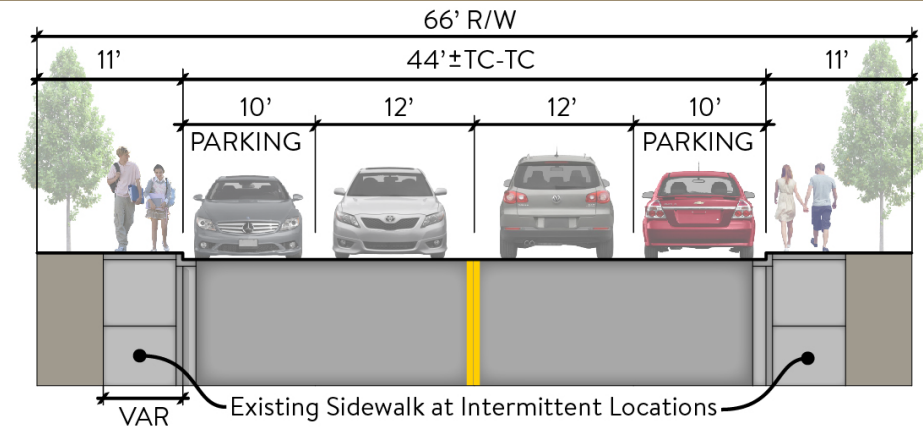

Bordeaux Drive - Proposed Improvements

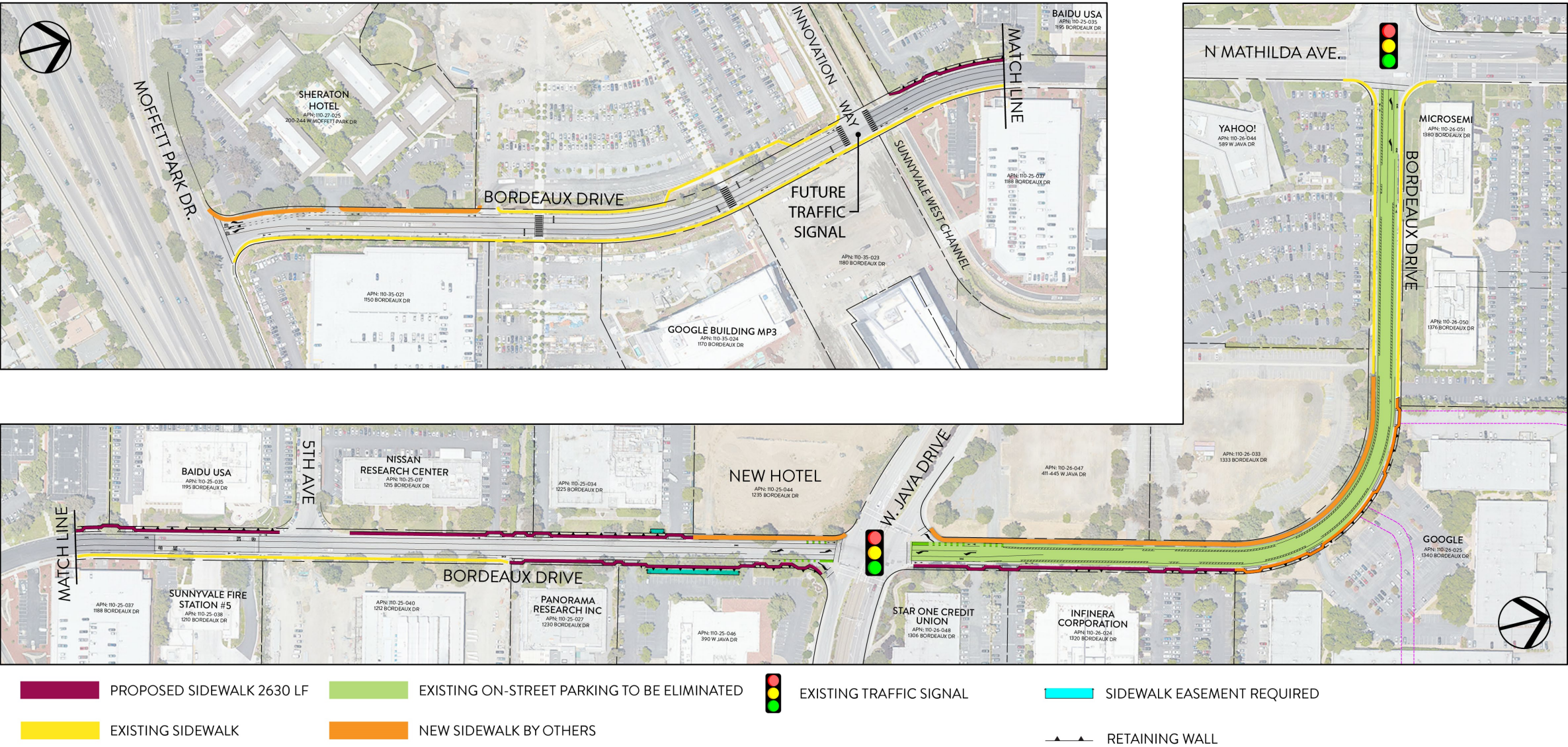

Bordeaux Drive – W. Java Drive to N. Mathilda Avenue

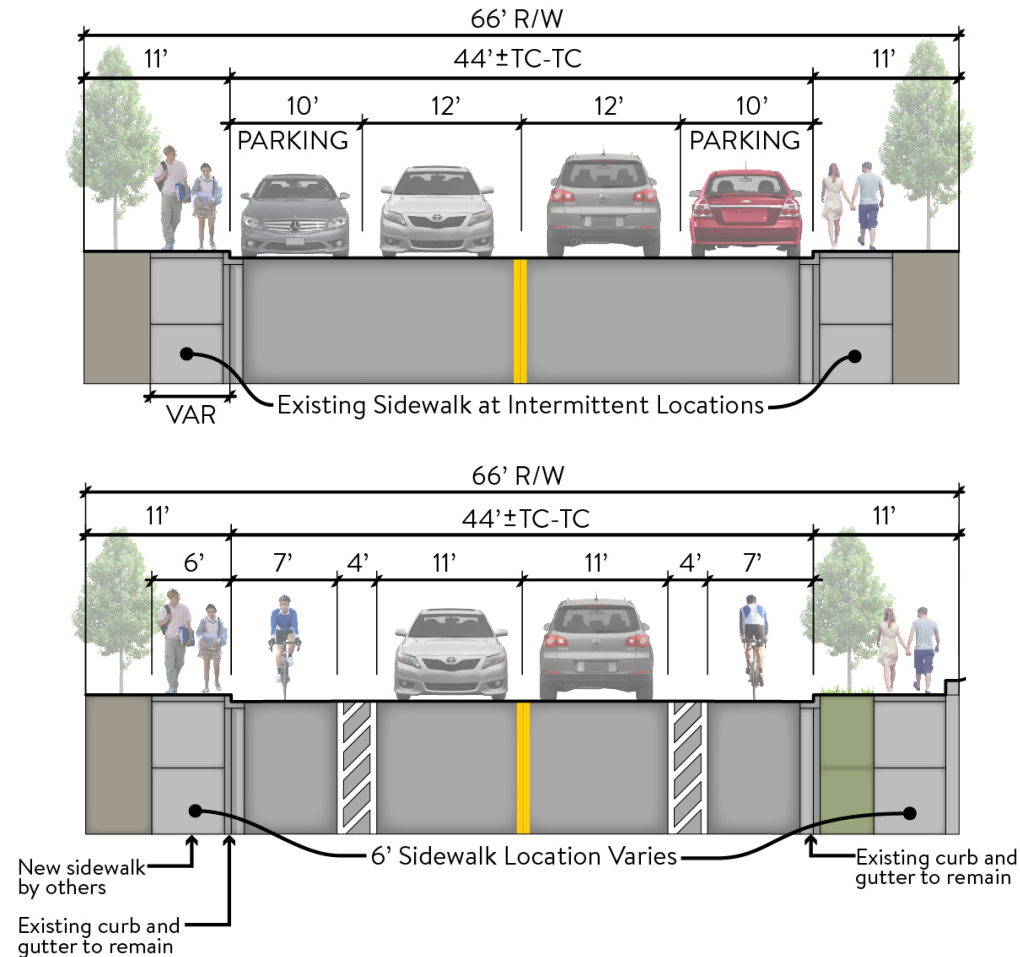

- Proposed Improvements
 - ◆ Require Removal of On-Street Parking
 - ◆ Existing On-street Parking Spaces: 107
- Parking Study
 - ◆ Conducted on Wednesday March 27, 2018
 - ◆ Between 6am and 7pm

Bordeaux Drive – W. Java Drive to N. Mathilda Avenue

Parking Study Methodology

- 8 Parcels
- Parking Study
 - ◆ Wednesday March 27, 2018
 - ◆ Between 6am and 7pm
 - ◆ Recorded in 30-minute Intervals
 - On-Street Parking:
 - ◆ Number of vehicles parked
 - Parking Lots in the 8 parcels:
 - ◆ Number of vacant spaces
 - ◆ Number of occupied spaces



Bordeaux Drive – W. Java Drive to N. Mathilda Avenue Parking Study Summary

	Peak 30-Minute Interval	# Spaces Available	# Spaces Occupied	# Spaces Vacant	% Vacant
On-Street Parking	2:30 PM – 3:00 PM	107	34	73	68.2%
Off-Street Parking (8 Parcels Total)	2:00 PM – 2:30 PM	1,742	693	1,049	60.2%
Parcel 110-26-048 (Star One Credit Union)	10:00 AM – 10:30 AM	136	113	23	16.9%

- Excess Vacant Spaces Available
 - ◆ Both On-Street & Off-Street
- Off-Street Parking supply shall accommodate all On-Street Parking demand

Questions

Questions?

Project Contact:

Lillian Tsang, City of Sunnyvale Department of Public Works

Ltsang@Sunnyvale.ca.gov

408-730-7556