



275 N MATHILDA: ART PROGRAM

Sunnyvale, California | Arts Commission

October 16, 2019

 **IRVINE COMPANY**
Since 1864

275 N MATHILDA PROJECT OVERVIEW



- Single office building campus offering 123K SF of innovative workspace
- Walking distance to Sunnyvale Caltrain station and immediate freeway access
- Modern architecture with rooftop patios and inviting site landscape
- Situated on 3.5 acres
- 4-story building with separate parking structure



ART PROGRAM: THE ARTIST – JON KRAWCZYK



Jon Krawczyk pushes the boundaries of his medium by transforming steel and bronze into a study of the human condition. Lauded for his ability to turn metal into large scale biomorphic sculptures that have the ability to strike one as having their own ubiquitous presence. Krawczyk draws inspiration from renowned modern masters such as Pablo Picasso, Joan Miró, Henry Moore and David Smith. He is not only influenced by the obviously masterful techniques of these artists, but also by the philosophical tenets of their sculpture practice.

His work has a conceptual side that dovetails with the physicality of making art and the objects that result from that material action, i.e. energy and matter. Krawczyk cuts, pounds and welds sheets of bronze and stainless steel to fabricate smooth, monolithic forms that look as though they were carved by a samurai slicing clay. At the same time, the highly polished sculptural profiles of his “Smoke” and “Glacé” series suggest raw stone yet evoke vaporous shapes and melting ice. There are echoes of Isamu Noguchi in this work, as it sits at the intersection of natural and manmade forms. Traces of Henri Moore can be found in a consistent concern with volume and abstract figuration.



ART PROGRAM: SITE MAP

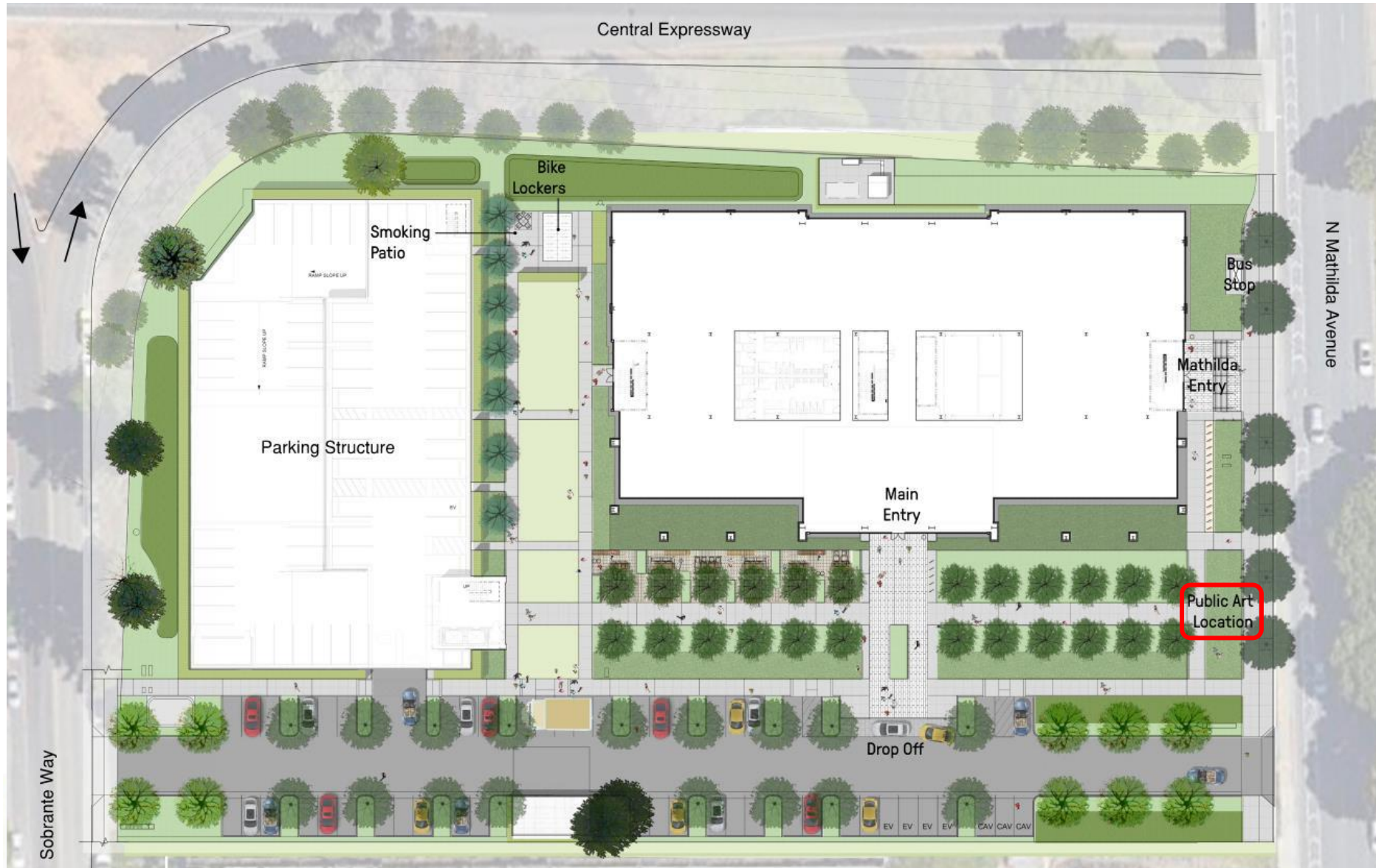

ART PROGRAM: SCULPTURE NARRATIVE



‘Castleton’, named after a natural rock formation in Moab, Utah, is an organic monolith almost like an iceberg or rock you might find in a deserted landscape. This commissioned art is large enough to stand out in the landscape but not too large as to over power it; the height and materiality are contrasted by lush green landscaping that frame the art and accompanying plaque for pedestrians to learn and admire. The smooth natural stainless steel finish will have the beauty of the reflected colors of the landscape. In its details, metal carve outs create natural angles highlighted by light and dark surfaces. As one moves around the sculpture varying surfaces come alive in reflections as the sun moves throughout the day. ‘Castleton’ has the feel of a majestic form that juxtaposes soft fluid curves with lyrical but strong carvings. Polished metal finishes of the sculpture resemble the metal and glass materials used in the office building architecture, creating a playful interaction and connection between the building and artform.



15' H x 4' W x 4' D

ART PROGRAM: RENDERINGS



ART PROGRAM: RENDERINGS



ART PROGRAM: RENDERINGS

