



Sunnyvale

# Sunnyvale Cleanwater Program:

Cleanwater Center and Plant  
Rehabilitation Update

Council Study Session  
November 10, 2020



# Sunnyvale Cleanwater Program

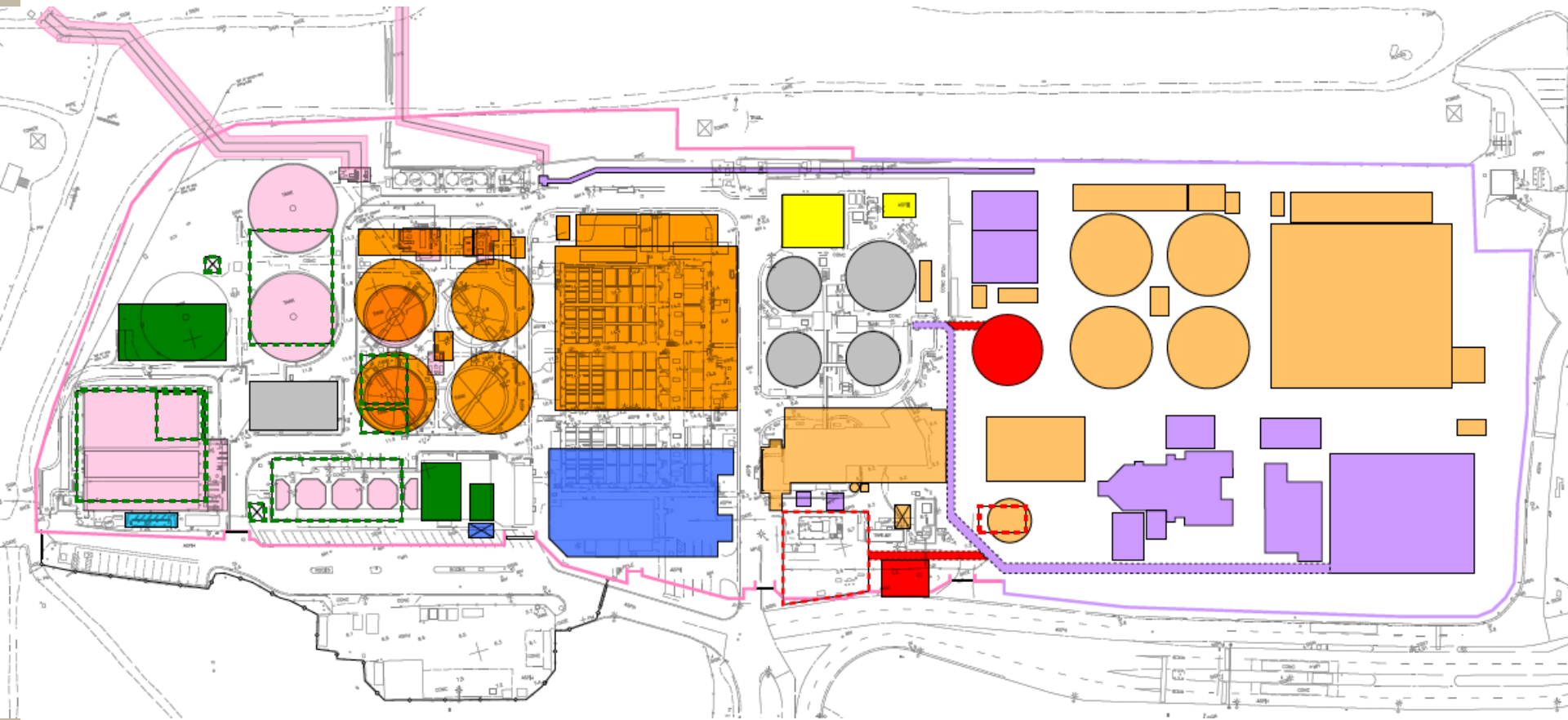

# Project Status

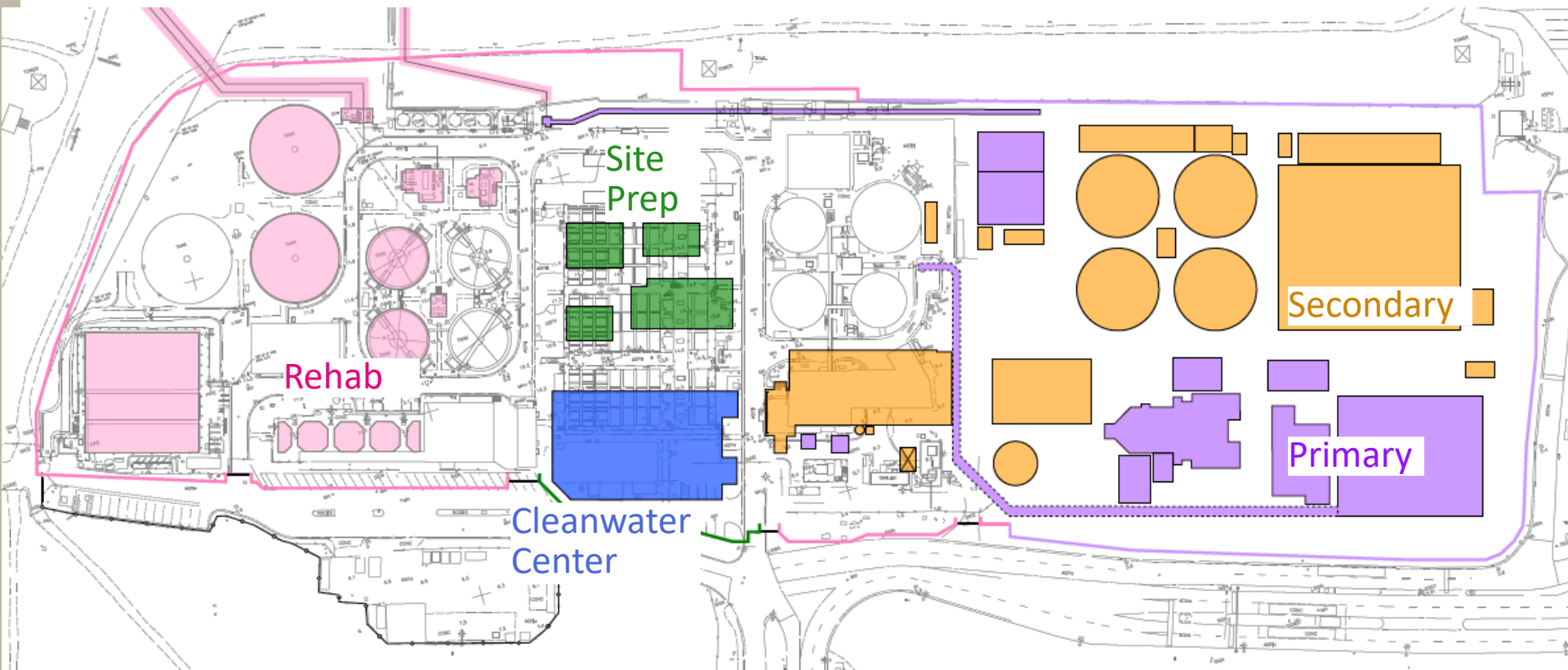



# Headworks/Primary Treatment (824771)





# Secondary Treatment/Dewatering (833210)

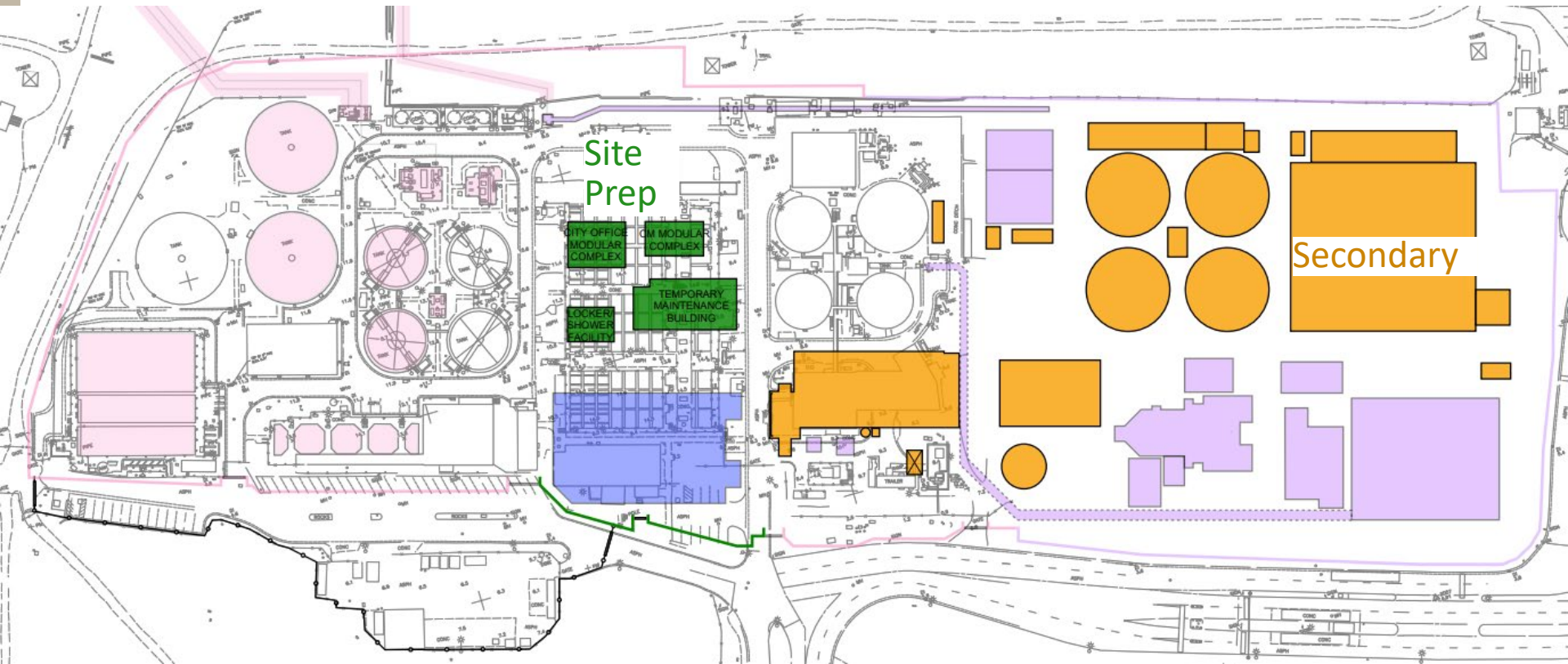

# Existing Plant Rehabilitation (833150)

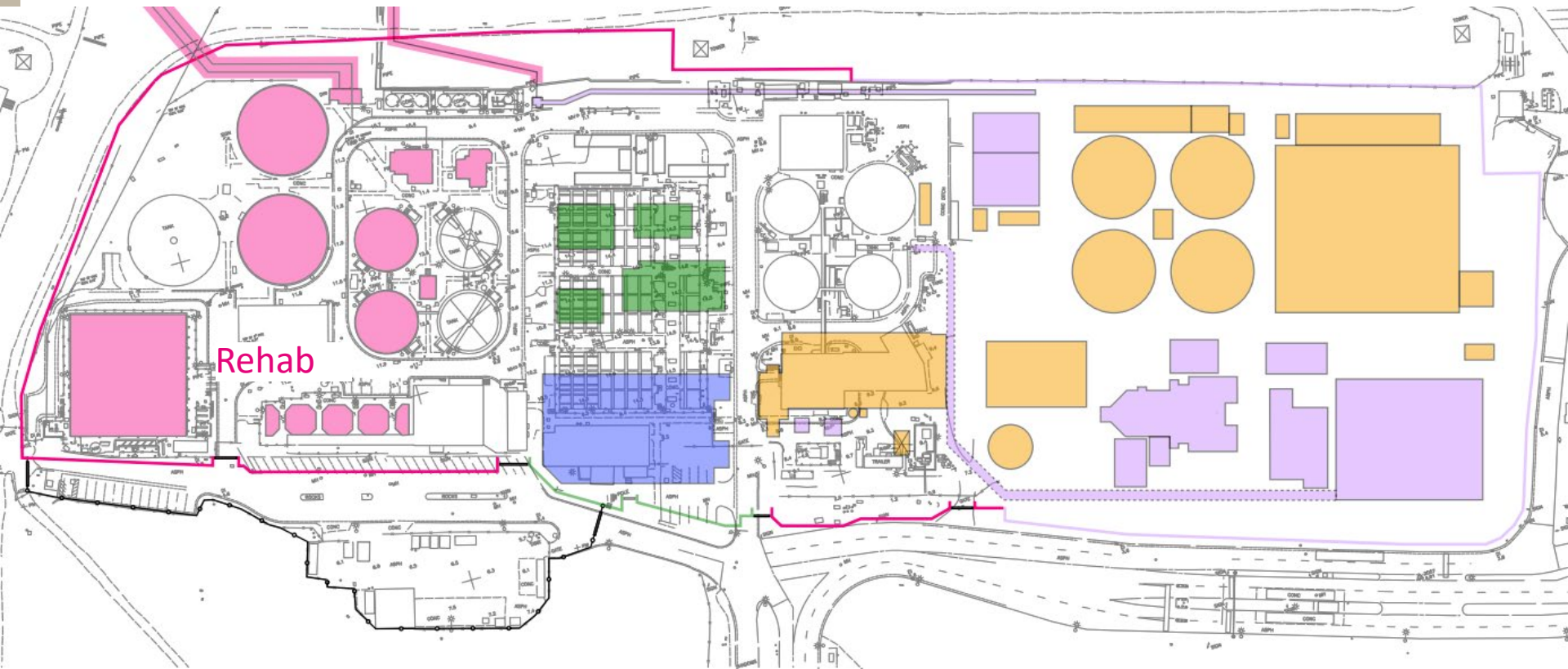

# Admin/Lab Building (Old Location)





# Cleanwater Center (New Location)





# Cleanwater Center—Aerial View

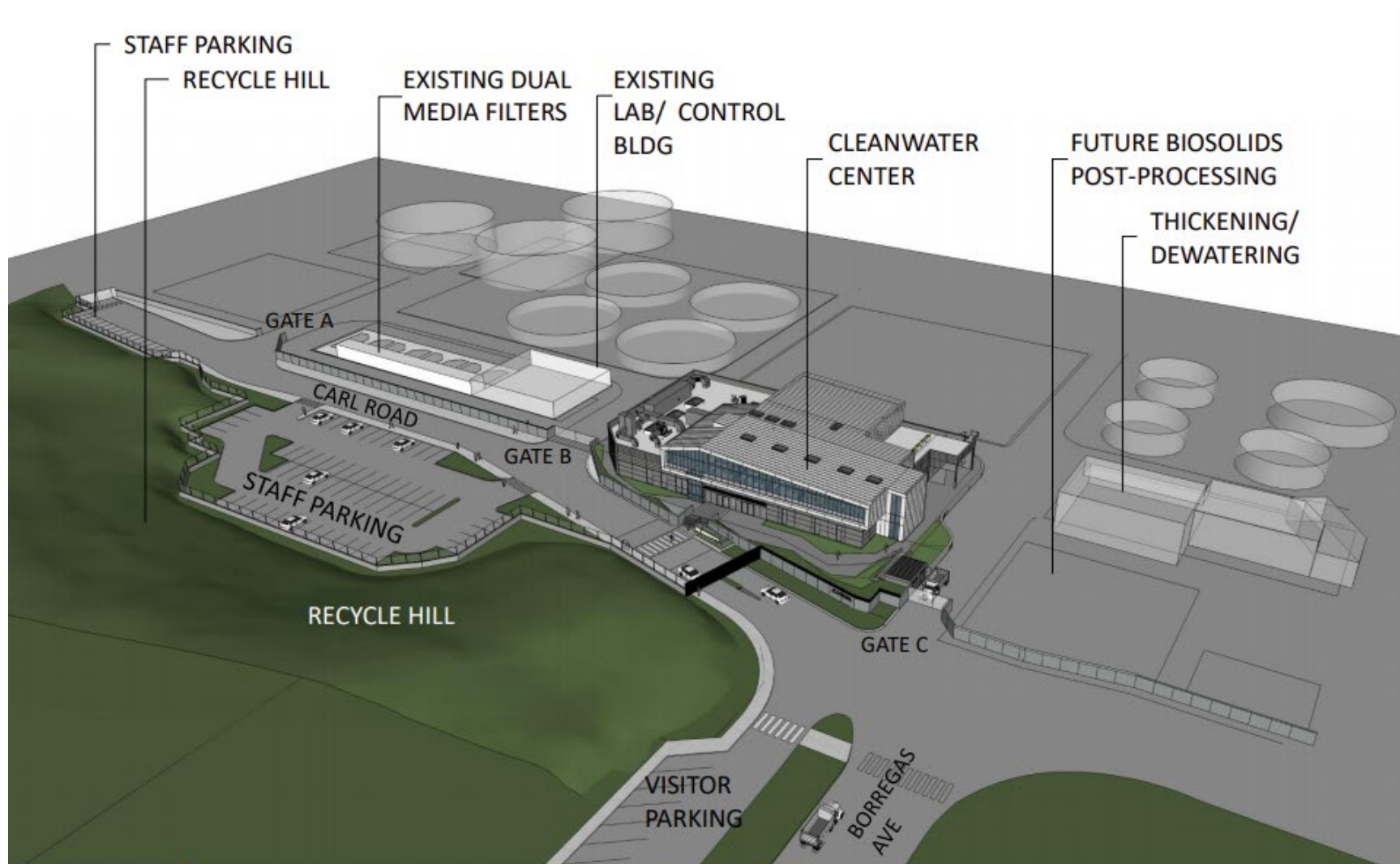

# Cleanwater Center—Design Elements

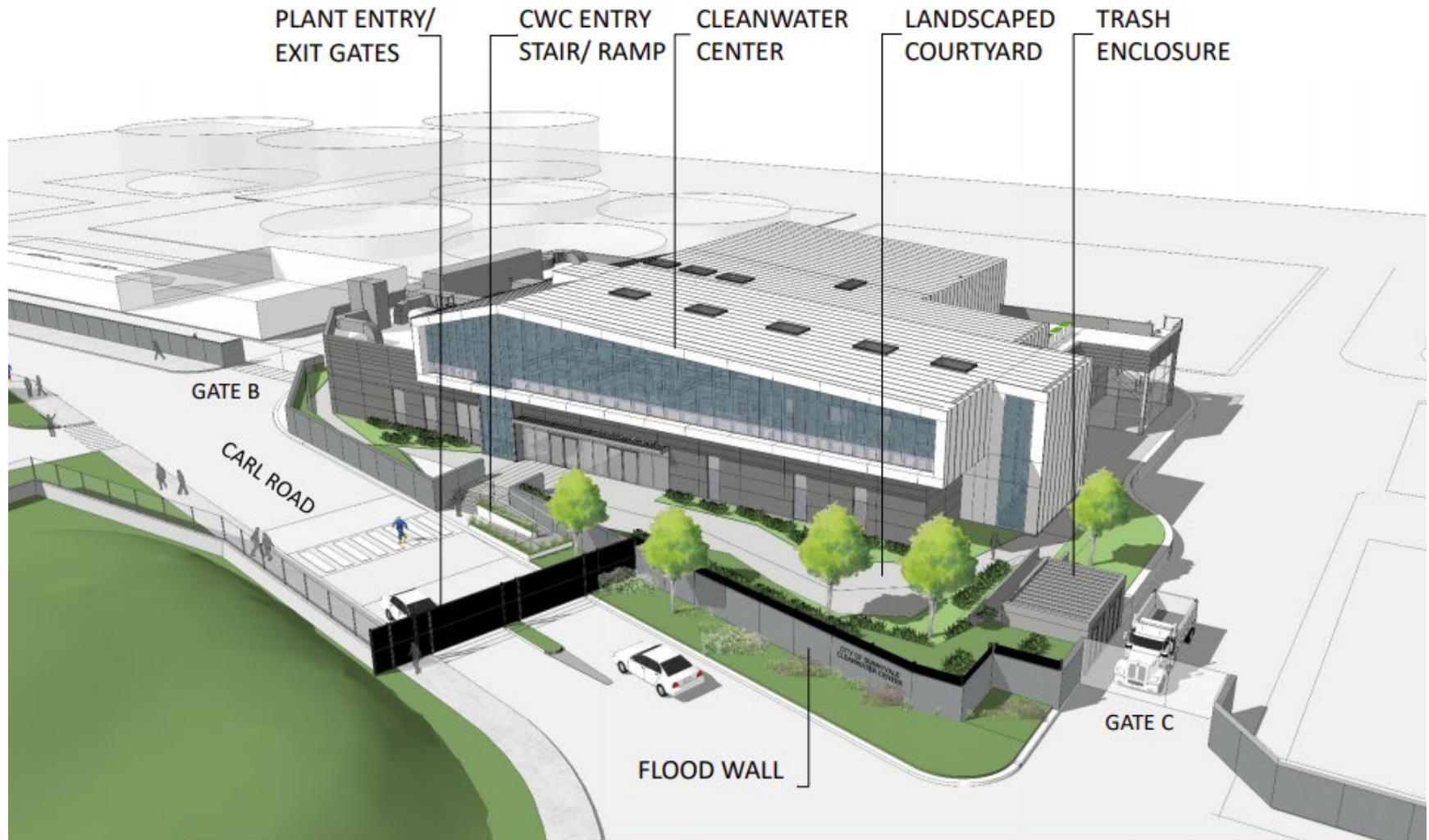



# Cleanwater Center--Architectural Concept 1



# Cleanwater Center--Architectural Concept 2 (Preferred)







Sunnyvale

# Cost Control

Sunnyvale Cleanwater Program

# Cost Control Focus

## Adopted Budgets

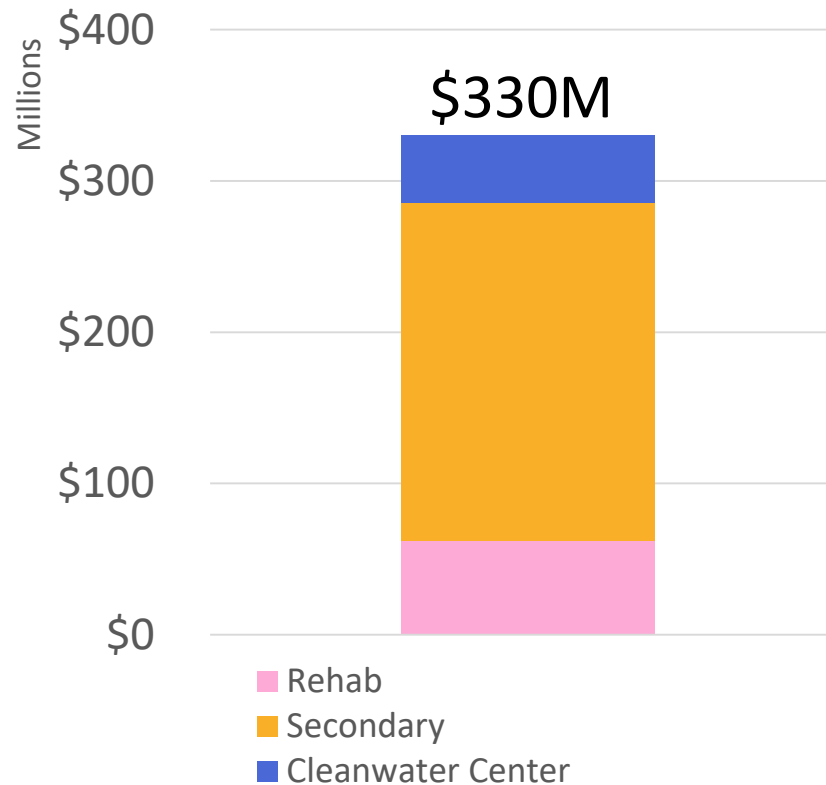



# Cost Control Focus

## Adopted Budgets

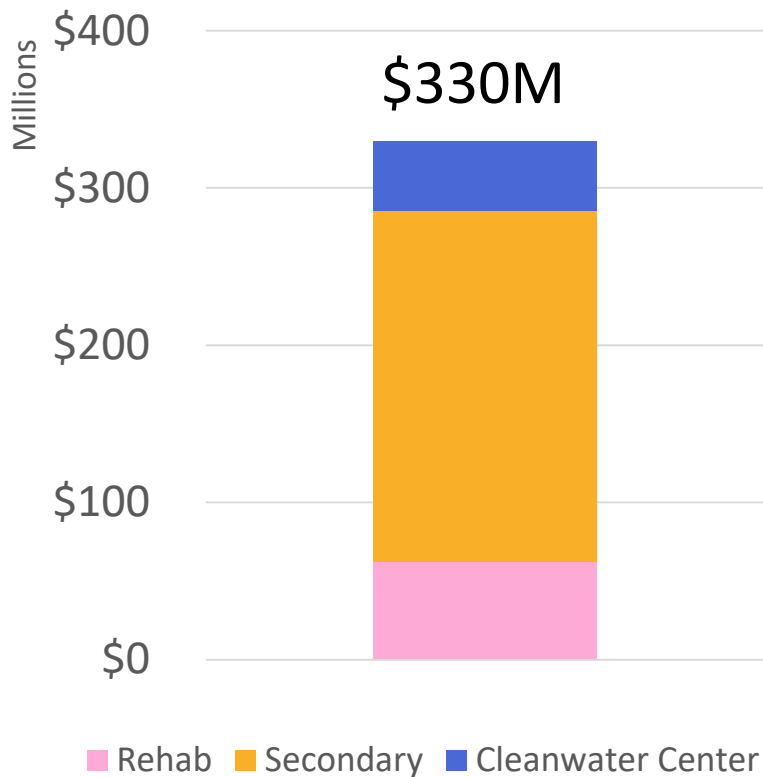

## 60% Estimates

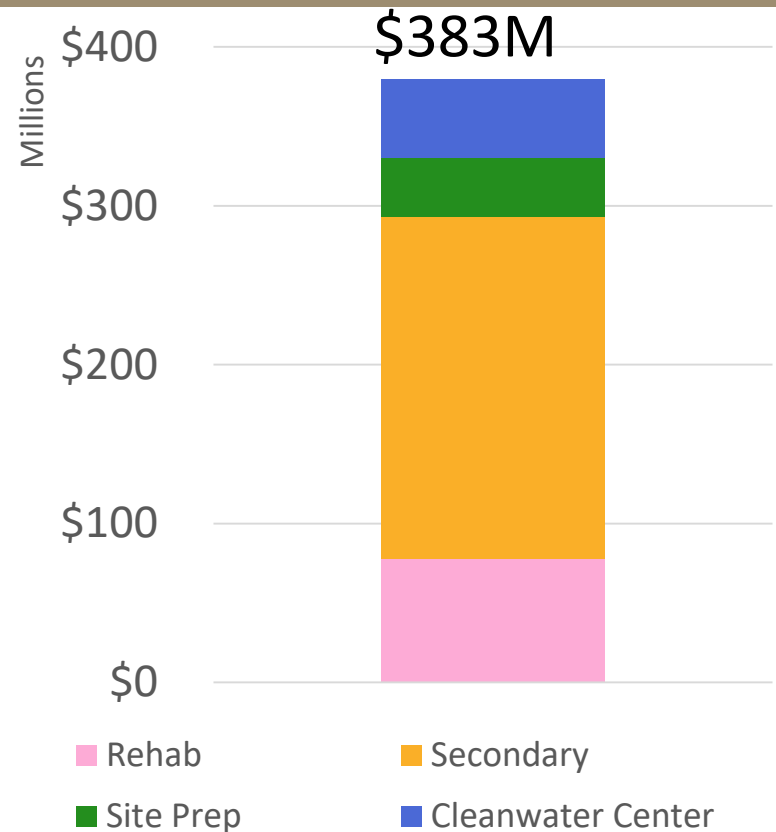

# Decision Point

## Option 1

- Stay on-budget

## Option 2

- Stay on-scope



# Path Forward

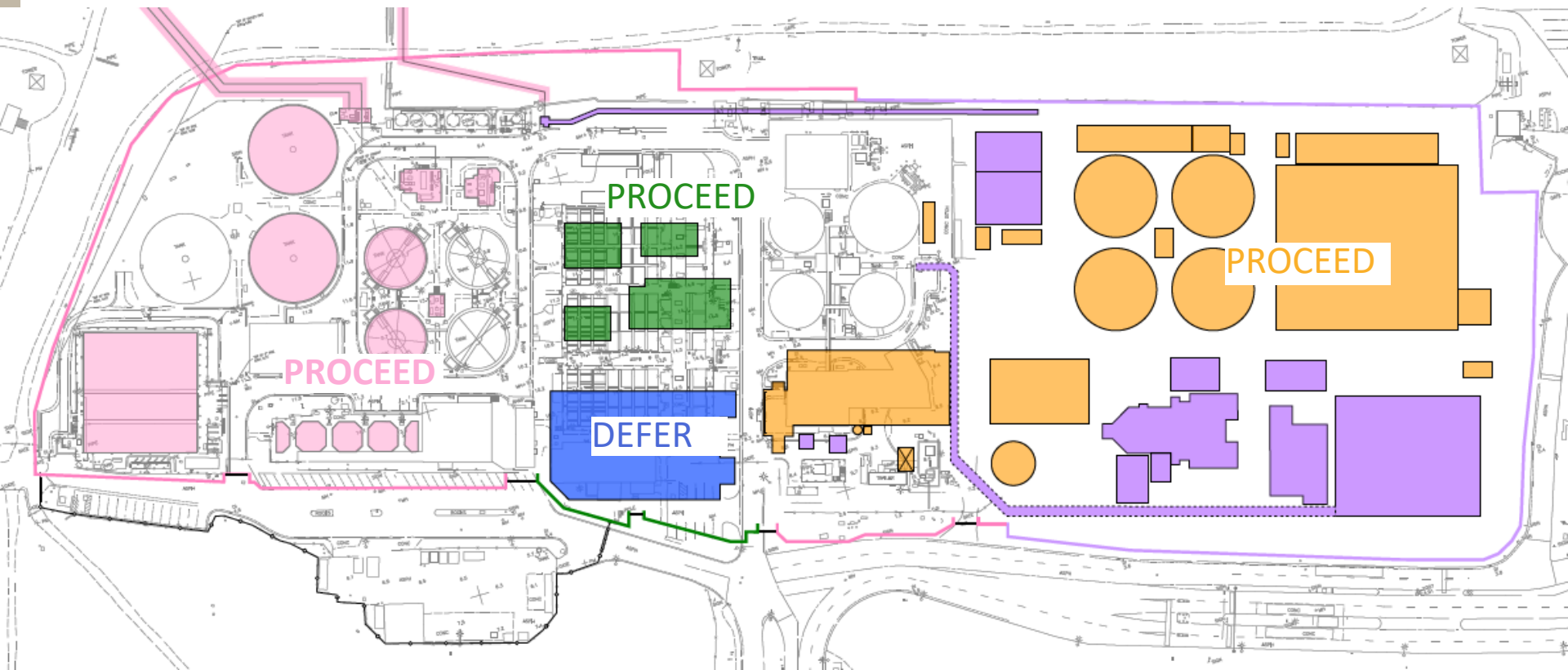



# Cleanwater Center Deferral Strategy

## Soft stop

- Complete 90% design
- Prepare & reserve site
- Construct Recycle Yard parking lot

## Prepare to restart

- Continue cost control on other projects
- Reclaim savings from low bids
- Seek additional grants, loans, and cost share opportunities

# Managing Uncertainty

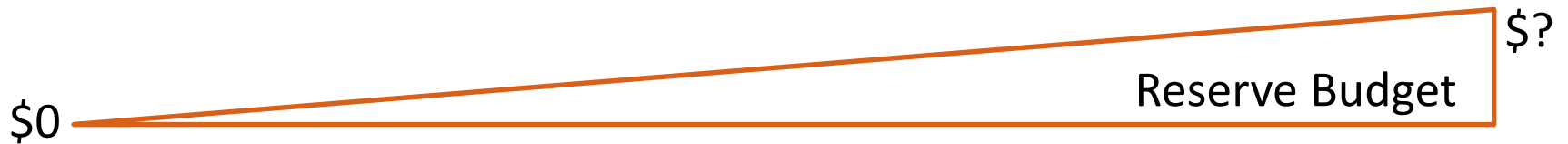
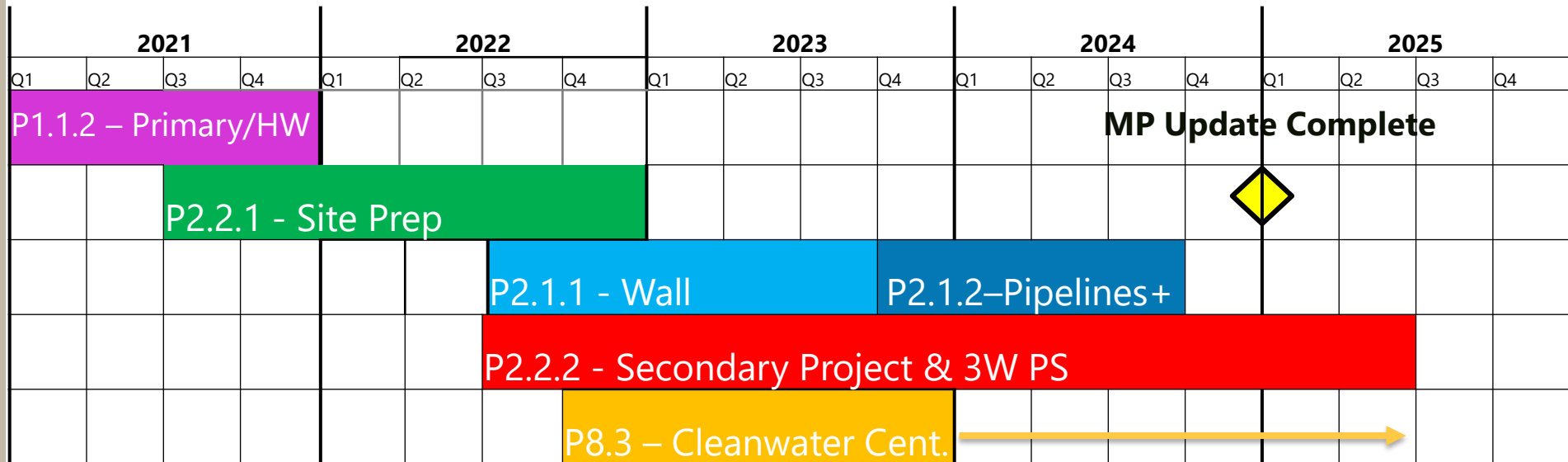

# Cleanwater Center Deferral Implications

## Advantages

- + Limits risk from bid price uncertainty
- + Reduces risk of treatment facility failure
  - ◆ Staff safety
  - ◆ Regulatory violations
  - ◆ Operational Reliability

## Disadvantages

- Cost of future construction escalates
- Temp & Subpar office/lab facilities hinder recruitment and retention
- Lose WIFIA low interest savings (\$220 M versus \$190 M)
- Low interest rate environment may not last



# Next Steps

---

- Now—Proceed to 90% design on Cleanwater Center
- Now—Proceed through construction on Rehab
- December 8<sup>th</sup>—SRF application
- February 23<sup>rd</sup>—Detailed Program update
- June 2021—FY21/22 proposed project budgets
- March 2022—Begin Master Plan Update



Sunnyvale

# Questions?





# Prioritizing Projects

## Pillars of the 2016 Master Plan



REGULATIONS



CONDITION



CAPACITY



PERFORMANCE



POLICY

# Building Relocation Assessment

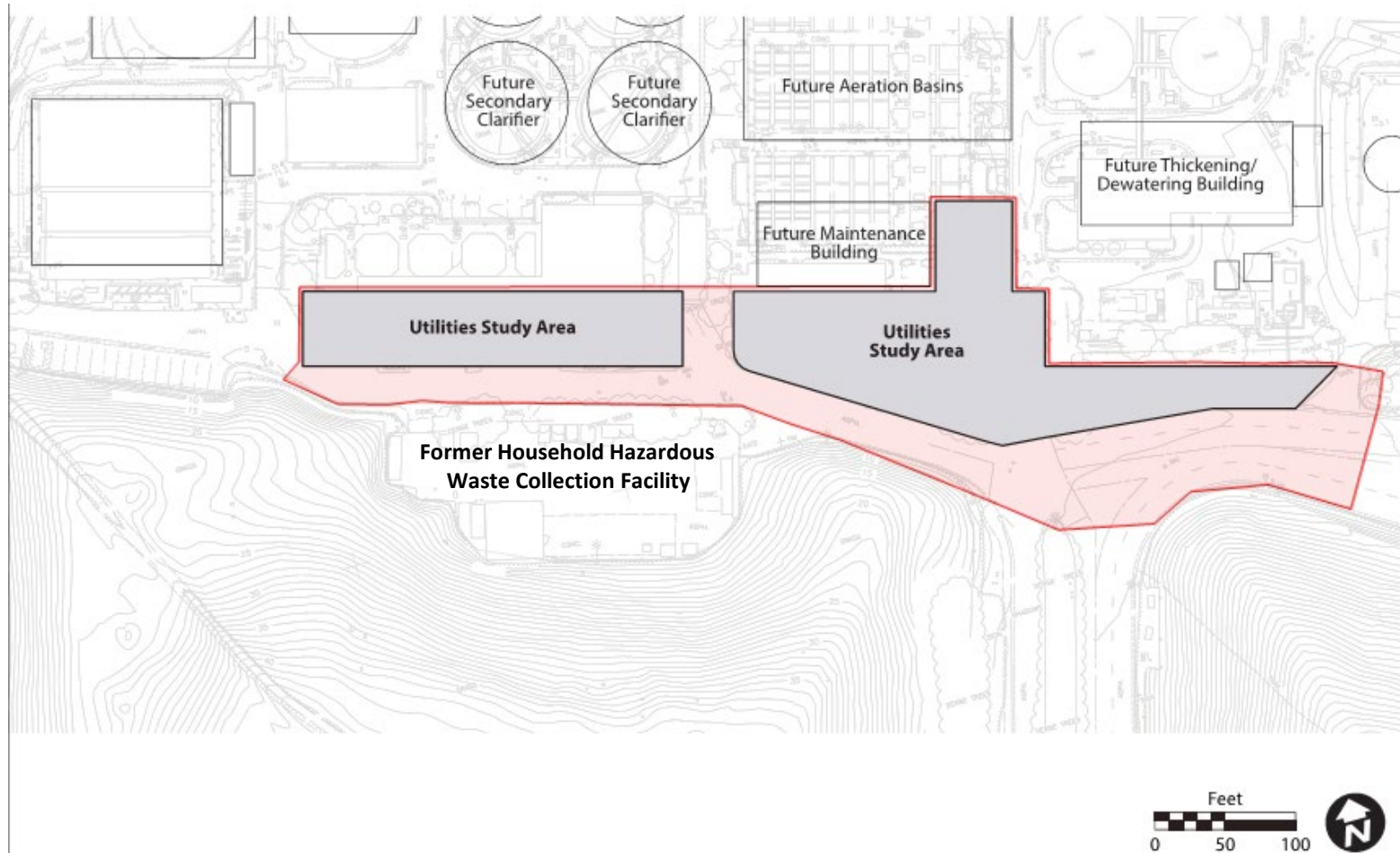

# Cleanwater Center – Design Development

---

- Conducted User Group Workshops (Administration & Operations, Laboratory, and Maintenance)
  - ◆ Obtained staff input – In-person workshops and written responses to questionnaires and requests-for-information.
  - ◆ Refined layout concepts and adjacencies and addressed specific staff needs.
- Prepared DIMs (Preliminary Design Memoranda)
- Prepared 30% Design Package



# Cleanwater Center Master Plan Concepts

---

- The Cleanwater Center design will be unique in form and materials but will also be cohesive with the new WPCP process buildings.
- Building appearance should reflect modern, minimalist architectural design and be compatible with office building types in the vicinity.
- Be a welcoming gateway for visitors coming to the Plant while providing it's primary function of "housing" the Plant staff
- Consistent with City design standards, municipal codes, and building codes
- Meet LEED Gold rating requirements.